



# Ford Fender Flares Front Pair

Part #20131-02

## Component List:



Left Front  
Flare



Right Front  
Flare



Left Front  
Inner Piece



Right Front  
Inner Piece

## Included in Hardware Kit:



1. SW1-0067,  
5/16 x 18 x 3/8"  
SS Torx Screw,  
(Pocket Style Only)  
16 pcs



2. WA1-0012,  
.320 x .700 x .03  
SS Washer,  
(Pocket Style Only)  
16 pcs



3. NU1-0019,  
5/16-18 Jam Fin.  
Nylock Nut,  
(Pocket Style Only)  
16 pcs



4. SW1-0052,  
T-45 Torx Bit,  
(Pocket Style Only)  
1 pc



5. SW1-0058,  
#10 x 5/8" Phillips  
SS Truss Screw,  
8 pcs



6. CL1-0009,  
Long "U" Clip,  
Magni 565  
2 pcs



7. MT1-0034,  
1" x 1.5" x .06"  
Blk 3M Foam Tab,  
2 pcs



8. ET1-0002,  
Edge Trim Tool,  
1 pc



9. GP1-0025  
Edge Trim

***If your flares already have the edge trim and pocket hardware installed, skip to Front Flare Installation Step 4.***

## **STEP 2 - EDGE TRIM INSTALLATION**

A. Peel two to three inches of red vinyl backing away from Edge Trim (GP1-0025) tape. Applying the adhesive side of the edge trim to the inner side of the flare, affix the edge trim to the top edge of the flare (the portion that comes in contact with the vehicle).

B. Press edge trim into place along the top edge of the flare in one-foot increments, pulling red vinyl backing free as you continue to work your way around the top edge of the flare.



## **Pocket Hardware Installation (Pocket Style Only):**



Put a Washer (WA1-0029) on each Bolt (SW1-0087).



Put each Bolt/Washer combination through a pocket hole in the flare, Bolt head and Washer on the outside.



3

Place a Nut (NU1-0019) over the end of each Bolt and tighten, using a 1/2" wrench for the Nut and the supplied Torx Bit (SW1-0052) for the Bolt. Repeat for remaining pockets.

## Front Flare Installation Procedures (Passenger's Side):



4

Remove seven factory screws with a socket wrench. Note (1) location where screw is not to be removed. Save screws for reinstallation.



5

Hold flare to vehicle and mark one flare hole location with a grease pencil.



6

Foam 3M Tab

Wrap a Foam Tab (MT1-0034) around the wheel well sheet metal, centered over the mark made in Step 5.



7

Install a Clip (CL1-0009) over the Tab (MT1-0034) placed in Step 6.



8

Verify presence of U-clip on inner brackets.



9

Line up the holes in the inner piece with the three uppermost factory holes. *NOTE: Both inner brackets are universal.*

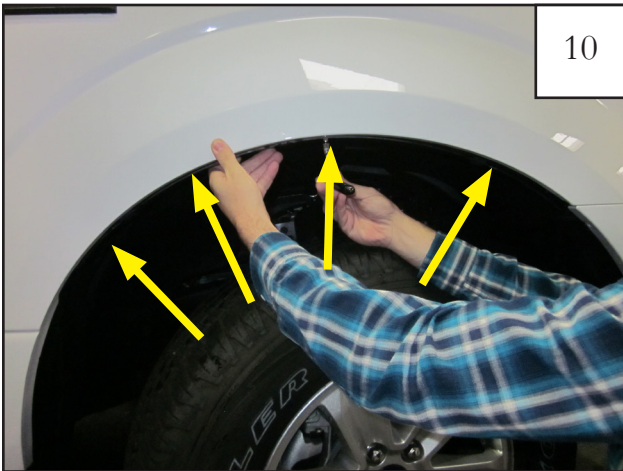

10

Using a socket wrench, reinstall the factory screws through the inner piece.



11

Hold flare to fender, re-install three factory screws removed in Step 4 using sockets and wrench.



12

Position flare on fender, pressing inward on the flare, line up the flare mounting holes with the mounting clips on the inner piece. Install four Phillips Truss Screws (SW1-0058) through the flare and into the clips on the inner piece. Install and tighten.



13

Completed front flare installation.

## Edge Trim Tool Procedures:



Using supplied Edge Trim Tool (ET1-0002), seat edge trim against vehicle by hooking curved end under edge trim at one end of flare. Next, slide around outer edge of flare to the other end.



Using flat end of supplied Edge Trim Tool (ET1-0002), seat edge trim against flare by inserting straight end between edge trim and flare at one end. Next, slide around entire edge to the other end.