



AUTOMOTIVE PRODUCTS,

# INSTALLATION INSTRUCTIONS

## PRO TRAX<sup>®</sup> 5 WHEEL-TO- WHEEL

### APPLICATION:

2009-2017 Dodge Ram 1500 Crew Cab 5.5' Bed  
2009-2017 Dodge Ram 1500 Quad Cab 6.5' Bed

### PART NUMBER:

21-534310, 21-534315

ITEM	QUANTITY	DESCRIPTION	TOOLS NEEDED
1,2	2	STEP BAR, DRIVER (1) AND PASSENGER (2)	13MM SOCKET
3	1	MOUNT BRACKET A	17MM SOCKET
4	2	MOUNT BRACKET B	ALLEN KEY (INCLUDED)
5	1	MOUNT BRACKET C	
6	1	MOUNT BRACKET D	3/8" WRENCH
7	1	FRONT DRIVER MOUNT BRACKET	DRILL
8	5	M10 BOLT / M8 NUT PLATES (YELLOW ZINC)	1/4" DRILL BIT
9	8	M8 RIV-CERTS (YELLOW ZINC)	RATCHET
10	12	M8 HEX HEAD BOLTS (YELLOW ZINC)	TORQUE WRENCH
11	12	M8 FLAT WASHERS (YELLOW ZINC)	
12	12	M8 SPLIT LOCK WASHERS (YELLOW ZINC)	
13	5	M10 HEX NUTS (YELLOW ZINC)	
14	5	M10 LOCK WASHERS (YELLOW ZINC)	
15	5	M10 FLAT WASHERS (YELLOW ZINC)	
16	16	M10 BUTTON HEAD BOLTS (BLACK STAINLESS STEEL)	
17	12	M10 FLAT WASHERS (BLACK STAINLESS STEEL)	
18	12	M10 INTERNAL TOOTH LOCK WASHERS (BLACK STAINLESS STEEL)	
19	5	M10 PLASTIC RETAINERS	
20	6	M6 BUTTON HEAD BOLTS (BLACK STAINLESS STEEL)	
21	6	M6 FLAT WASHERS (BLACK STAINLESS STEEL)	
22	6	M6 SERRATED FLANGE NUTS (BLACK STAINLESS STEEL)	
23	6	PLASTIC BRACKET COVERS	
24	12	M6 HEX HEAD CAP SCREWS (YELLOW ZINC)	
25	24	M6 FLAT WASHERS (YELLOW ZINC)	
26	12	M6 NYLON LOCK NUTS (YELLOW ZINC)	

**ANTI-SEIZE LUBRICANT MUST BE USED ON ALL STAINLESS STEEL FASTENERS TO PREVENT THREAD DAMAGE AND GALLING**

### PROCEDURE

1. Remove contents from box, verify if all parts listed are present and free from damage.  
Carefully read and understand all instructions before attempting installation.  
**Failure to identify damage before installation could lead to a rejection of any claim.**



Westin Automotive Products, Inc.  
320 W. Covina Blvd  
San Dimas, Ca. 91773

Thank you for choosing Westin products  
for additional installation assistance please call  
Customer Service (800) 793-7846

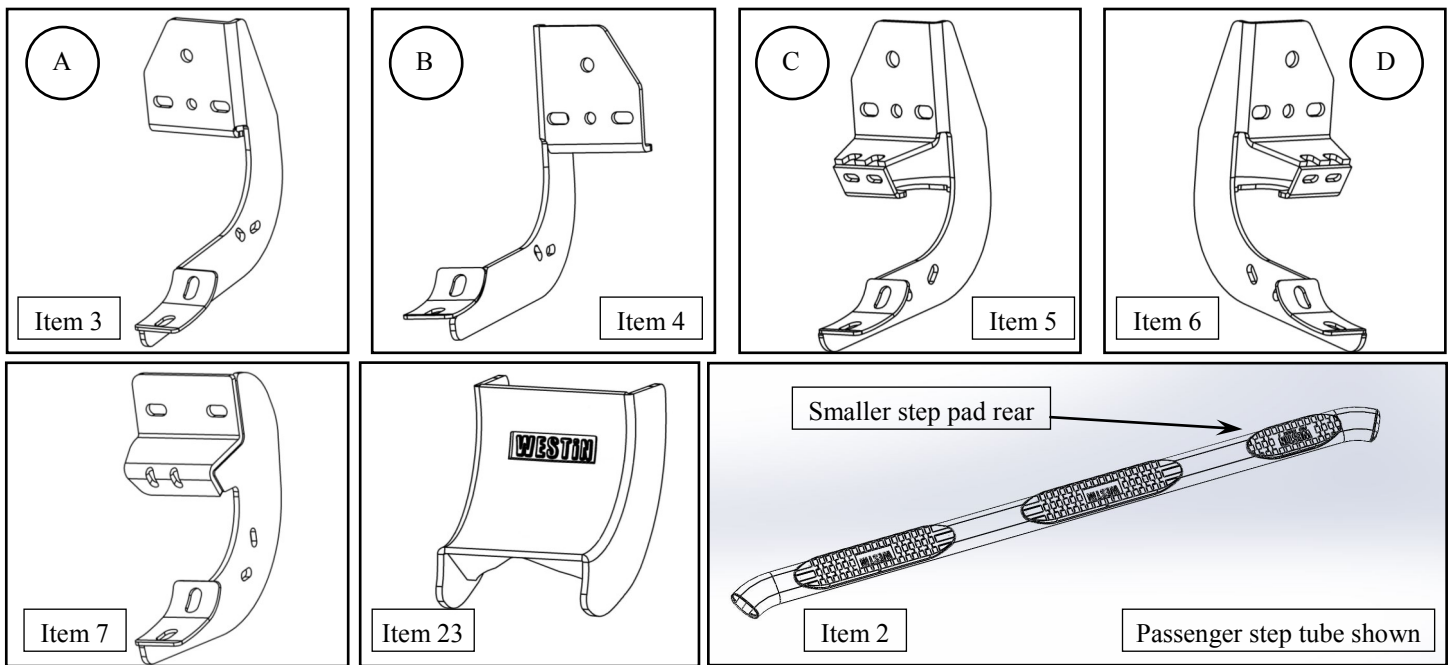

2. Check either side of the vehicles rocker panel, locate the factory holes in the rocker panel by removing the tape. Check and verify what type of rocker panel you have. See **Figures 1, 2, 3 & 4**. **Note:** If any of the locations on the factory holes in the rocker panel have factory M10 riv-certs or threaded M10 holes, do not use provided M8 riv-certs (Item 9) in that location. Refer to **Figures 1, 2 & 4**.

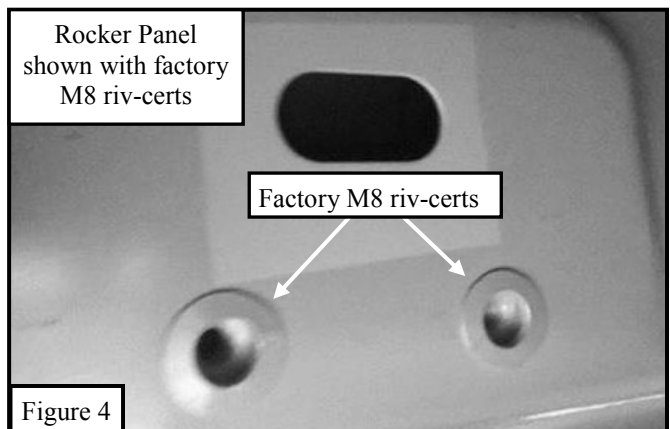
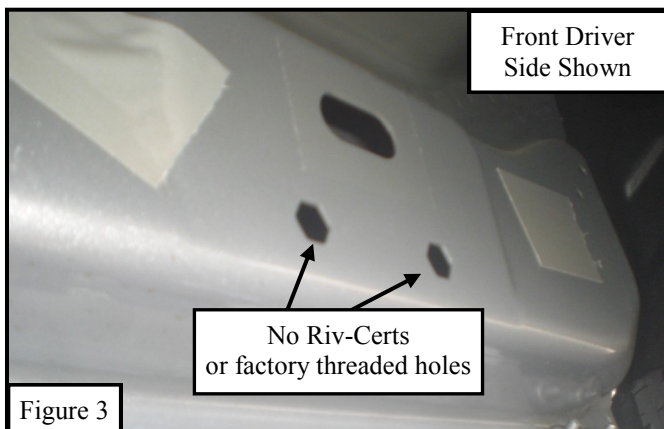
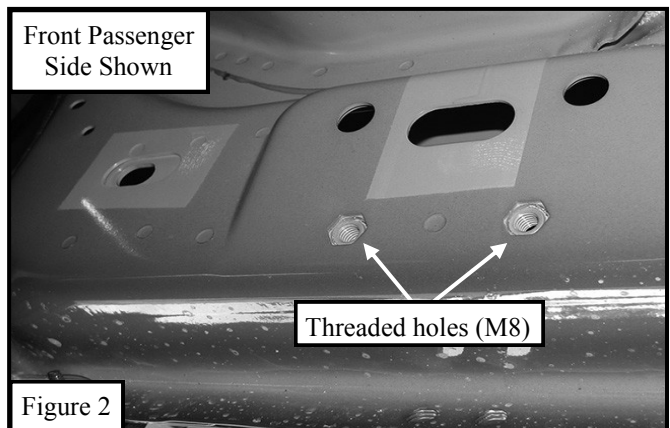
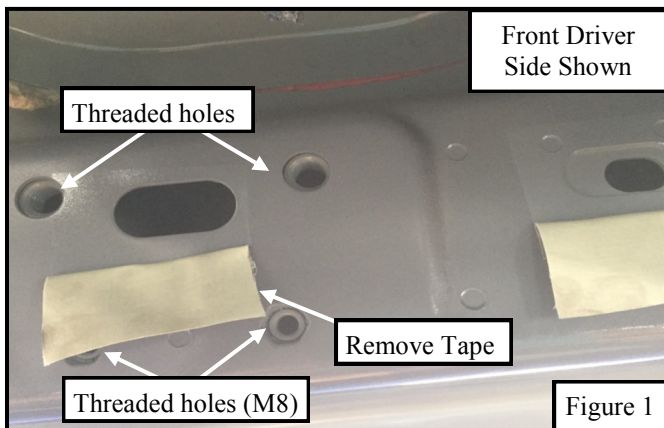

3. **Starting from the driver side:** If the hexagonal holes in the front mounting location of the vehicle are not threaded use (2) M8 riv-certs and insert it into the hex holes vehicle. **Note:** See **Figures 5 & 6** for example on how to tighten M8 riv-certs, it will require to use an M10 bolt with M8 nut plate (Item 8) along with mounting bracket (Item 3/4) to perform this task. This procedure will permanently install M8 riv-cert. Remove (Item 8) after the riv-certs are tightened.

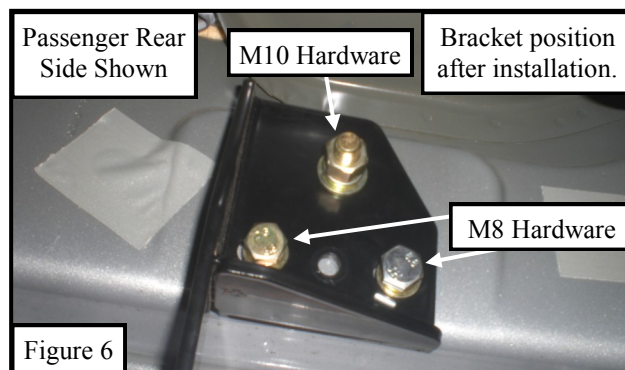
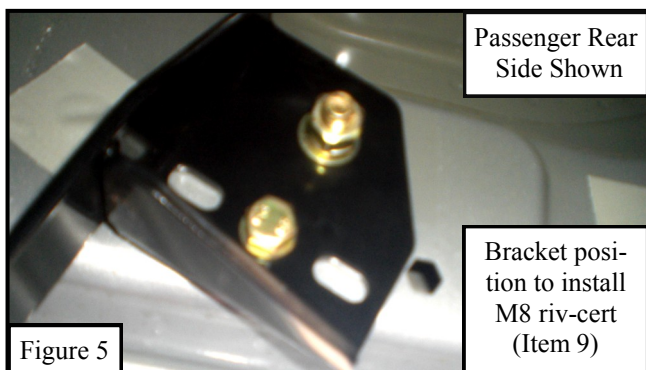

4. Starting on the driver side, locate (1) Front Driver Mount Bracket (Item 7) and loosely install using (2) M8 hex head bolt (Item 10), (2) M8 flat washers (Item 11), (2) M8 lock washers (Item 12), (2) M6 button head bolts (Item 20), (2) M6 flat washer (Item 21), and (2) M6 serrated flange nut (Item 22). **Note:** Drilling of two 1/4" holes might be necessary on pinch weld if factory holes are not present. Before drilling place masking tape on drill surface to prevent paint chipping. See **Figures 7 and 8**. Refer to **Bracket Orientation** for correct bracket placement.

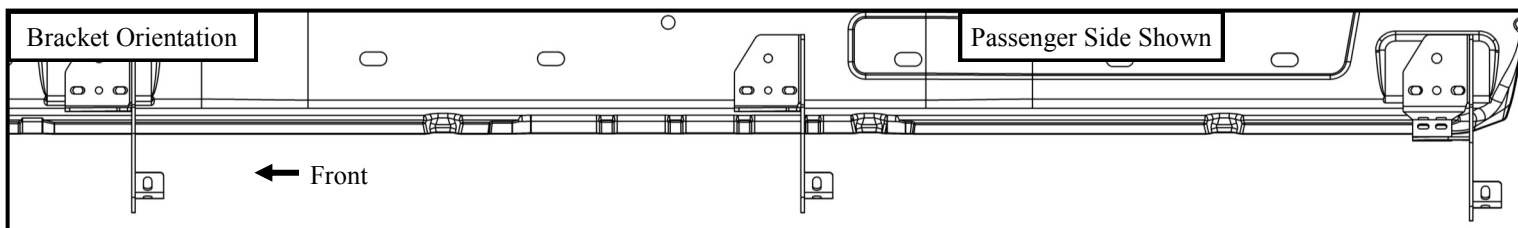
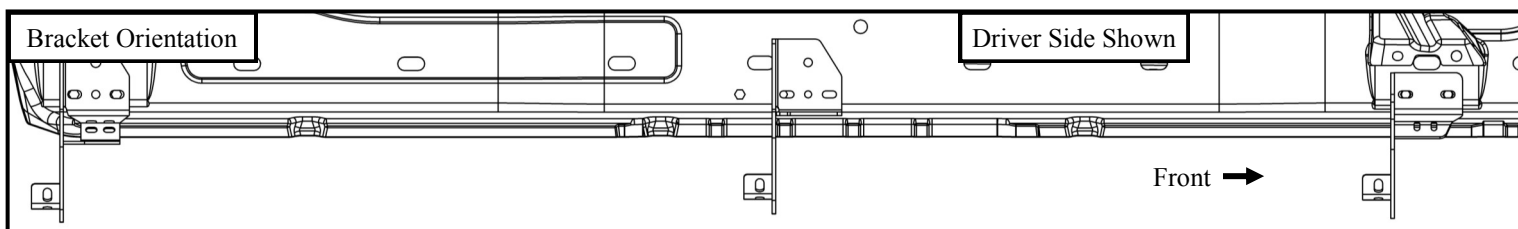
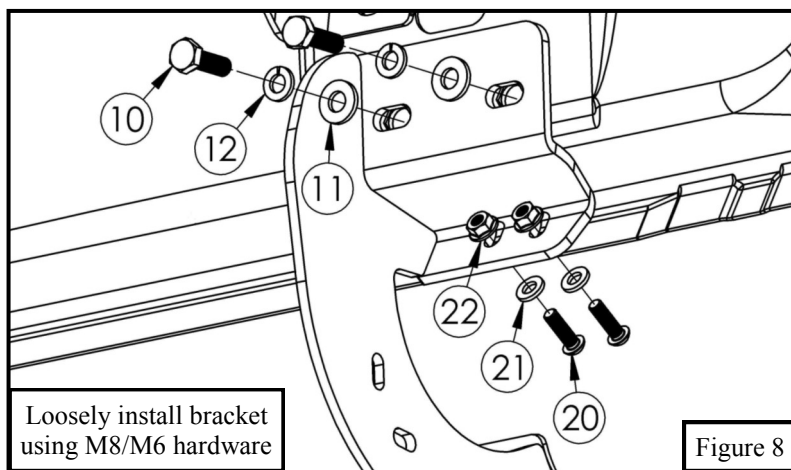
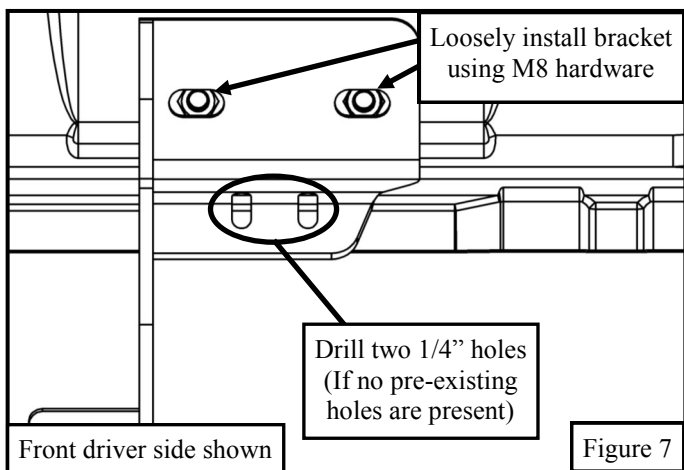

Westin Automotive Products, Inc.  
320 W. Covina Blvd  
San Dimas, Ca. 91773

5. Locate (1) Mount Bracket A (Item 3) and install at the driver side center location. Install (1) M8 Hex Riv Cert (Item 9), refer to **Step 3**, if mounting location does not have threaded holes. Refer to **Figure 3**. Install (1) M10 Bolt / M8 Nut Plate (Item 8) and secure using one M10 plastic retainer (Item 19). See **Figure 11**. Leave bolt plate to the side if mounting location has threaded holes or factory M8 riv certs. See **Figure 9**. Loosely install mounting bracket to the rocker panel using (2) M8 hex head bolt (Item 10), (2) M8 flat washer (Item 11), (2) M8 lock washer (Item 12), (1) M10 flat washer (Item 15), (1) M10 hex nut (Item 13), and (1) M10 lock washer (Item 14). See **Figure 10**.
6. Repeat **Step 5** for the front and center passenger side mounting locations using Mount Bracket B (Item 4).

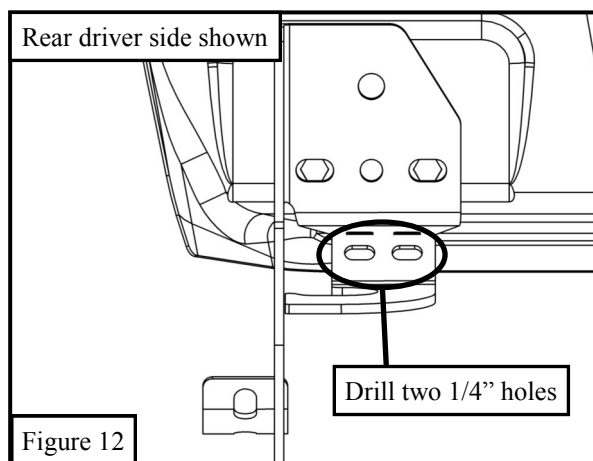
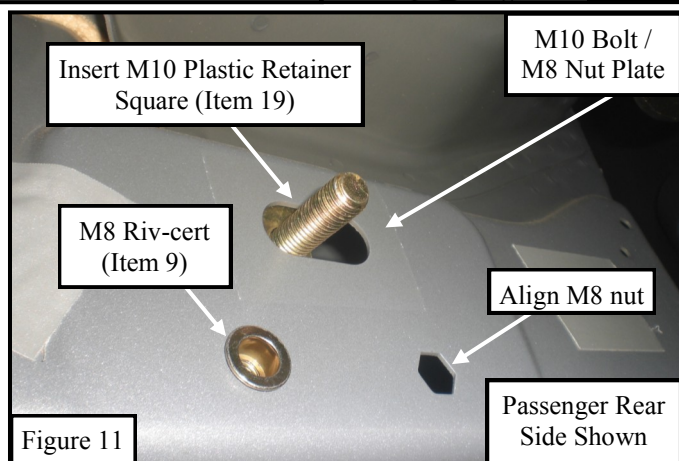
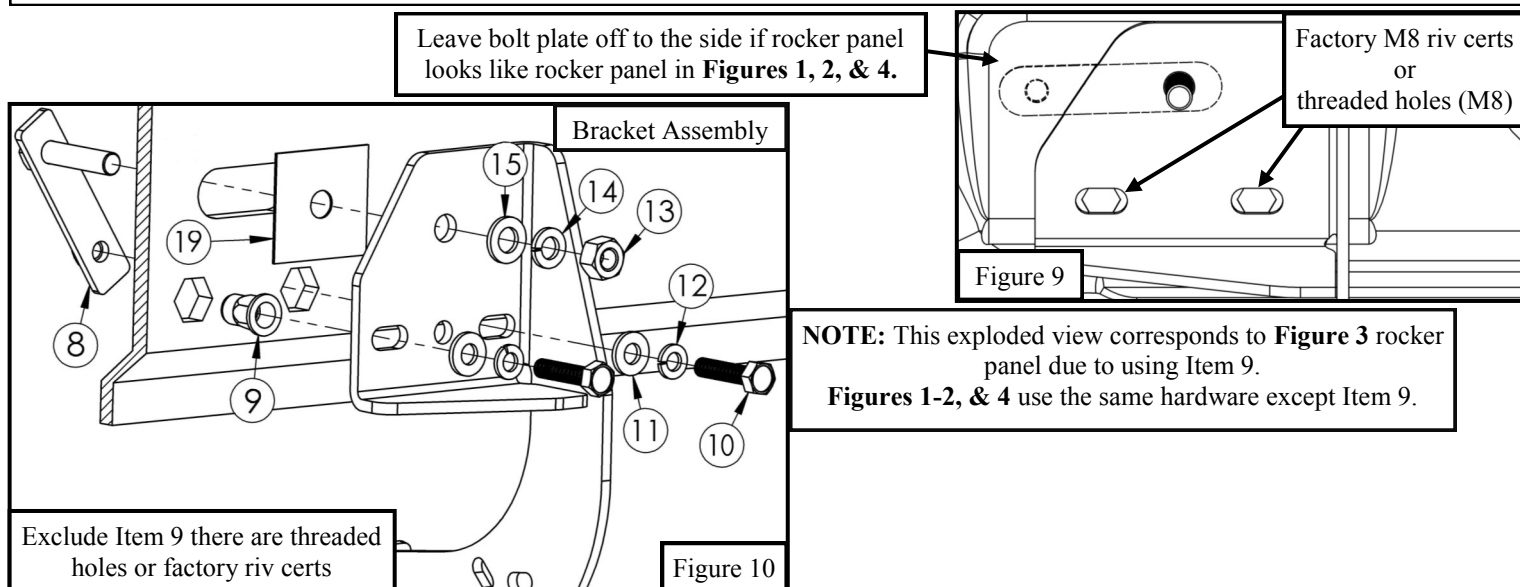

7. Locate (1) Mount Bracket C (Item 5) and install at the driver side rear mounting location. Install (1) M8 Riv Cert, refer to **Step 3**, if mounting location does not have threaded holes. Refer to **Figure 3**. Install (1) M10 Stud / M8 Nut Plate and secure using one M10 plastic retainer (Item 19). See **Figure 11**. Leave bolt plate to the side if mounting location has threaded holes or factory M8 riv certs. See **Figure 9**. Drill two 1/4" holes in the pinch weld, before drilling place masking tape on drill surface to prevent paint chipping. Loosely install mounting bracket to the rocker panel using (2) M8 hex head bolts (Item 10), (2) M8 flat washers (Item 11), (2) M8 lock washers (Item 12), (1) M10 flat washer (Item 15), (1) M10 hex nut (Item 13), (1) M10 lock washer (Item 14), (2) M6 button head bolts (Item 20), (2) M6 flat washer (Item 21), and (2) M6 serrated flange nut (Item 22). See **Figure 13**.
8. Repeat **Step 7** for rear passenger side using Mounting Bracket D (Item 6).
9. Locate (1) Plastic Bracket Cover (Item 23) and loosely secure it to the brackets using the provided hardware: (2) M6 hex head cap screws, (4) M6 flat washers, and (2) M6 nylon lock nuts. Repeat for every bracket. See **Figure 14**.



Westin Automotive Products, Inc.  
320 W. Covina Blvd  
San Dimas, Ca. 91773

Thank you for choosing Westin products  
for additional installation assistance please call  
Customer Service (800) 793-7846  
www.westinautomotive.com

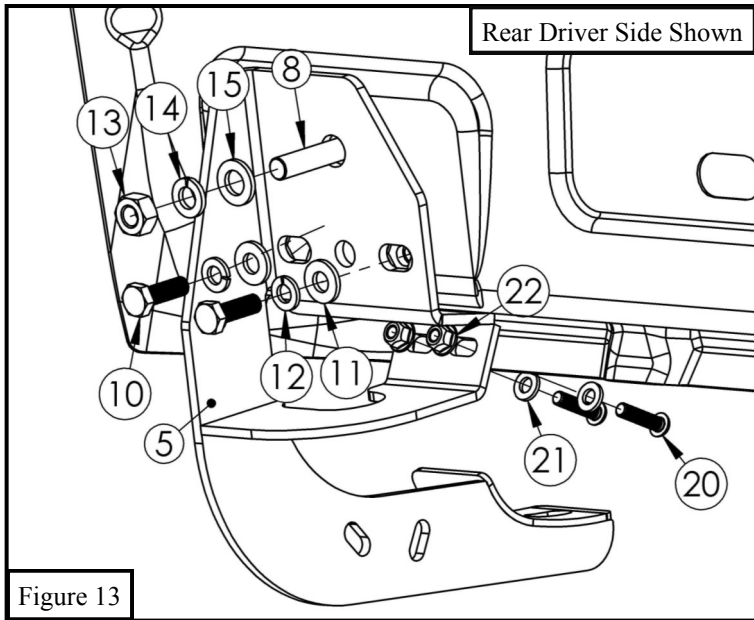

Figure 13

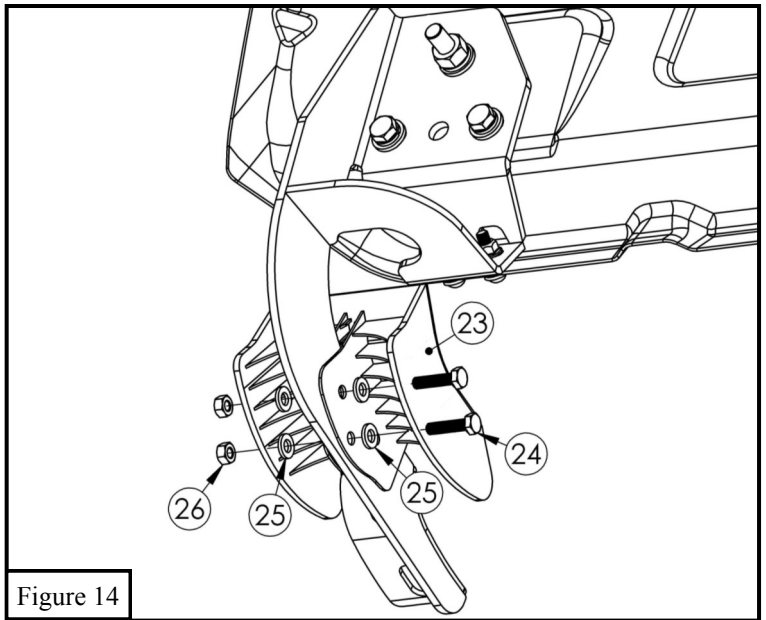

Figure 14

10. Loosely install the Step Bar (Item 1) to the previously installed mounting brackets with the supplied M10 hardware (Items 16-18). See **Figure 15**.
11. Repeat **Step 10** for passenger side step bar.
12. Align and adjust the step bars and brackets. Then tighten all M10 hardware to 30 ft-lbs, M8 to 20 ft-lbs, and M6 to 12 ft-lbs.

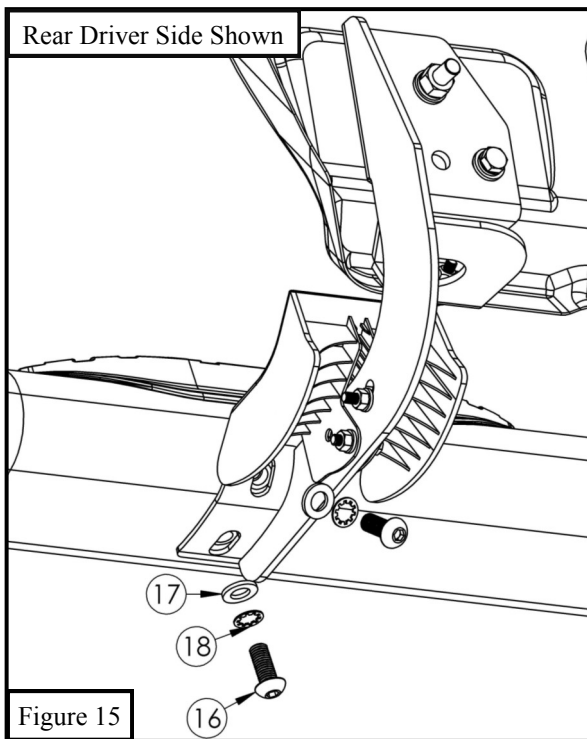

Figure 15



#### CARE INSTRUCTIONS

- REGULAR WAXING IS RECOMMENDED. DO NOT USE ANY TYPE OF POLISH OR WAX THAT MAY CONTAIN ABRASIVES.
- STAINLESS STEEL PRODUCTS CAN BE CLEANED WITH MILD SOAP AND WATER. STAINLESS STEEL POLISH SHOULD BE USED TO POLISH SMALL SCRATCHES.
- GLOSS BLACK FINISHES SHOULD BE CLEANED WITH MILD SOAP AND WATER.



Westin Automotive Products, Inc.  
320 W. Covina Blvd  
San Dimas, Ca. 91773

Thank you for choosing Westin products  
for additional installation assistance please call  
Customer Service (800) 793-7846  
www.westinautomotive.com

# Westin

SIGNATURE OF QUALITY

AUTOMOTIVE PRODUCTS, INC.



## WARNING



Failure to follow these instructions could lead to death, personal injury, and / or property damage.

### FASTENERS:

All Westin supplied fasteners must be utilized and installed in accordance with the installation instructions and apply torque to the specifications as defined. **DOUBLE CHECK ALL FASTENERS BEFORE INITIAL USE, AND PERIODICALLY IN THE FUTURE TO ENSURE PROPER FUNCTION AND SAFETY.**

### DRILLING:

Most Westin products do not require drilling for installation. If drilling is defined as required, use caution when drilling a vehicle. **FAILURE TO REVIEW AN AREA TO BE DRILLED MAY RESULT IN PERSONAL INJURY AND/OR INJURY TO OTHERS AS WELL AS VEHICLE DAMAGE.**

### EYE PROTECTION:

**ALWAYS WEAR SAFETY GLASSES OR GOGGLES DURING THE INSTALLATION PROCESS TO AVOID PERSONAL INJURY.**

### MAXIMUM TOWING/CARRYING CAPACITY:

The Westin Receiver Hitches will have a visible tow rating label affixed directly on the product. User should never exceed the vehicle manufacturers maximum tow and weight rating regardless of the capacity of the hitch. **FAILURE TO FOLLOW THESE GUIDELINES WILL VOID THE WESTIN WARRANTY AND MAY RESULT IN PERSONAL INJURY AND/OR INJURY TO OTHERS AS WELL AS VEHICLE DAMAGE.**

**Westin**  
SIGNATURE OF QUALITY

Westin Automotive Products, Inc.  
320 W. Covina Blvd  
San Dimas, Ca. 91773