

INSTRUCTION SHEET**CARTER WO TYPE CARBURETORS**

Numbers used in Disassembly and Reassembly Procedures are the Reference Numbers on Illustration on the reverse side.

This Tune-Up Kit is intended for use on carburetors that need cleaning and require minor replacement of parts, but otherwise are in satisfactory mechanical condition. The Tune-Up Kit is not intended for use on carburetors that are worn to the extent that replacement of the parts contained in the kit will not enable the carburetor to deliver proper performance and economy. When it is suspected that internal parts are worn, it is recommended that the carburetor be serviced by installing the necessary additional parts.

I. DISASSEMBLY.

Remove carburetor from engine by taking off nuts (1) and lockwashers (2); then lift off old gasket (3). Remove pin springs (4), link (5), spring (6), screw (7), and air horn (8).

Remove link (9), spring retainer (10), and connector rod (11). Remove and disassemble bowl cover (14) by removing screws (12), washers (13), pin (15), float (16), gasket (17), needle and seat assembly (18), metering rod (20), and disc (21). Lift plunger (22) and spring (23) out of pump cylinder.

Remove screws (24), insulator (25), and gasket (26). Complete disassembly of body by removing plug (27), strainer (28), ball check assembly (29), and disc check assembly (30). Remove idle adjusting screw (31) and spring (32).

II. CLEANING.

Cleaning must be done with carburetor disassembled. Soak carburetor parts a few hours to remove all foreign material. Use (1) a regular carburetor cleaning solution, (2) lacquer thinner or, (3) denatured alcohol; then brush parts with small brush and make certain carburetor bore is free of all hard carbon deposits. Do not boil carburetor in alkaline solution as it destroys the protective coating on casting. Blow out all passages with dry compressed air and examine carefully.

III. REASSEMBLY.

Install following parts in order listed: (32), (31), (30), (29), (28), (27), (26), (25), and (24). Put parts (23) and (22) in pump cylinder. Reassemble bowl cover by installing parts (19), (18), (17), (16), and (15). Gage float to exact specification to produce correct fuel

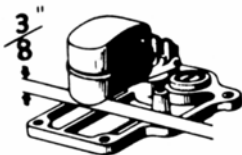

level in bowl. (See illustration.) Adjustment is made by bending float lip, which contacts bottom of needle.

Replace bowl cover (14), and parts (13) and (12). Back out throttle stop screw; then use gage (see drawing), and adjust metering rod by loosening nut, and adjusting metering pin until it just touches top surface of gage. Remove gage, tighten nut and install metering rod disc (21) and metering rod (20). Hook rod eye over metering rod pin.

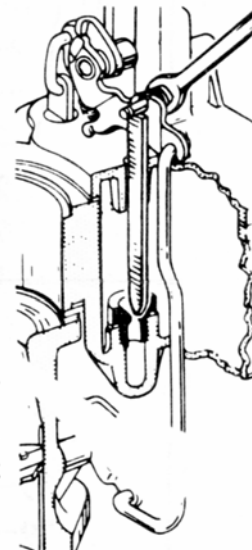

Be sure that metering rod is in the jet, and hook the metering rod spring around the metering rod. Failure to hook up this spring will cause the carburetor to run too rich.

Replace connector rod (11), securing with spring retainer (10), and pin spring (4). Replace parts (8), (7), (6), (5), and (4). Replace gasket (3) in position. Replace carburetor, and secure with washers (2) and nuts (1).

IV. IDLE ADJUSTMENT.

(See Illustration)

Adjust stop screw (1) to crack throttle valve slightly. Start and warm engine. Adjust mixture screw (2) until engine idles smoothly. Re-adjust stop screw to idle engine at approximately 400 rpm. Readjustment of stop screw (1) may necessitate a slight readjustment of mixture screw (2).

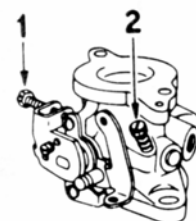

CARTER WO TYPE CARBURETORS

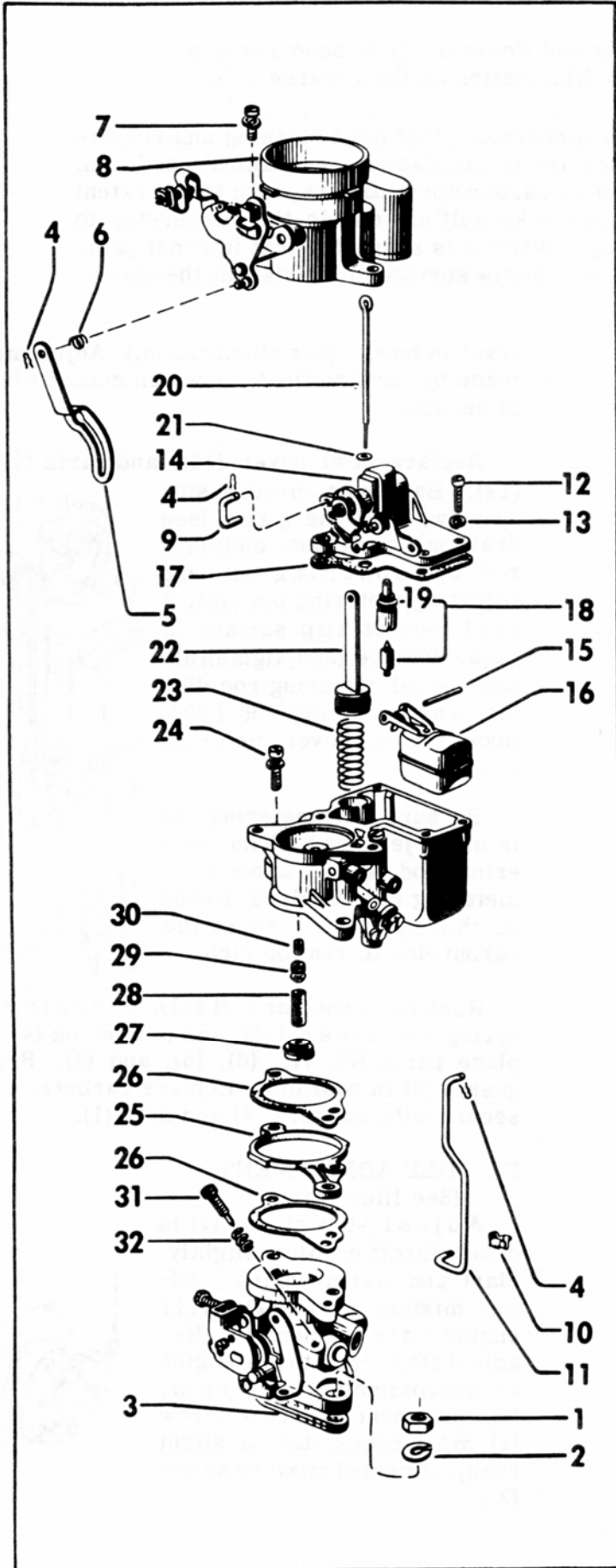

Ref. No.	Nomenclature
1	Nut - Flange
2	Lockwasher - Flange Stud . . .
3	Gasket & Diffuser Assembly - Flange
4	Spring - Pin
5	Link - Choke Connector
6	Spring - Connector Link
7	Screw & Washer Assembly . . .
8	Air Horn Assembly
9	Link - Connector
10	Retainer - Spring
11	Rod - Connector
12	Screw - Bowl Cover Attaching
13	Washer - Bowl Cover Screw . .
14	Bowl Cover Assembly
15	Pin - Float Lever
16	Float & Lever Assembly
17	Gasket - Bowl Cover
18	Needle & Seat Assembly
19	Gasket - Needle Seat
20	Rod - Metering (Standard) (One Size Lean)
21	Disc - Metering Rod
22	Plunger & Rod Assembly
23	Spring - Pump
24	Screw & Washer Assembly . . .
25	Insulator
26	Gasket - Body Flange
27	Plug & Gasket Assembly - Pump Check
28	Strainer - Gauze
29	Check Assembly - Intake Ball
30	Check Assembly - Discharge Disc
31	Screw - Idle Adjustment
32	Spring - Idle Adjustment Screw
	Gage - Metering Rod (Not Illustrated)