

2018+ SUBARU ASCENT MUD FLAP INSTALLATION INSTRUCTIONS

View instructions and photos online www.rallyarmor.com

CARE AFTER INSTALLATION Once installed, the vehicle owner is responsible for the condition of the mud flaps and all costs associated with replacing damaged or lost parts. Warranty covers manufacturer defect on new, never installed parts.

⚠ Watch for blind spots when parking ⚠ Avoid contact with curbs, bumps and objects that can compress the flaps with excessive force. Be sure to check wheel clearances, especially on vehicles equipped with aftermarket wheels and suspensions.

QUESTION ON INSTALLATION? CONTACT US ONLINE www.rallyarmor.com/support

NEED TO PURCHASE REPLACEMENT PARTS? SEND RECEIPT OR PHOTO OF RALLY ARMOR LOGO ON FLAPS TO US www.rallyarmor.com/support

IMPORTANT NOTES

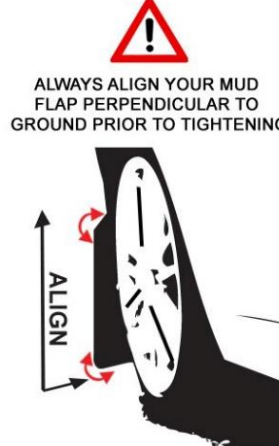

INSTALLATION KIT CONTENTS

QUANTITY	PART	ITEM ID
6	Long Stainless Steel Screw	1.5SS
8	Short Stainless Steel Screw	1SS
14	Washer	SMWASH
8	White Insert	INS7
2	Rear Bracket	BMF49-RE
2	Long Foam Spacer	SMF29-2
6	Polygon Clip	POLCLP

POLCLP
Polygon Clip



Ins7
White Insert



1.5SS
"Long" Screw



SMWASH
Washer



1SS
"Short" Screw



SMF29-2
Long Foam Spacer

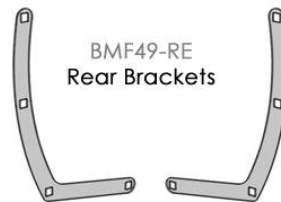

Recommended Tools Low-profile, ratcheting offset or stubby Phillips screwdriver, small flathead screwdriver, panel removal tool. **Important Tips** Installation should be done on an even surface. The hardware self-threads so avoid overtightening.

RALLY ARMOR - A BIT ABOUT OUR STANDARD IN MUD FLAPS

Rally Armor mud flaps are fabricated from a high grade polyurethane plastic that is rigorously reviewed for quality and consistency. As with all manufacturing processes, controlled conditions and multiple QC checkpoints minimize major irregularities, however certain very minor surface layer marks appear periodically. These are visual variations that do not affect construction nor do they impede the performance of the flaps. Most matte away as the material ages naturally with continued exposure to the outdoors. Each flap is unique in appearance yet all are equally structurally sound.

2018+ SUBARU ASCENT MUD FLAP INSTALLATION INSTRUCTIONS

FRONT MUD FLAP **HARDWARE for 1 front flap → 3 x POLCLP; 3 x 1.5SS; 3 x SMWASH**

To access the inner wheel well, turn the steering wheel towards the side you are working on.

FIGURE A Pull liner away from inner fender area after removing the 3 liner fasteners.

FIGURE B Install 3 Polygon Clips **POLCLP** over the existing metal fender mounts. Re-install plastic liner.

FIGURE C Position the mud flap logo-side facing the rear of the vehicle against the corresponding mounting points on the fender liner and bracket. Place a Washer **SMWASH** over a Long Screw **1.5SS** through the flap into each of the 3 Polygon Clips. Align the outer edge of the flap by making slight angle adjustments then walking away from the vehicle to ensure the flap is even with the ground. Tighten mounting screws until just seated against the mud flap.

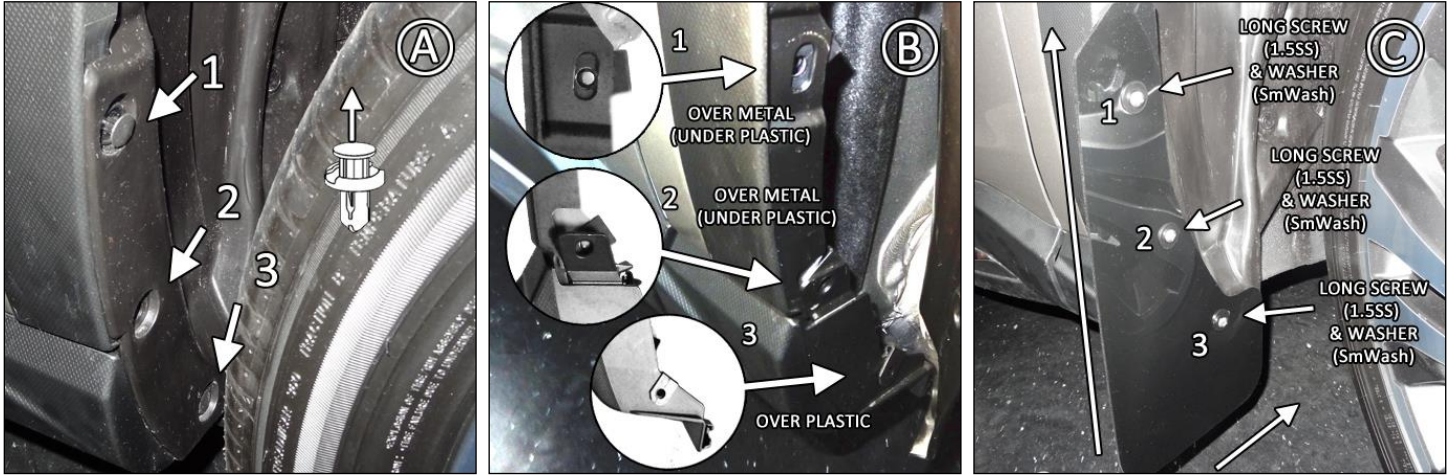

REAR MUD FLAP **BRACKET & HARDWARE for 1 rear flap → 1 x BMF49-RE; 1 x SMF29-2; 4 x 1SS; 4 x INS7; 4 x SMWASH**

FIGURE D Paying close attention to the position, install 4 square White Inserts **INS7** into a rear bracket **BMF49-RE** specifically as shown. Be sure that the square sections of the inserts are flush with the bracket.

FIGURE E To nest the bracket against the wheel well liner without overextending the curve, subtly and just slightly curve the lower portion of the bracket towards the rear of the vehicle.

FIGURE F Clean and dry the inner plastic wheel well liner then locate the section where the bracket meets the liner. Mount the adhesive-backed Long Foam Spacer **SMF29-2** along the lower edge of the liner. Bracket will rest against the spacer.

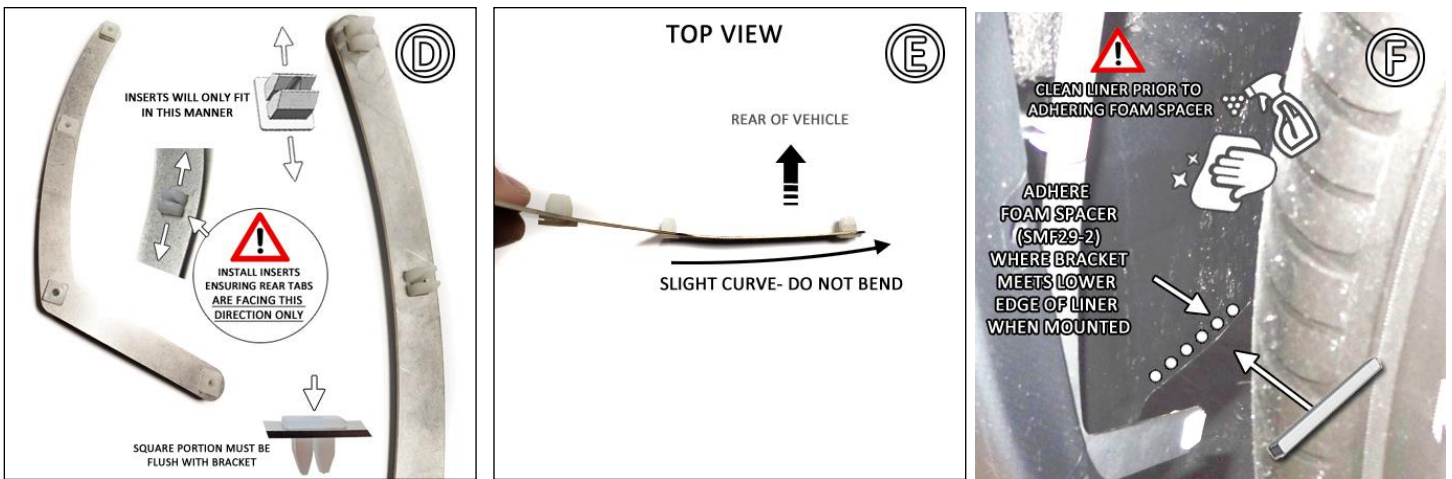

FIGURE G Referring to the arrowed mounting points in Figure G, make sure both bumper mounts line up with the 2 middle mounts on the bracket.

2018+ SUBARU ASCENT MUD FLAP INSTALLATION INSTRUCTIONS

Install the rear bracket underneath the bumper skin, over the fabric liner. The White Inserts should nest up against the fabric liner.

FIGURE H Position the mud flap against the corresponding liner mounting points. Place a Short Screw **1SS** into a Washer **SMWASH** then thread into each of the mounting points. Mounts 2 & 3 go through the bumper skin first then into the bracket.

FIGURE I Walk away from the vehicle to view the alignment of the outer edge of the flap to the ground. Make slight angle adjustments until even to the ground then tighten all mounting screws until just seated against the mud flap.

