



**2015+ SUBARU IMPREZA WRX & STI SEDAN MUD FLAP INSTALLATION INSTRUCTIONS**

For high resolution color images of these instructions, please visit <http://www.rallyarmor.com>

Check wheel clearance after installation, especially vehicles outfitted with non-OEM wheels and suspensions.

**To protect your Rally Armor mud flap set, care must be taken during parking and reversing.**

Rally Armor is not responsible for damage or loss of installed flaps.



**ALWAYS TEST COMPATIBILITY WITH YOUR SPECIFIC WHEEL, TIRE AND SUSPENSION COMBINATION**



**ALWAYS USE CAUTION DURING PARKING/REVERSAL SCENARIOS**



**CLEANING INSTRUCTIONS: USE WATER AND SOFT CLOTH TO CLEAN FLAPS. AVOID SOLVENT BASED CLEANERS**



**ALWAYS ALIGN YOUR MUD FLAP PERPENDICULAR TO GROUND PRIOR TO TIGHTENING**

**YOUR MOUNTING HARDWARE CONSISTS OF:**

Quantity	Hardware Item	Item ID
4	Flat "U" Clips	UClip
4	"S" Clips	SClip
12	Small Washers	SmWash
4	Lock Nuts	SSLnut
6	Short Screws	1SS
2	Long Screws	1.5SS
2	Inserts	Ins3
2	Front Mounting Brackets	HMF32-FR-BR
2	Rear Mounting Brackets	HMF32-RE-BR
2	Front Spacers	HMF32-SP

**GUIDE TO CLIPS PROVIDED:**



"S" CLIP



"U" CLIP

**HOW TO REMOVE STOCK FASTENERS:**

- 1 Pry or unscrew inner portions out first
- 2 Remove outer portion of fastener

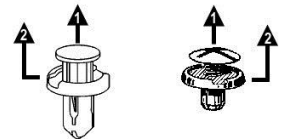

**Important Notes**

**Recommended tools:** Offset, ratcheting or stubby Phillips screwdriver, small flat head screwdriver, 7/16" wrench.

**Cautionary Tip:** The hardware is strong and self-threading but over-tightening the clips is not advised.

**Installation Tip:** To ease installation and avoid damage to existing OEM clips during removal, a well-lit, climate controlled installation environment is recommended.

**Parking and Reversing:** Any extended mud flap application can be damaged or dislodged should they get caught in between a tire and a curb or object. To protect your Rally Armor mud flap set, care must be taken during parking and reversing. Rally Armor is not responsible for damage or loss of installed flaps.

**To the customer:** Retain these instructions after installation. They may be necessary for installing other optional parts or removal of this accessory.

**To the installer:** Please return these instructions to the customer after installation. Always test and adjust wheel clearance before returning vehicle.

**CAREFULLY HAND THREAD LOCK NUTS TO BOLT FIRST TO AVOID CROSSTHREADING**

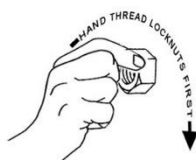

**A MISALIGNED NUT WILL DAMAGE OR SHEAR A BOLT TIGHTEN AFTERWARDS ONLY UNTIL SNUG**

**REPLACEMENTS FOR MIS-INSTALLED, DAMAGED OR LOST HARDWARE DURING INSTALLATION ARE THE SOLE RESPONSIBILITY OF THE INSTALLER**

## Front Mud Flap Installation

- **(Figure A)** Park vehicle on an even surface. Turn the steering wheel towards the side you are working on. Remove 3 outer fender liner fasteners and the single side skirt liner fastener found underneath.
- **(Figure B)** Pull liner away to gain access to inner fender. Place the upper/top portion of the "S" clip (SClip) over each of the 2 upper mounting points as shown. Place a single Flat U clip (UClip) over the lowest mounting point. Replace liner as before, replace original fastener underneath.
- **(Figure C)** Create a slight bend no more than .5" (anywhere from 10° to 12°) on one of the front brackets using the marks as a center guide as shown. This will create turning clearance for your tires and can be further adjusted when installed on the vehicle.

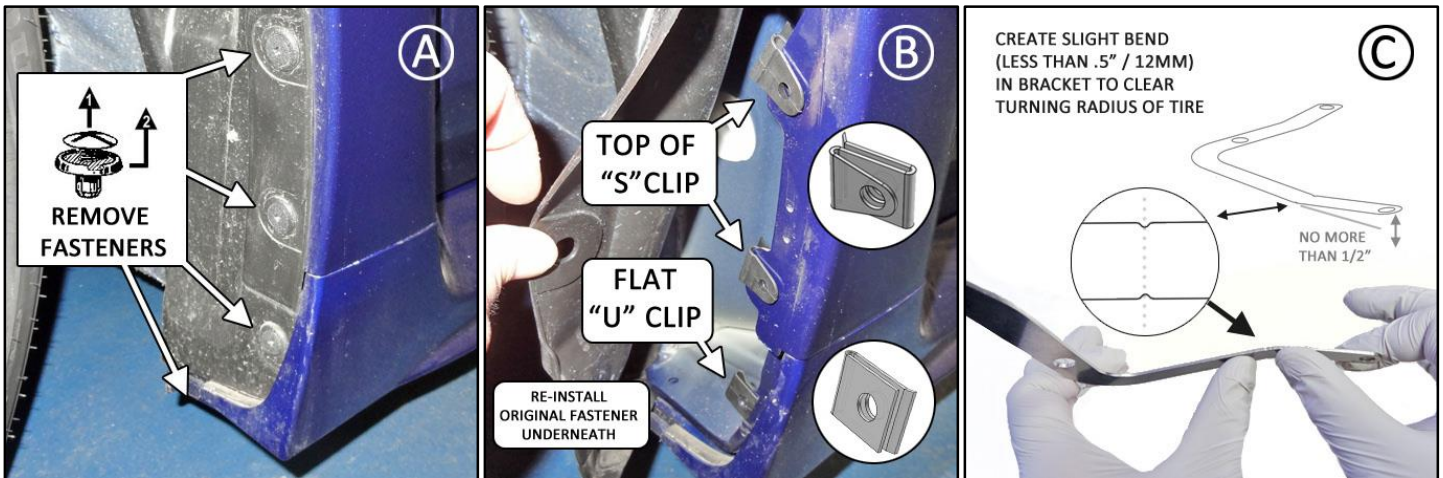

- **(Figure D)** Place the front bracket against the logo side of the flap with the bent portion lifting up. Place the spacer with the hollow side facing up, and the curved edge towards the outside edge of the mud flap. You will be installing this mounting point first with the long screw (1.5SS) into the vehicle. The spacer will fill the void in the lower portion of the wheel well liner when up against the car.
- **(Figure E)** Loosely bolt a long screw (1.5SS) and a washer (SmWash), through the mud flap, bracket and spacer first. Install a short screw (1SS) and small washer (SmWash) into each of the two upper mounting points, with the middle mounting point threading into the top hole of bracket. Secure the last inside mounting point with the supplied insert (Ins3) through the mud flap into the bracket. **IMPORTANT- You must confirm adequate tire turning clearance by turning the wheel towards the side you are working on. Adjust by tightening the mounts and bending the bracket back away from the tire along with the inner portion of the flap as in figure C.**
- **(Figure F)** Align outer edge of the flap by incrementally adjusting the assembly side to side, as well as the lower & upper portions of the flap. Align spacer so it is vertical via the opening on the side. Check your adjustment, and confirming the flap is perpendicular to even ground. Tighten all mounting screws only until snug against washer. Do not over tighten the mounting screws.

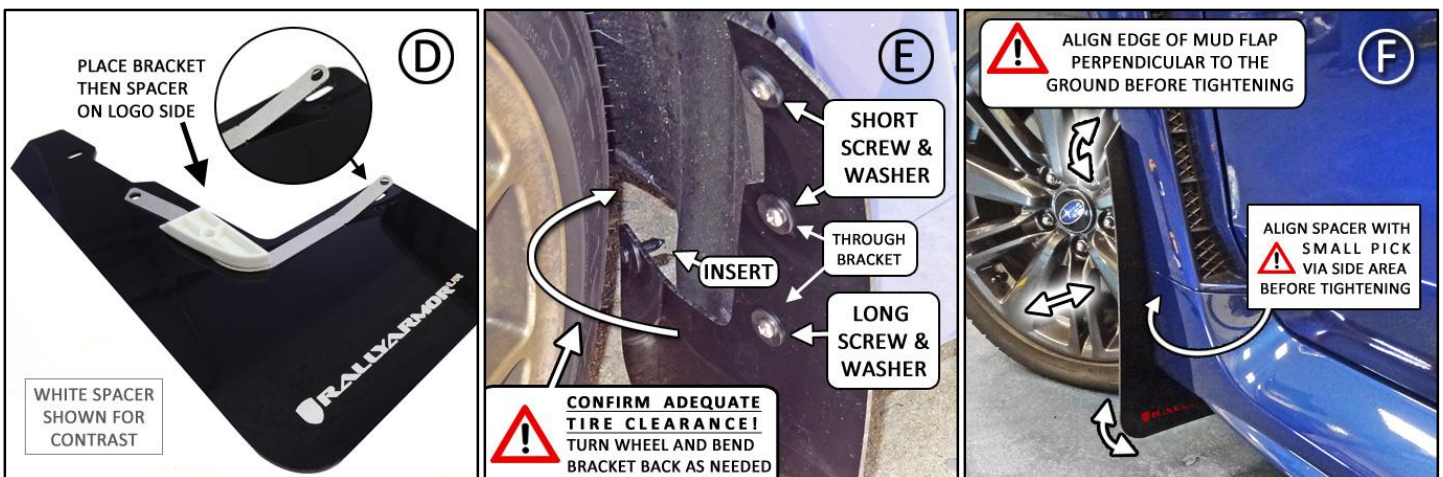

## Rear Mud Flap Installation

- (Figure G) Remove the lower bumper skin retainer closest to the tire.
- (Figure H) Slide lower portion of rear bracket between bumper and fender liner.
- (Figure I) Place flat U-Nut on middle mounting point of bracket at an angle as shown.



- (Figure J) Place the rear bracket (with U clip) in the void behind the bumper skin, ensuring the upper stud mounting point is visible as shown.
- (Figure K) Secure bracket by reinstalling the original retainer into lower mounting hole of bumper, though the mounting bracket and liner until flush. Push lower inside mounting point back.
- (Figure L) Loosely bolt a short screw (1SS) and a washer (SmWash), through the middle mud flap mounting point into the "U" clip installed on the bracket. Install a lock nut (SSLnut) and washer (SmWash) into each of the remaining upper and lower mounting studs. Push the inner bracket away from the tire towards the rear of the vehicle. Align outer edge of the entire flap/bracket assembly until perpendicular to even ground. Tighten all mounting screws and lock nuts only until snug against washer. Do not over tighten.

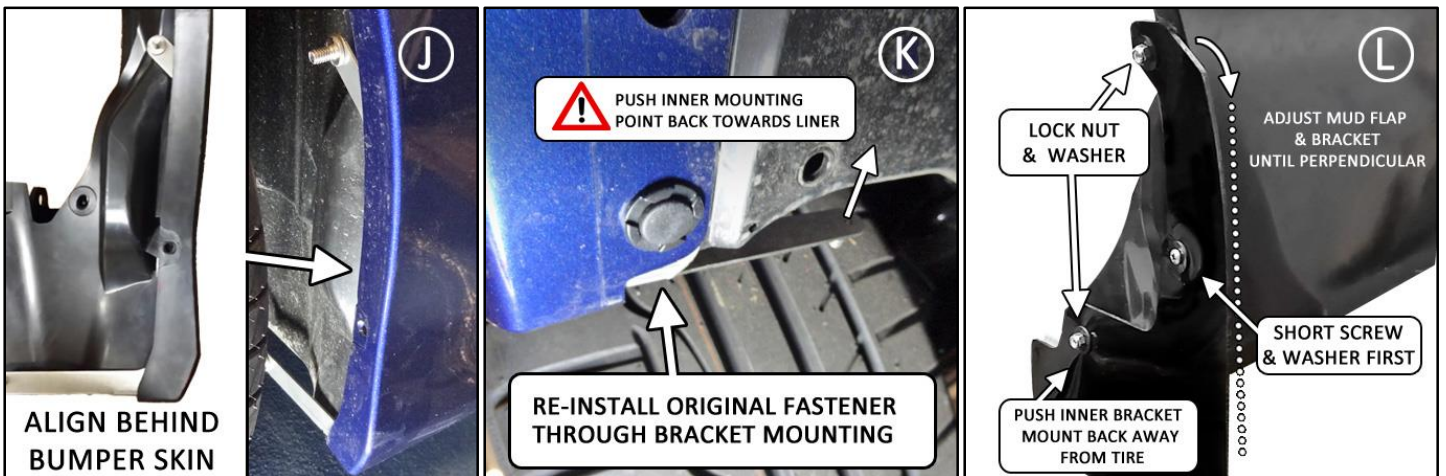

IMF32

2015+ SUBARU WRX AND STI SEDAN INSTALLATION DIAGRAM

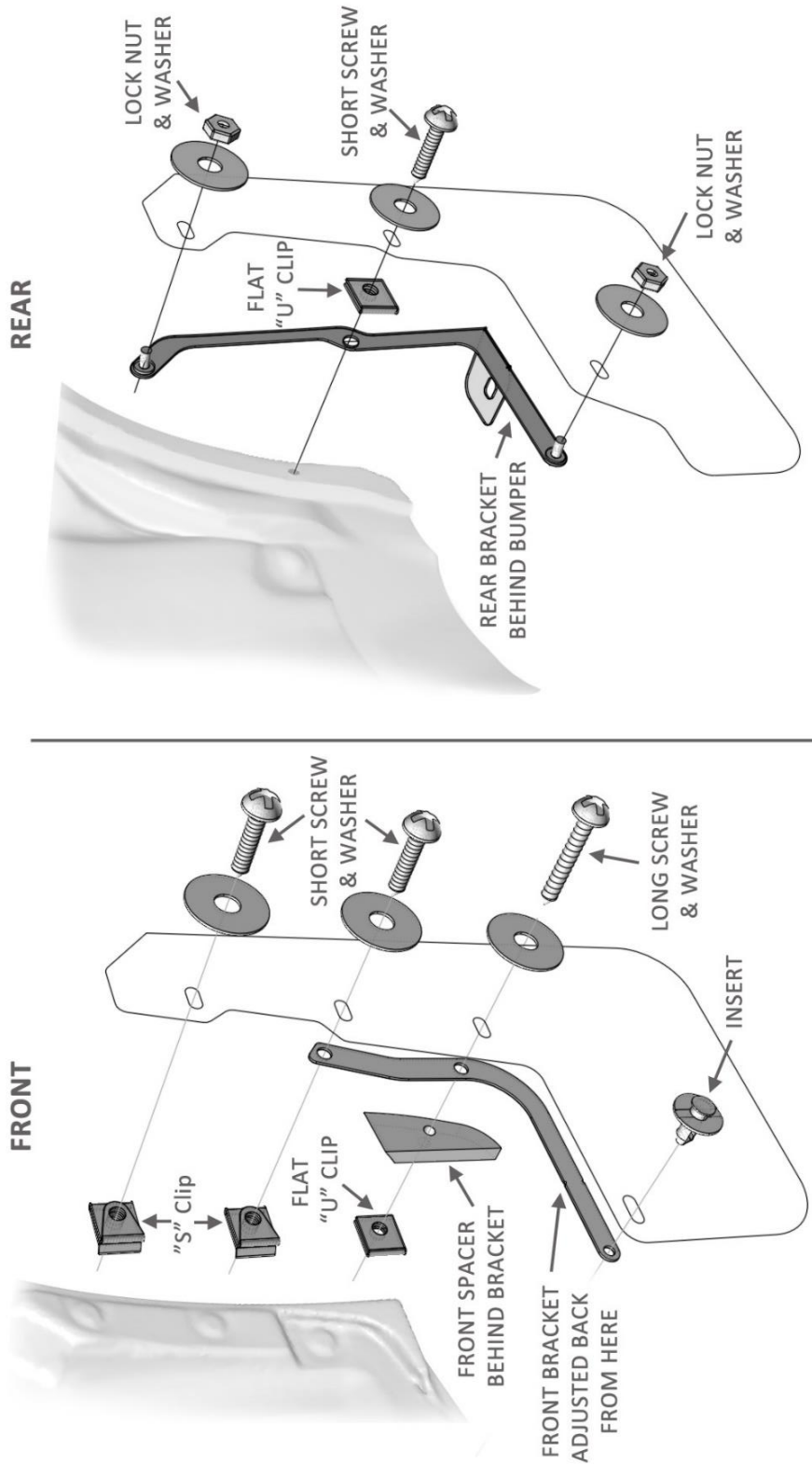

Check wheel clearance after installation, especially on vehicles outfitted with non-OEM offset wheels and suspensions. Adjust to accommodate accordingly in these scenarios. **Rally Armor is not responsible for damage or loss of installed flaps.**

All content included on these instructions is the copyright of Rally Armor® LLC