



## 2012+ HYUNDAI VELOSTER (NON-TURBO & TURBO) MUD FLAP INSTALLATION INSTRUCTIONS

**PLEASE REVIEW THESE INSTRUCTIONS IN ITS ENTIRETY BEFORE ATTEMPTING INSTALLATION**

For high resolution color images of these instructions, please visit <http://www.rallyarmor.com>

To protect your Rally Armor mud flaps, **care must be taken during parking and reversing.** Rally Armor always recommends professional installation. Check wheel clearances after installation, especially on vehicles outfitted with non-OEM offset wheels and suspensions. Adjust accordingly. **Rally Armor is not responsible for damage or loss of installed mud flaps.**



Each mud flap set contains 4 flaps and mounting brackets and hardware (unless otherwise noted).

**Recommended tools:** Offset/ratcheting Phillips, small & long flat head screwdrivers.

**Tire removal not necessary to complete installation.**

YOUR 2012+ HYUNDAI VELOSTER MOUNTING HARDWARE CONSISTS OF:			HOW TO REMOVE STOCK FASTENERS:																							
<table border="1"> <thead> <tr> <th>Quantity</th> <th>Hardware Item</th> <th>Item ID</th> </tr> </thead> <tbody> <tr> <td>2</td> <td>Front brackets</td> <td>HMF24-BR-FR</td> </tr> <tr> <td>2</td> <td>Rear Brackets</td> <td>HMF24-BR-RE</td> </tr> <tr> <td>2</td> <td>Front Side Skirt Spacers</td> <td>HMF24-SP</td> </tr> <tr> <td>4</td> <td>Polygon Clips</td> <td>PoICI</td> </tr> <tr> <td>4</td> <td>Stainless Steel Screws</td> <td>1SS</td> </tr> <tr> <td>2</td> <td>Stainless Steel Lock Nuts</td> <td>SSLnut</td> </tr> <tr> <td>18</td> <td>Washers</td> <td>SmWash</td> </tr> </tbody> </table>	Quantity	Hardware Item	Item ID	2	Front brackets	HMF24-BR-FR	2	Rear Brackets	HMF24-BR-RE	2	Front Side Skirt Spacers	HMF24-SP	4	Polygon Clips	PoICI	4	Stainless Steel Screws	1SS	2	Stainless Steel Lock Nuts	SSLnut	18	Washers	SmWash	<ol style="list-style-type: none"> <li>1 Pry or unscrew inner portions out first</li> <li>2 Remove outer portion of fastener</li> </ol>	
Quantity	Hardware Item	Item ID																								
2	Front brackets	HMF24-BR-FR																								
2	Rear Brackets	HMF24-BR-RE																								
2	Front Side Skirt Spacers	HMF24-SP																								
4	Polygon Clips	PoICI																								
4	Stainless Steel Screws	1SS																								
2	Stainless Steel Lock Nuts	SSLnut																								
18	Washers	SmWash																								
<p><b>Important Notes</b></p> <p><b>Cautionary Tip:</b> The hardware is strong and self threading but <u>over-tightening the mounting clips is not advised.</u></p> <p><b>Installation Tip:</b> To ease installation and avoid damage to existing OEM clips during removal, a well lit, climate controlled installation environment is recommended.</p>			<p><b>To the installer:</b> Please return these instructions to the customer after installation. Always test and check wheel clearances before returning vehicle.</p> <p><b>To the customer:</b> Retain these instructions after installation. They may be necessary for installing other optional parts or removal of this accessory.</p>																							

## Front Mud Flap Installation

Begin by parking the vehicle on an even surface. Turn the steering wheel to allow access to the inner wheel well area.

- **(Figure A)** Remove the 2 outer OEM fender liner screws. You will re-use these fasteners to mount a portion of the mud flap.
- **(Figure B)** Remove the first 10mm fender bolt underneath the vehicle. On non-side skirt equipped vehicles, undercoating overspray covering the bolt head can be removed with the tip of a flat screwdriver for access.
- **(Figure C)** Reinstall the 10mm bolt through “square” end of bracket. Round end faces **forward** and **away** from the vehicle. Do not fully tighten. Thread bolt enough to allow for adjustment (passenger side shown).



- **(Figure D)** Place polygon Clip (PoCl) over round edge of bracket.
- **(Figure E)** Place the 1SS screw with washer (SmWash) through inner mounting point “A” on flap, and place **TWO** washers (SmWash) on the opposite side of mud flap as a spacer against bracket. Align front mud flap against the corresponding mounting points with the logo facing toward the rear of the vehicle.

Thread section “A” into bracket. Place washers (SmWash) over original screws removed, and remount them through the flap mounting points “B” and “C”. **Do not fully tighten. The mounting points are slotted to allow for movement and final alignment of flap.**

**! ON VEHICLES EQUIPPED WITH A SIDE SKIRT:** Mount the front spacer HMF24-SP (with notch facing center of car) behind point “C”. **Bottom of the spacer sits on top of side skirt**

- **(Figure F)** Align outer edge of the flap by incrementally adjusting the angle and width of the flap and walking away from the vehicle until the flap is perpendicular to even ground. **Do not over tighten. Tighten all mounting screws and bracket bolt only until snug.**

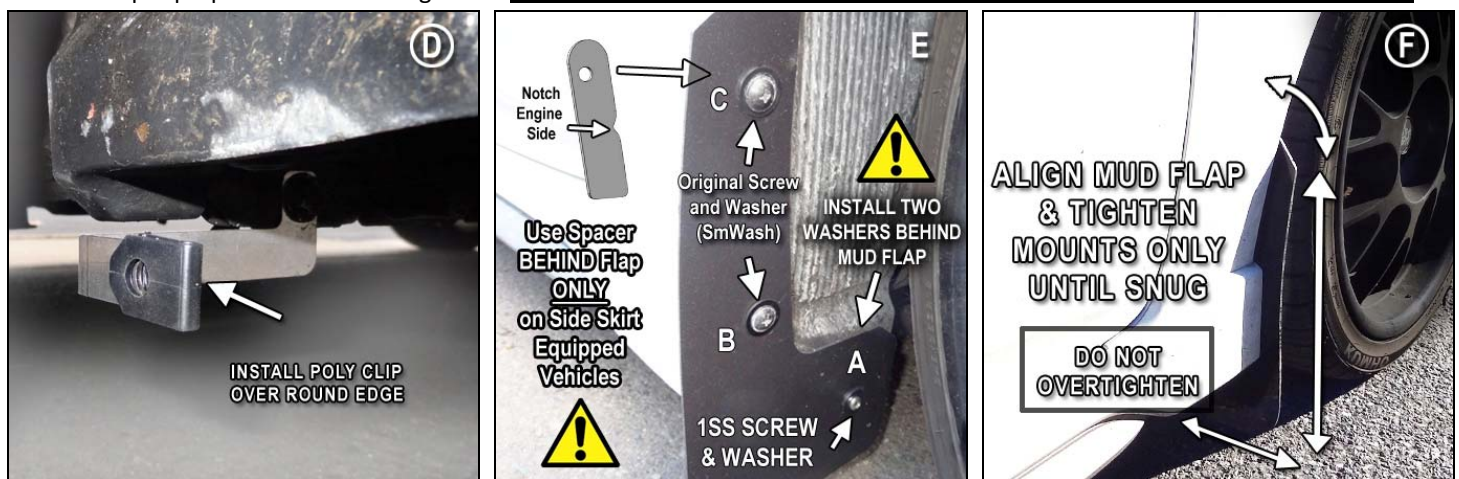



## Rear Mud Flap Installation

- **(Figure G)** Remove the 2 rear outer OEM fender liner screws. You will re-use these fasteners to mount a portion of the mud flap.
- **(Figure H)** Remove the OEM fender liner fastener found underneath the bumper skin closest to the tire. On Turbo models, this fastener is re-used to mount the bracket.
- **(Figure I)** Non-turbo Rear Bumper Install a polygon clip (PoICI) underneath the fender liner over the bumper mount.

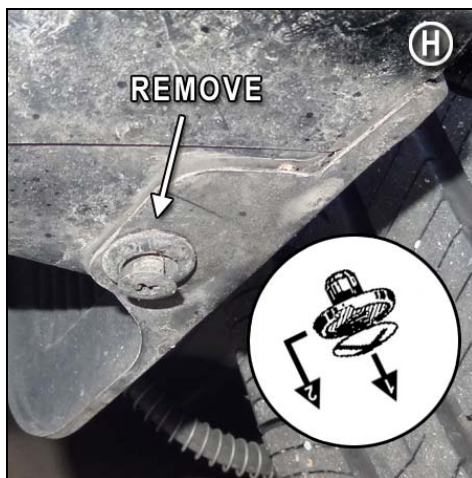

- **(Figure J)** Non-turbo Rear Bumper Install rear bracket (HMF24-BR-RE) using a screw (1SS) and washer (SmWash) through the fender liner and clip.
- **(Figure K)** Turbo rear bumper Install rear bracket (HMF24-BR-RE) using the original fastener.
- **(Figure L)** Place the mud flap with the logo facing the rear of the vehicle, against the corresponding mounting points on the vehicle and bracket. Place a washer (SmWash) over each of the original screws through the flap into the outer edge mounted clips. Mount inner portion to bracket with a washer (SmWash) and lock nut (SSLnut).

Align outer edge of the flap by incrementally adjusting the lower and upper portions and walking away from the vehicle until the flap is perpendicular to even ground. **Tighten all screws, including bracket mounting points, only until snug. Do not over tighten.**

