

Super Hold Servo Kit

Part No.

28821-09K

- Servo Assembly
- Cover Gasket
- Case to Cover O-Ring
- PTFE Servo Pin Seals (2) 1 extra
- PTFE Primary Piston Seals (2)
- Return Spring

Patent No. 5,944,627

GM Powerglide[®]

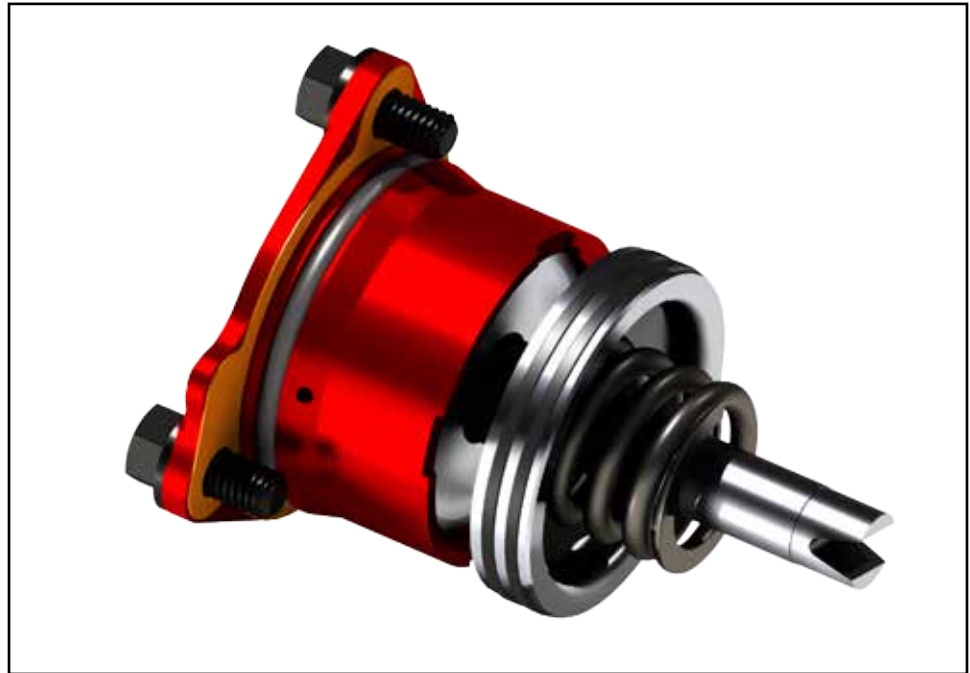

Line Pressure & Setup

The Sonnax super hold servo kit **28821-09K** has patented dual-apply piston with combined area that is 30% greater than the OE servo. The larger apply area increases band apply force, which allows line pressure to be reduced by approximately 20% to 30% for greater efficiency while still providing the same amount of apply force to the band.

CAUTION: Combining the larger servo and line pressure of 300 psi or higher can stress stock cases and bands leading to failure.

Preparation

1. Chamfer the pin bore in the case to aid installation of the PTFE seal on the servo pin.
2. Remove sharp edges from feed hole in case where feed hole meets large diameter of servo bore.
3. Install only the servo pin PTFE seal. With no cover O-ring, piston seals or return spring on the servo assembly and only the PTFE seal installed, test fit the servo pin and PTFE seal into the case to size the seal and verify ease of installation.

NOTE: One extra seal is provided.

Installation

1. Install the gasket onto the servo cover flange.
2. Install large O-ring on the servo cover and primary piston seals onto the piston.
3. Place the return spring into the case.
4. Lube all seals with TransJel™ and install servo piston assembly into case.
5. Install the three cover bolts using thread locking compound.
6. Install the threaded plug into the servo cover.
7. Adjust the band using normal procedures.

