



POWERGLIDE TRANSMISSION PAN
P/N 42000

PARTS LIST

- | | |
|--------------------------|--------------------------------|
| 1 – Transmission Pan | 2 – 1/4" –20 x 1.75 HHCS |
| 2 – Magnetic Drain Plugs | 2 – 1/4" Split Washers |
| 1 – Filter Spacer | 14 – Serrated Flange Hex Bolts |
| 2 – Spacer Gaskets | |

1. Drain Fluid from transmission and remove old pan.
2. Clean any old gasket material from the pan-mounting surface.
3. Remove filter, clean thoroughly or replace with a new one. Reinstall the filter with the supplied Filter Spacer, Gaskets and 1/4"-20 HHCS and Split Washers (see diagram below). Place a Gasket between the filter and the Filter Spacer and the other Gasket between the Filter Spacer and the mounting area. Tighten with the 1/4"-20 Hex Head Cap Screws and Split Washers to 10 ft.-lbs.
4. Place a new gasket on the pan rail, tighten the pan with supplied Serrated Flange Hex Bolts. Torque to 10 ft.-lbs. (Note: Moroso Performance does not recommend using any type of sealer on the gasket, small pieces may dislodge and clog the transmission or transbrake. Check that Drain Plugs are tight.)
5. The Moroso Transmission Pan holds more fluid than a stock shallow sump type pan, so be certain to fill your transmission to the proper level as indicated on the dipstick. Also, this pan is equipped with a transmission cooling return fitting for applications needing one.

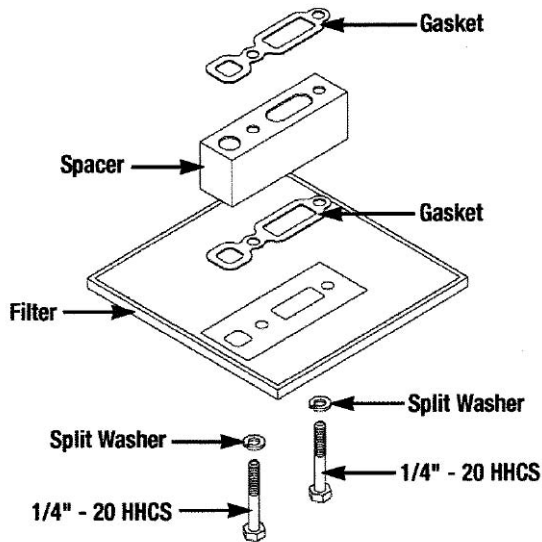

*For Technical Assistance, Call Moroso's Tech Line at
(203) 458-0542, 458-0546 8:30am – 5:00pm Eastern Time*

MOROSO PERFORMANCE PRODUCTS, INC
80 CARTER DR • GUILFORD, CT 06437
Phone: (203) 453-6571 • Fax: (203) 453-6906

Visit Us At www.moroso.com

42000INST

Rev.B
090911



POWERGLIDE TRANSMISSION PAN
P/N 42000

PARTS LIST

- | | |
|--------------------------|--------------------------------|
| 1 – Transmission Pan | 2 – 1/4" –20 x 1.75 HHCS |
| 2 – Magnetic Drain Plugs | 2 – 1/4" Split Washers |
| 1 – Filter Spacer | 14 – Serrated Flange Hex Bolts |
| 2 – Spacer Gaskets | |

1. Drain Fluid from transmission and remove old pan.
2. Clean any old gasket material from the pan-mounting surface.
3. Remove filter, clean thoroughly or replace with a new one. Reinstall the filter with the supplied Filter Spacer, Gaskets and 1/4"-20 HHCS and Split Washers (see diagram below). Place a Gasket between the filter and the Filter Spacer and the other Gasket between the Filter Spacer and the mounting area. Tighten with the 1/4"-20 Hex Head Cap Screws and Split Washers to 10 ft.-lbs.
4. Place a new gasket on the pan rail, tighten the pan with supplied Serrated Flange Hex Bolts. Torque to 10 ft.-lbs. (Note: Moroso Performance does not recommend using any type of sealer on the gasket, small pieces may dislodge and clog the transmission or transbrake. Check that Drain Plugs are tight.)
5. The Moroso Transmission Pan holds more fluid than a stock shallow sump type pan, so be certain to fill your transmission to the proper level as indicated on the dipstick. Also, this pan is equipped with a transmission cooling return fitting for applications needing one.

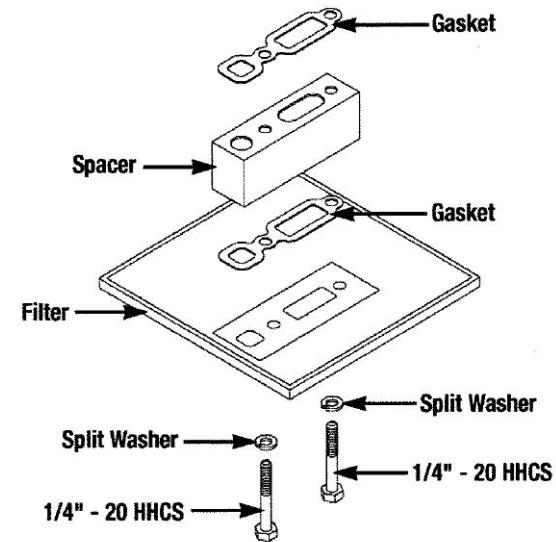

*For Technical Assistance, Call Moroso's Tech Line at
(203) 458-0542, 458-0546 8:30am – 5:00pm Eastern Time*

MOROSO PERFORMANCE PRODUCTS, INC
80 CARTER DR • GUILFORD, CT 06437
Phone: (203) 453-6571 • Fax: (203) 453-6906

Visit Us At www.moroso.com

42000INST

Rev. B
090911