

S6242304 S6242409 S6242AL
2008 FORD SUPER DUTY 6.4L
POWERSTROKE DIESEL, PARTICULATE FILTER
BACK, 4" SINGLE SIDE

MBRP
INC.
PERFORMANCE EXHAUST

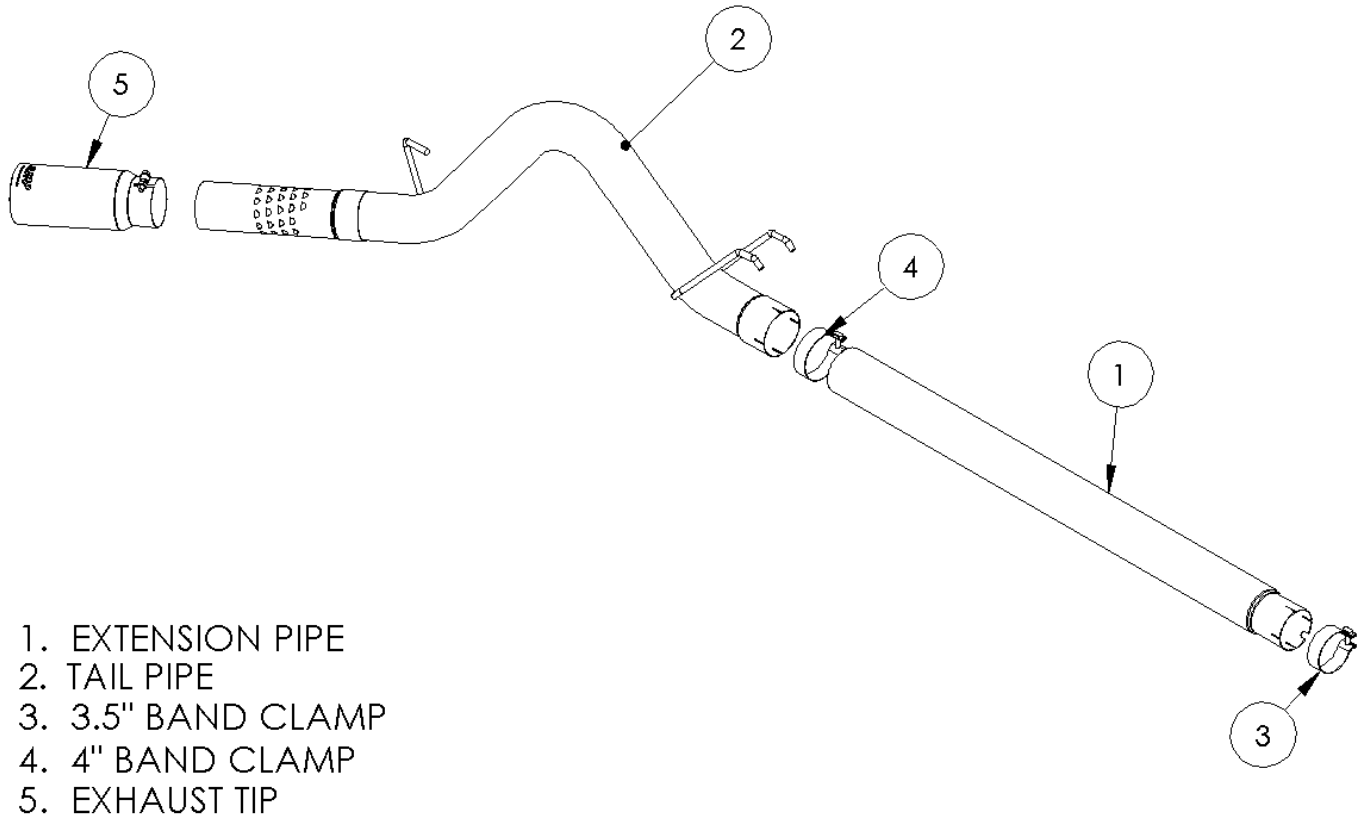

1. EXTENSION PIPE
2. TAIL PIPE
3. 3.5" BAND CLAMP
4. 4" BAND CLAMP
5. EXHAUST TIP

PLEASE READ BEFORE STARTING INSTALLATION

While MBRP Inc. has made every effort to ensure that all components of this system are of superior quality and properly packaged, it is the installer's responsibility to ensure the following before removal of the factory exhaust:

- that ALL components shown above are present.
- that ALL mating components fit together.
- that there are no damaged components.
- that the system you have purchased is appropriate for your vehicle year, model and configuration.
- that the system will not interfere with any modifications previously installed.
- that you have read and understand these instructions.

If you have any questions or are uncertain about any aspect of the installation of this system to your vehicle please contact your dealer before commencing installation.

Installation Instructions for Systems S6242304, S6242409 & S6242AL

08 Ford 6.4L Powerstroke Diesel Extended Cab Short & Long Bed, Crew Cab Short & Long Bed

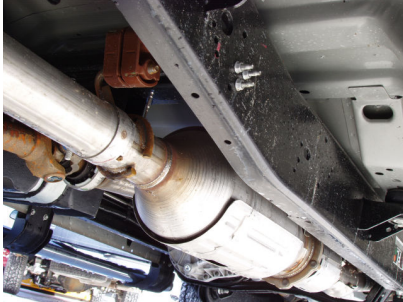

Figure 1

Removal of Stock System:

1. Apply a penetrating lubricant liberally to all exhaust fasteners, hangers and rubber insulators.
2. Loosen the nut on the band clamp located behind the particulate filter using a 15mm wrench or socket. **See Figure 1.**
3. Remove the muffler and tail pipe from the OEM rubber hangers. Cut exhaust as shown in **Figure 2.** Remove from vehicle.



Figure 2

Installation of MBRP Inc. Performance Exhaust:

1. The **Extension Pipe** provided is pre-cut for the crew cab long bed configuration. Cut **Extension Pipe** to length as required for the vehicle being installed to. **See Figure 3.**

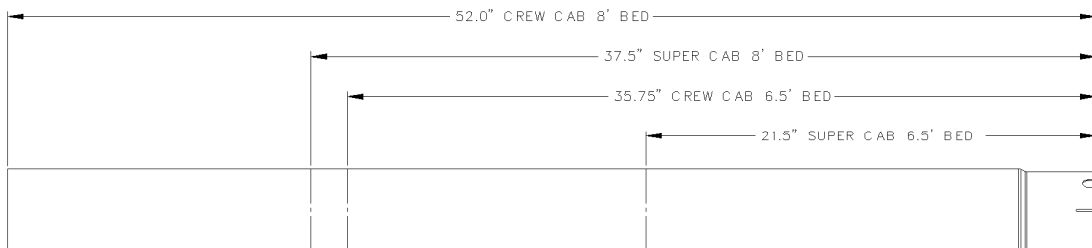

Figure 3



Figure 4

2. Install the **Extension Pipe** over the particulate filter using the **3.5" Band Clamp**. The **3.5" Band Clamp** should remain loose enough for adjustability. See **Figure 4**.

3. Slide a **4" Band Clamp** onto the end of the **Extension Pipe**. Install the **Tail Pipe** onto the **Extension Pipe**. The clamp should remain loose enough for adjustability. See **Figure 5**.



Figure 5

4. Install and adjust the **Exhaust Tip** to suit. Using a 17mm wrench tighten the lock bolt located on the **Exhaust Tip**.

5. Check along the whole length of the exhaust system to ensure that there is **adequate clearance around the fuel and brake lines or any wiring**. If any interference is detected relocate or adjust.

6. Make sure everything is in place before tightening the clamps. Start at the front of the exhaust system and begin tightening all connections.



Congratulations! You are ready to begin experiencing the improved power, sound and driving experience of your MBRP Inc. performance exhaust system. We hope you enjoy your purchase.