



INSTALLATION INSTRUCTIONS

81-0830

FORD

2015-23 Mustang 2.3L

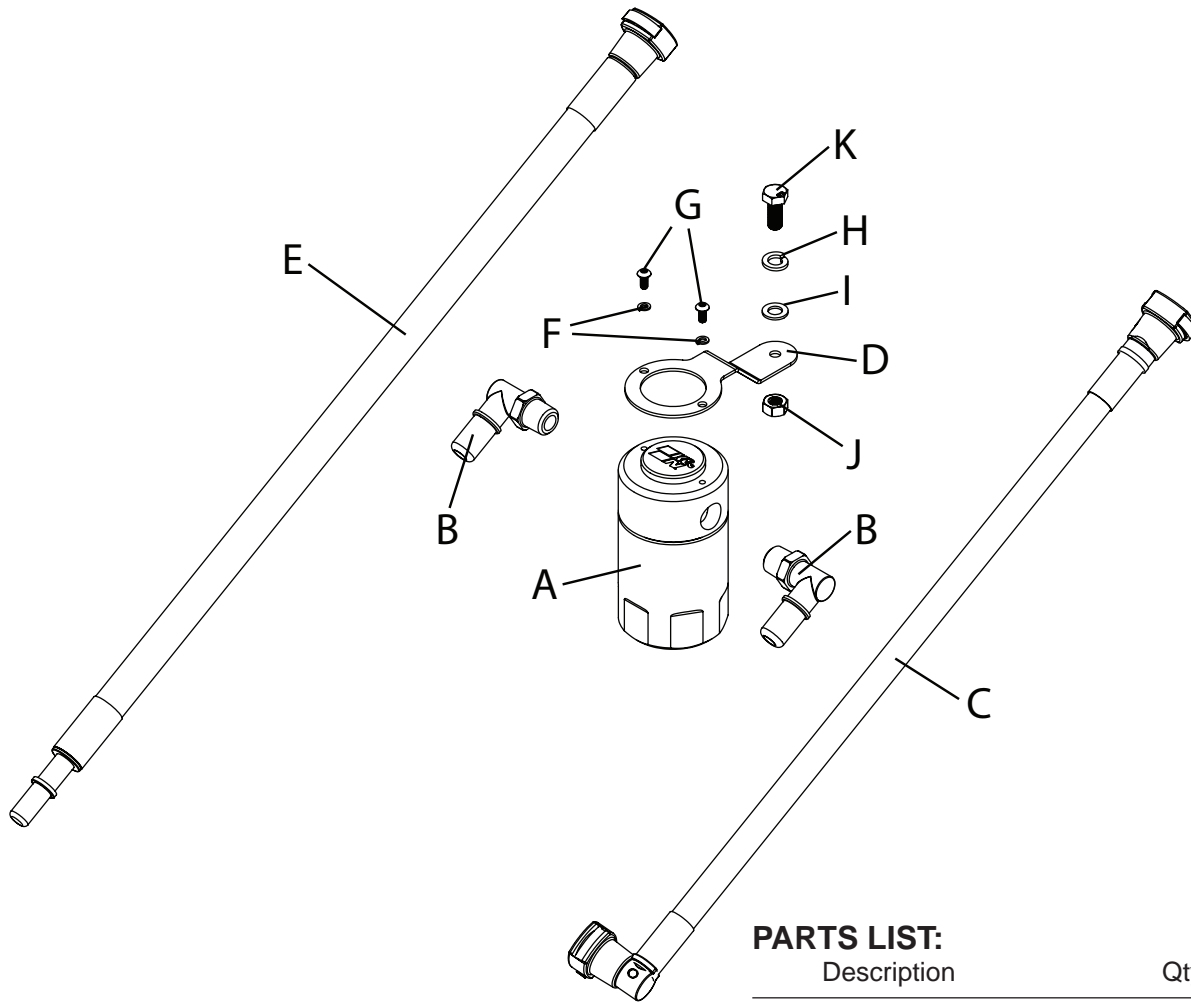

PARTS LIST:

Description	Qty.	Part #
A CATCH CAN; 2.5"OD X 4.5"H	1	85-6860
B QUICK RELEASE; 3/8" NPT 90°	2	082634
C HOSE; 1/2"ID X 18"L	1	084173
D BRACKET	1	010235
E HOSE; 1/2"ID X 20.25"L	1	084172
F 18-8 SPLIT LOCK WASHER	2	92146A618
G BUTTON HEAD CAP SCREW	2	91255A192
H M8 SPLIT LOCK WASHER	1	91248A200
I M8 WASHER	1	98689A116
J M8 NYLOC NUT	1	07503
K M8 X 1 X 20MM BOLT	1	91180A530

TOOLS NEEDED:

- 2.5mm Allen key
- Ratchet
- 8mm Socket
- 10mm Socket
- 13mm Socket
- 13/16" Wrench
- 13mm Wrench

1. Verify you have all the parts included in the kit.

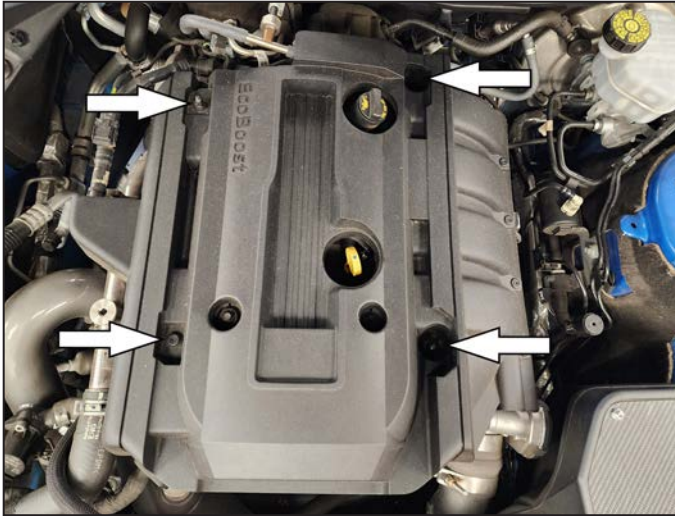

2. Remove engine cover by removing 4 bolts



4. Install hose with male connector into OEM connector. Go through the hole in the intake manifold as shown

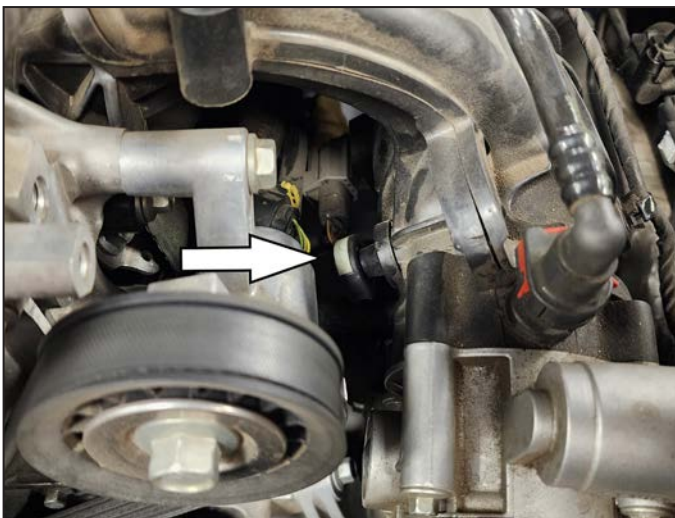

3. Remove factory PCV line by pushing button and removing it from the intake manifold. Rotate the connector slight upward

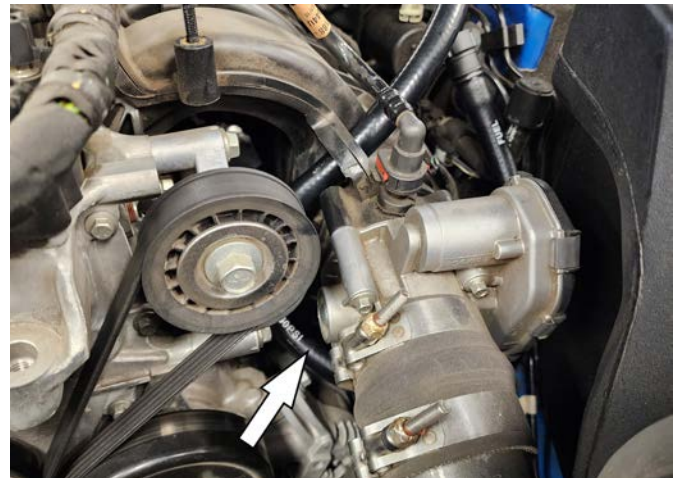

5. Connect the female 90* connector to the intake manifold. Route the hose underneath the throttlebody towards the driver's side strut tower



6. Assemble the quick disconnect fittings to the top of the air/oil separator. It is required to use Teflon tape on the fittings to ensure a proper seal. **NOTE: DO NOT over-tighten fittings in top of oil separator**



7. Install mounting bracket to strut tower tab block using M8 bolt, washer and lock washer as shown



8. Mount the canister to the bracket using the two button head screws and lock washers. Ensure the K&N logo is facing as shown



9. Install hoses on to oil separator as shown. Mount the hose with male fitting to the oil separator connector facing the rear. Mount the hose with female fitting to oil separator connector facing the front. **NOTE: Lightly coat the O-Ring with oil to insert easily.**

10. Reinstall ENGINE COVER.

11. We recommend to check the oil separator every 10,000 miles or 12 months (sooner if vehicle is driven in harsher conditions such as towing or off-road).