

INSTALLATION INSTRUCTIONS

69-8625TWR
TOYOTA
2023-24 GR COROLLA
L3-1.6L TURBO

TOOLS NEEDED:

- Ratchet
- Extension
- 10mm Socket
- Panel Popper Tool
- Phillips Screw Driver
- Flat Blade Screwdriver
- 3mm Allen Key
- 4mm Allen Key

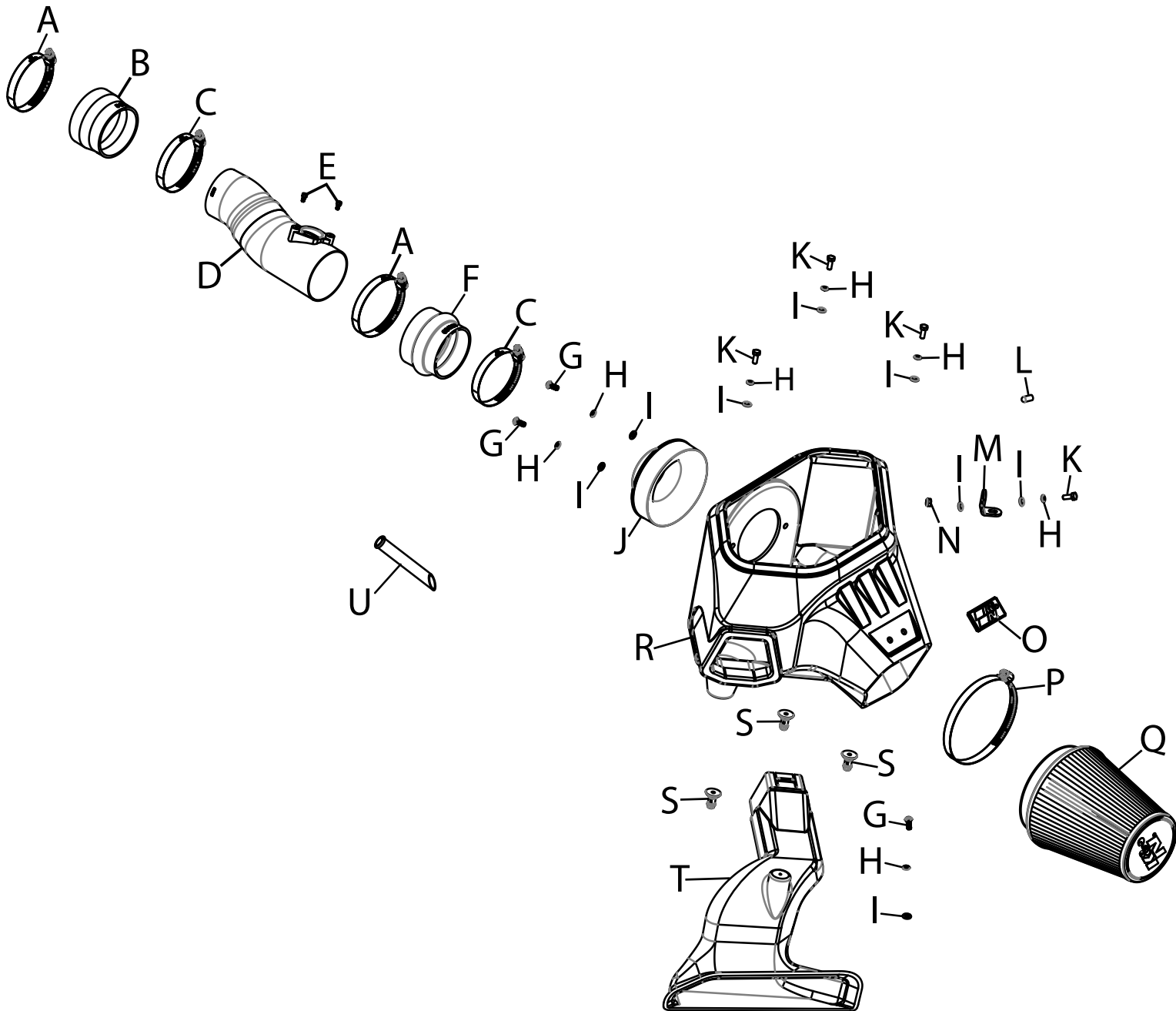

PARTS LIST:

Description	Qty.	Part #	Description	Qty.	Part #	Description	Qty.	Part #
A HOSE CLAMP; #52	2	08610	H WASHER; M6, SPLIT LOCK	7	1-3025	O BADGE; PLASTIC, SNAP-IN	1	088096
B HOSE; ADAPTER 3.25/3"X2.25"	1	5-323	I WASHER; 6MM FLAT	8	08269	P HOSE CLAMP; #88	1	AIR-KITHS88
C HOSE CLAMP; #48	2	08601	J ADAPTER; FILTER, 3"OD	1	21569	Q AIR FILTER	1	RU-2800
D TUBE; 3.0"OD TO 3.25"OD	1	25925WR	K BOLT; M6-1 X 16MM, HEX	4	07812	R AIRBOX; (RH)	1	087568
E BOLT; M4-.7 X 8MM, ALNHD CAP	2	07733	L CAP; RUBBER 5/16"OD X 5/32"ID	1	08282	S MOUNT; PLASTIC AIRBOX	3	8-186-1
F HOSE; HUMP, 3"ID TO 3.25"ID	1	084118	M BRACKET; "L", SML	1	070066A	T AIR DUCT; FRESH AIR, (RI)	1	087570
G BOLT; M6 X 1 X 16MM, BTNHD	3	07730	N NUT; 6MM NYLOCK, HEXHD	1	07512	U INSERT; CCV, ALUM	1	088217

If you need any assistance please call 1-800-858-3333 to speak with a representative in our Customer Service Center before returning the product.

NOTE: FAILURE TO FOLLOW INSTALLATION INSTRUCTIONS AND NOT USING THE PROVIDED HARDWARE MAY DAMAGE THE INTAKE TUBE, THROTTLE BODY AND ENGINE.

TO START:

1. Turn off the ignition and disconnect the negative battery cable.
NOTE: Disconnecting the negative battery cable erases pre-programmed electronic memories. Write down all memory settings before disconnecting the negative battery cable. Some radios will require an anti-theft code to be entered after the battery is reconnected. The anti-theft code is typically supplied with your owner's manual. In the event your vehicles anti-theft code cannot be recovered, contact an authorized dealership to obtain your vehicles anti-theft code.



2. Remove the seven plastic pins that secure the radiator valence and then remove the valence from the vehicle.



3. Remove the four plastic pins that secure the fresh air intake duct sections and then remove both sections of the fresh air duct.



4. Lift off the engine cover.



5. Disconnect the vacuum switch electrical connection and then disconnect the vacuum line shown and unhook it from the air filter housing.



6. Loosen the hose clamp that secures the intake tube to the turbo inlet, Disconnect the mass air sensor electrical connection, release the spring clamps that secure the upper air filter housing and then remove the assembly from the vehicle.



7. Lift up and remove the lower air filter housing.



8. Remove the long vacuum line that routes to the vacuum switch and to the "T" fitting. Remove, and cap off the "T" using provided rubber cap.



9. Install the filter adapter into the K&N air filter housing and secure with the provided hardware. Snap the K&N badge into the air filter housing.



10. Install the three mounting studs into the K&N air filter housing using the provided hardware.



11. Remove the vacuum switch from the factory air filter housing and then secure the provided "L" bracket to the switch using the factory mounting bolt.



12. Secure the switch assembly to the K&N air filter housing using the provided hardware.



13. Feed the K&N fresh air duct over the core support down in behind the grill opening and then secure with the provided bolt. **NOTE: releasing the hood latch allows for easier access while installing the duct behind the grill.**



14. Set the K&N air filter housing into position, insert the duct into the air filter housing and then install the housing so the mounting studs insert into the factory housing mounting grommets.



15. Reconnect the vacuum switch electrical connection.



16. Install the provided couplers onto the K&N intake tube as shown, do not secure the couplers at this time.



17. Install the tube assembly onto the turbo inlet by sliding the coupler onto the turbo, then align the tube and coupler with the filter adapter, adjust the tube and couplers for best fit and then secure all the hose clamps.



18. Reconnect the mass air sensor electrical connection.



19. Install the air filter onto the filter housing and secure with the provide hose clamp.



20. Reinstall the radiator valence and secure with the factory plastic pins.



21. Release the spring clamp the secures the CCV hose to the turbo inlet tube and then disconnect the ccv hose from the tube.



22. Install the provided CCV insert into the turbo inlet tube CCV port, note the position of the CCV insert in photo. The angled opening is to be towards the passenger side of the vehicle. Reconnect the CCV hose and secure with the factory spring clamp. Reinstall the engine cover.
NOTE: in the second photo the mark on the top lip of the CCV insert aligns with the short side of the angle cut. This mark is in the photo for reference only, it is not on the CCV insert provided.



23. Reconnect the vehicle's negative battery cable. Double check to make sure everything is tight and properly positioned before starting the vehicle.

24. It will be necessary for all K&N® high flow intake systems to be checked periodically for realignment, clearance and tightening of all connections. Failure to follow the above instructions or proper maintenance may void warranty.

ROAD TESTING:

1. Start the engine with the transmission in neutral or park, and the parking brake engaged. Listen for air leaks or odd noises. For air leaks secure hoses and connections. For odd noises, find cause and repair before proceeding. This kit will function identically to the factory system except for being louder and much more responsive.

2. Test drive the vehicle. Listen for odd noises or rattles and fix as necessary.

3. If road test is fine, you can now enjoy the added power and performance from your kit.

4. K&N Engineering, Inc., requires cleaning the intake system's air filter element every 100,000 miles. When used in dusty or off-road environments, our filters will require cleaning more often. We recommend that you visually inspect your filter once every 25,000 miles to determine if the screen is still visible. When the screen is no longer visible some place on the filter element, it is time to clean it. To clean and re-oil, purchase our filter Recharger® service kit, part number 99-5050 or 99-5000 and follow the easy instructions.

NOT LEGAL FOR SALE OR USE ON ANY POLLUTION CONTROLLED MOTOR VEHICLE IN CALIFORNIA OR STATES ADOPTING CALIFORNIA EMISSION PROCEDURES.

See knfilters.com for CARB status on each part for a specific vehicle