



# AIRCHARGER®

## HIGH-FLOW INTAKE KITS

NOT LEGAL FOR SALE OR USE ON ANY POLLUTION CONTROLLED MOTOR VEHICLE IN CALIFORNIA OR STATES ADOPTING CALIFORNIA EMISSION PROCEDURES.  
See knfilters.com for CARB status on each part for a specific vehicle

### INSTALLATION INSTRUCTIONS

**63-2613**  
**FORD**  
**2020-24 F250/F350**  
**V8-6.7L Turbo Diesel**

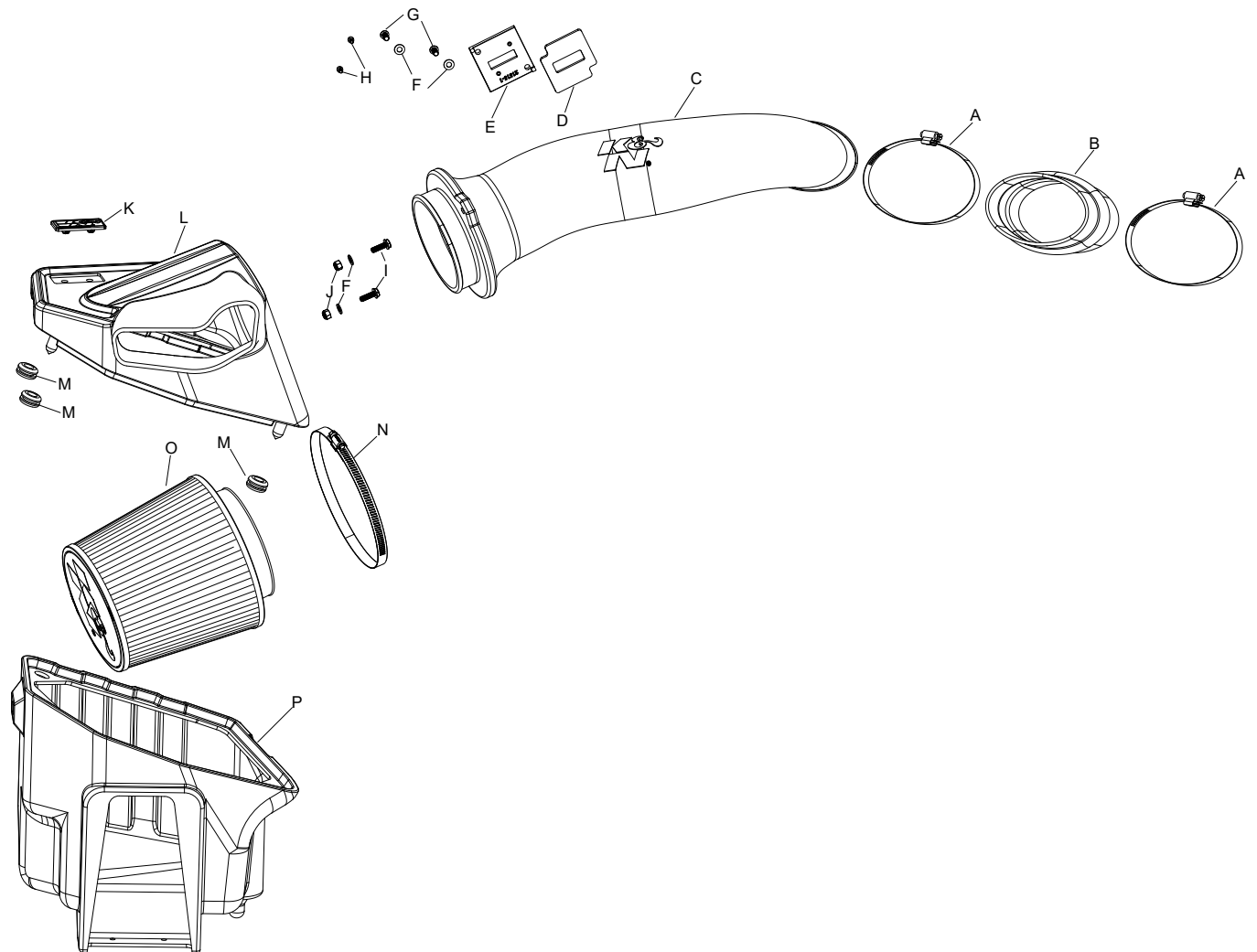

**TOOLS NEEDED:**

- Ratchet
- Extension
- #15 torx
- 8mm socket
- 13mm socket
- 10mm socket
- 8mm socket
- 10mm wrench
- 3mm allen key
- 4mm allen key

**PARTS LIST:**

Description	Qty.	Part #	Description	Qty.	Part #	Description	Qty.	Part #
A HOSE CLAMP; #72	2	08671	G BOLT; M4-.7 X 8MM, ALNHD	2	07733	M GROMMET; 1"OD, 1/2"ID	3	08064
B HOSE; HUMP 4.5"ID X 3"L	1	08695	H SCREW; M6 X 20MM BTNHD	2	KIT20BHC3060	N CLAMP; #88	1	KITHS88
C INTAKE TUBE; (OL)	1	087479A	I BOLT; M6-1 X 30, HEX/FLANGE	2	1-1016	O AIR FILTER	1	RU-5294
D GASKET; 3/16" PORON	1	09069	J NUT; 6MM NYLOCK	2	07512	P AIRBOX; (OM)	1	087480A
E ADAPTOR; MAF SENSOR	1	21515-1	K BADGE; PLASTIC K&N LOGO	1	088096			
F WASHER; 6MM FLAT	4	08269	L LID; (ON)	1	087481A			

**If you need any assistance please call 1-800-858-3333 to speak with a representative in our Customer Service Center before returning the product.**

**NOTE: FAILURE TO FOLLOW INSTALLATION INSTRUCTIONS AND NOT USING THE PROVIDED HARDWARE MAY DAMAGE THE INTAKE TUBE, THROTTLE BODY AND ENGINE.**

**TO START:**

1. Turn off the ignition and disconnect the negative battery cable.  
**NOTE: Disconnecting the negative battery cable erases pre-programmed electronic memories. Write down all memory settings before disconnecting the negative battery cable. Some radios will require an anti-theft code to be entered after the battery is reconnected. The anti-theft code is typically supplied with your owner's manual. In the event your vehicles anti-theft code cannot be recovered, contact an authorized dealership to obtain your vehicles anti-theft code.**



2. Disconnect the mass air sensor electrical connection and unhook the wiring harness from the air filter housing.



3. Loosen the hose clamp that secures the factory intake tube to the turbo inlet pipe.



4. Release the three clips that secure the air filter housing lid and then remove the lid, intake tube and air filter from the vehicle.



5. Remove the pin that secures the fresh air intake duct and then remove the duct from the vehicle.



6. Remove the bolt securing the air filter housing and then remove the housing from the vehicle.





7. Remove the two bolts securing the air filter housing bracket to the inner fender and then remove the bracket from the vehicle.



8. Install the three provided grommets into the K&N air filter housing as shown.



9. Install the K&N air filter housing and secure to the inner fender with one of the factory bolts from step #7.

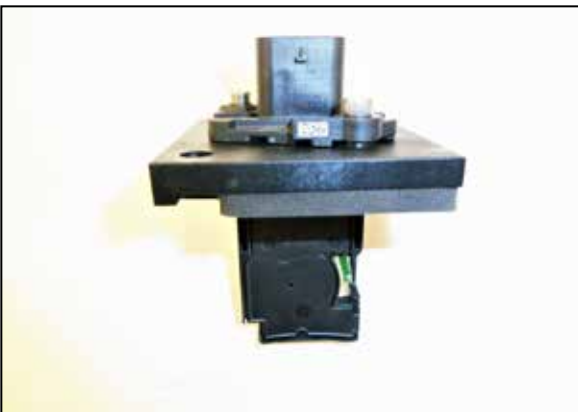

10. Install the gasket onto mass air sensor adapter and then remove the mass air sensor from the factory filter housing and install it into the K&N adapter using the provided hardware.



11. Install the mass sensor assembly into the K&N intake tube, be sure to install the sensor in the correct position so the opening of the sensor is pointed towards the filter end of the intake tube.



12. Attach the intake tube to the air filter housing lid and secure with the provided hardware. Install the K&N badge onto the lid as shown.



13. Install the K&N air filter onto the intake tube and secure with the provided hose clamp.



14. Slide the provided hump coupler completely onto the intake tube with the hose clamps as shown.



15. Install the intake assembly onto the lower air filter housing and guide the pins of the lid into the grommets installed into the lower housing. Once the pins are aligned with the grommets push the lid down to engage.



16. Slide the hump coupler onto the turbo inlet pipe and then secure with the provided hose clamps.



17. Reconnect the mass air sensor electrical connection.



18. Reconnect the vehicle's negative battery cable. Double check to make sure everything is tight and properly positioned before starting the vehicle.

19. It will be necessary for all K&N® high flow intake systems to be checked periodically for realignment, clearance and tightening of all connections. Failure to follow the above instructions or proper maintenance may void warranty.

#### ROAD TESTING:

1. Start the engine with the transmission in neutral or park, and the parking brake engaged. Listen for air leaks or odd noises. For air leaks secure hoses and connections. For odd noises, find cause and repair before proceeding. This kit will function identically to the factory system except for being louder and much more responsive.

2. Test drive the vehicle. Listen for odd noises or rattles and fix as necessary.

3. If road test is fine, you can now enjoy the added power and performance from your kit.

4. K&N Engineering, Inc., requires cleaning the intake system's air filter element every 100,000 miles. When used in dusty or off-road environments, our filters will require cleaning more often. We recommend that you visually inspect your filter once every 25,000 miles to determine if the screen is still visible. When the screen is no longer visible some place on the filter element, it is time to clean it. To clean and re-oil, purchase our filter Recharger® service kit, part number 99-5050 or 99-5000 and follow the easy instructions.

**NOT LEGAL FOR SALE OR USE ON ANY POLLUTION CONTROLLED MOTOR VEHICLE IN CALIFORNIA OR STATES ADOPTING CALIFORNIA EMISSION PROCEDURES.**

See [knfilters.com](http://knfilters.com) for CARB status on each part for a specific vehicle