



Performance Cold Air Intake Kit Part Number: 837-423

**2001-2003 Chrysler Sebring Coupe LXi
2001-2003 Dodge Stratus Coupe R/T
2000-2005 Mitsubishi Eclipse GT 3.0L V6
1999-2003 Mitsubishi Galant V6**

Installation Instructions

For technical inquiries please email us at tech@hpsperformanceproducts.com

In the email, please include the following information for faster response:

- Year / Make / Model / Engine of your vehicle.
- If it is a fitment issue, please include pictures showing the fitment problem.
- If there are missing parts, please list the part number(s) from the bill of materials on the 2nd page.
- Optional but recommended – Your contact phone number and preferred call back time.

You can also give us a call via 626-747-9200 for tech support Monday-Friday, 9:00am-5:00pm Pacific Time.

Bill of Materials

Part Number: 837-423

| Line # | Description | Part Number | Qty |
|--------|-------------------------------|-------------|-----|
| 1 | Upper Air Intake Pipe | 6874321 | 1 |
| 2 | Cold Air Extension Pipe | 6874322 | 1 |
| 3 | HPS Air Filter | HPS-4276 | 1 |
| 4 | MAF Adapter | MAF-002 | 1 |
| 5 | T-Bolt Clamp for 2.75" Hose | SSTC-76-84 | 2 |
| 6 | T-Bolt Clamp for 3" Hose | SSTC-79-87 | 2 |
| 7 | T-Bolt Clamp for 3.25" Hose | SSTC-89-97 | 2 |
| 8 | 2.75" 90 Degree Elbow Coupler | 68415 | 1 |
| 9 | 3" Silicone Coupler | P3SC-300-L2 | 1 |
| 10 | 3.25" Silicone Coupler | P3SC-325-L2 | 1 |
| 11 | 8mm Vacuum Hose x 8" Long | HTSVH8 | 1 |
| 12 | 6mm Hex Head Bolt x 25mm Long | HW-B6-25 | 4 |
| 13 | 6mm Flange Nut | HW-N6 | 7 |
| 14 | 6mm Flat Washer | HW-FW6L | 2 |
| 15 | 6mm Vibration Mount x 1" Tall | HW-RM6-100 | 2 |

- Before installing any parts of this intake system, please read the instructions thoroughly.
- Verify the contents of this intake kit before disassembling your vehicle.
- DO NOT INSTALL IF ANY PARTS ARE MISSING OR DAMAGED. CONTACT tech@hpsperformanceproducts.com IMMEDIATELY. WE ARE NOT RESPONSIBLE FOR ANY DAMAGE CAUSED DUE TO IMPROPER INSTALLATION.
- Installation requires moderate mechanical skills. A qualified mechanic is highly recommended.
- Do not attempt to install the intake system while the engine is hot.
- This installation may require removal of coolant lines that may be hot.
- For technical inquiries, please email us at tech@hpsperformanceproducts.com

PLEASE READ CAREFULLY BEFORE INSTALLATION!

This installation is not for the novice customer. Install this system with EXTREME caution! Misuse of this product can destroy your engine! If you are not mechanically inclined, please have a tuner shop install this kit.

NOTE: HPS holds no responsibility for any engine damage that results from the misuse of this product.

GETTING STARTED

1. Turn the ignition OFF and disconnect the vehicle's negative battery cable. If the engine has run within the past two hours, let it cool down.

NOTE: Disconnecting the negative battery cable erases pre-programmed electronic memories. Write down all memory settings before disconnecting the negative battery cable. Some radios will require an anti-theft code to be entered after the battery is reconnected. The anti-theft code is typically supplied with your owner's manual. In the event your vehicle's anti-theft code cannot be recovered, contact an authorized dealership to obtain your vehicle's anti-theft code. We also highly recommend NOT discarding any stock parts after the installation.

2. Removing the stock air inlet system

a) Disconnect the breather hose from the stock inlet piping and set aside as it will be used in the installation of the intake.

b) Remove the two hose clamps securing the stock inlet piping.

c) Disconnect the air flow sensor wire harness.

d) Disconnect and remove the stock inlet piping.

e) Remove the two plastic hold downs on the air inlet funnel.

f) Disconnect and remove the air inlet funnel from the stock air box.

g) Remove the bolt holding the stock air box to the mounting bracket.

h) Disconnect and remove the stock air box.

i) Remove the two bolts securing the mounting bracket to the body.

j) Remove the mounting bracket.

k) Remove the 4 nuts holding the air flow sensor to the stock air box.

l) Remove the air flow sensor and set aside as it will be used in the installation of the Intake.

i) Note: Be careful with the air flow sensor as it can be damaged easily. Set the air flow meter aside in a safe place.

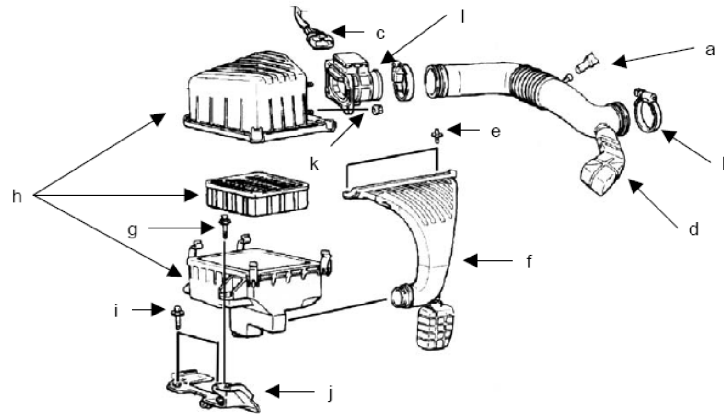

3. Installing cold air system

a) When installing the intake, DO NOT completely tighten the hose clamps, air flow sensor assembly or the mounting tab hardware until instructed to do so later in these instructions.

b) Install the black rubber elbow on the throttle body. The short side of the rubber elbow towards the throttle body and the long side towards the front of the vehicle. Install a 2 3/4" hose clamp on the throttle body end of the rubber elbow and snug it down.

c) There are two inlet pipes supplied with this kit, the primary and the secondary. The primary inlet pipe will be the pipe with the breather hose nipple. The secondary inlet pipe will be the pipe with the mounting bracket.

d) Install the end of the primary pipe closest to the breather nipple into the exposed end of the rubber elbow.

Install a 2 3/4" hose clamp onto the inlet pipe end of the rubber elbow and snug it down.

e) Install the black rubber reducer on the end of the exposed inlet pipe. The 2 3/4" towards the primary inlet pipe. Install a 2 3/4" hose clamp on the inlet pipe end of the rubber reducer and snug it down.

f) Assemble the air flow sensor and the air flow adaptor together using the supplied four bolts and nuts.

g) Slide the side of the air flow adaptor with the cut out in the back of it over the air flow sensor.

h) Install the four bolts from the air flow adaptor side and snug the nyloc nuts down on the air flow sensor side.

i) Install the airflow sensor into the rubber reducer. Install hose clamps on the sensor side of the rubber reducer and snug it down.

j) Install the black Connector Hose onto the Adaptor side of the air flow sensor. Install a hose clamp and snug it down.

k) Install the end of the secondary pipe closest to the bracket into the black rubber connector. Install a hose clamp and snug it down.

l) The support tab on the secondary inlet pipe will line up with a threaded hole on the inner fender well.

Install the rubber isolator mount and attach the air inlet tube onto the rubber mount. Install the large fender washer and the lock nut onto the isolator mount stud and snug it down. Failure to install the rubber mount will void all warranties of the Cold Air System. Below is a diagram of how the rubber mount should be installed.

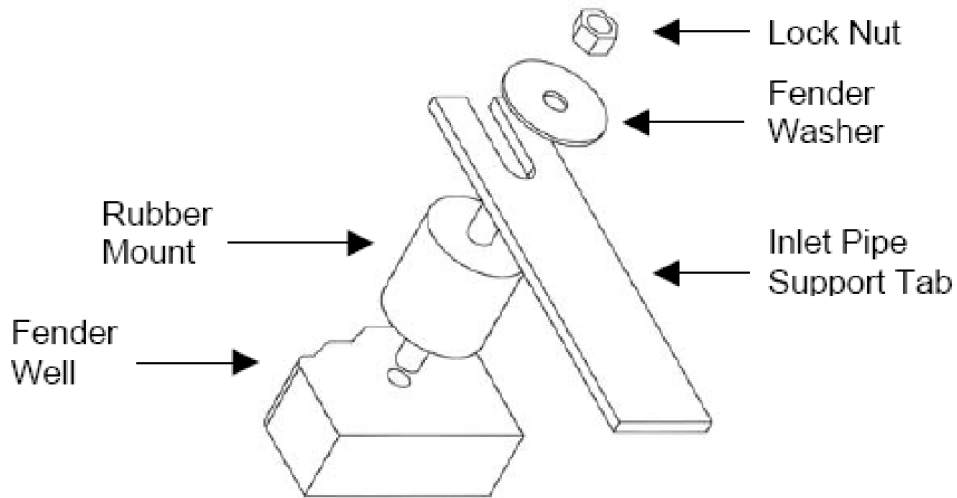

m) Install the filter on to the end of the inlet tube. Push the filter onto the inlet pipe and install one hose clamp to secure the filter on to the inlet pipe. Once fitment is checked, you can either push the filter on to the inlet pipe more or less depending on clearances. Tighten the hose clamp after this is done.

n) Note: This may require the removal of the inner fender liner to ease installation of the filter. If the liner or any other splashguard is removed, they must be re-installed. Failure to install the plastic splash guard will result in diminished performance and increase the potential for engine damage due to water ingestion in rainy conditions.

o) Connect the breather hose that was disconnected in step 2a to the primary inlet pipe nipple.

p) Connect the airflow sensor wire harness that was disconnected in step 2c to the airflow sensor.

Final Steps

Once the intake has been positioned, tighten all of the clamps and secure all of the parts.

Upon completion of the installation, reconnect the negative battery terminal before you start the engine. Double check to make sure everything is tight and properly positioned before starting the vehicle.

Start the engine. Let the car idle for 3 minutes. Perform a final inspection before driving. Listen carefully for any odd noises, rattles and/or air leaks prior to taking it for a test drive. If any problems arise go back and check the vacuum lines, hoses and clamps that may be causing leaks or rattles and correct the problem.

Periodically, recheck the alignment of the intake system and make sure there is proper clearance around and along the length of the intake. Failure to follow proper maintenance procedures may cause damage to the intake and will void the warranty.

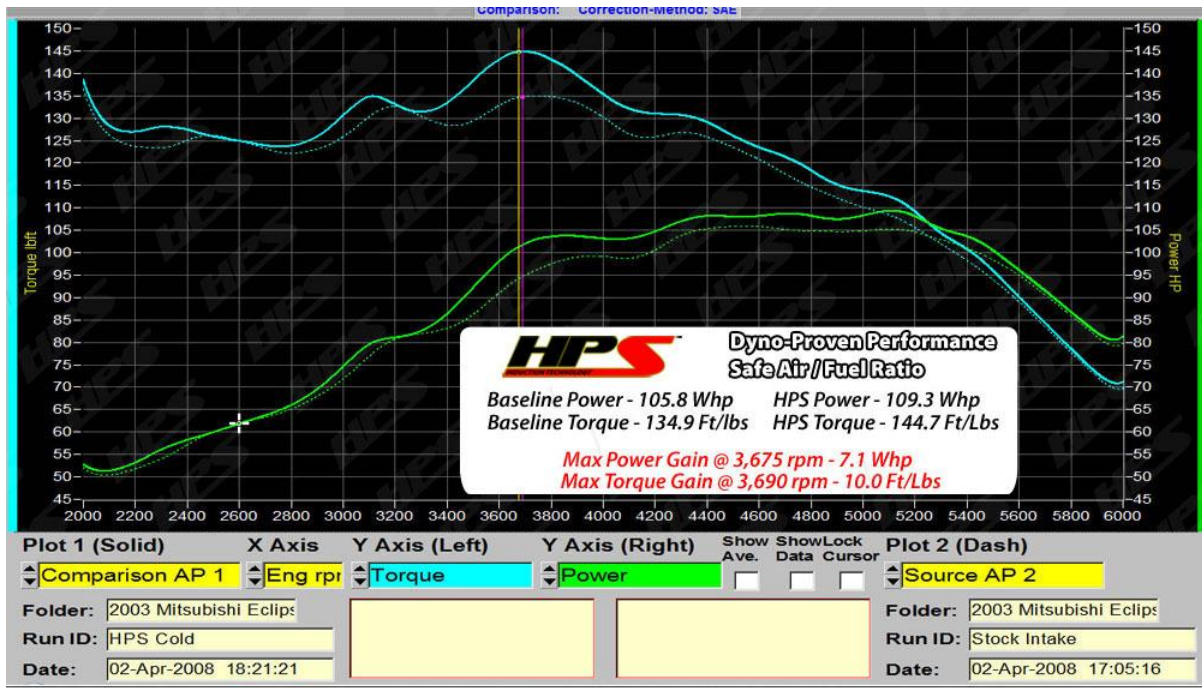

HPS PERFORMANCE PRODUCTS

Dynapack
CHASSIS DYNAMOMETERS

