



# **Performance Silicone Intake Tube**

## **Part Number: 57-1851**

**2020-2022 Toyota Supra 3.0L Turbo (B58)**  
**2020-2022 BMW Z4 M40i 3.0L Turbo (B58)**

## **Installation Instructions**

For technical inquiries please email us at [tech@hpsperformanceproducts.com](mailto:tech@hpsperformanceproducts.com)

In the email, please include the following information for faster response:

- Year / Make / Model / Engine of your vehicle.
- If it is a fitment issue, please include pictures showing the fitment problem.
- If there are missing parts, please list the part number(s) from the bill of materials on the 2nd page.
- Optional but recommended – Your contact phone number and preferred call back time.

You can also give us a call via 626-747-9200 for tech support Monday-Friday, 9:00am-5:00pm Pacific Time.

# Bill of Materials

## Kit Number: 57-1851

Description	Prep	Part Number	Qty	Check
Silicone Intake Tube	1	57-1851	1	
Turbo Quick Connect	2	CNC-QC-MK520	1	
Breather Quick Connect Barb	2	CNC-BARB-57-1851	1	
Embossed Clamp for Breather Connect	2	EMSC-20-32	1	
Embossed Clamp for 3.00"	2	EMSC-70-90	1	
Embossed Clamp for 3.50"	2	EMSC-90-110	1	

- Report any defective or missing parts directly to HPS Performance Products.
- Before installing any parts of this system, please read the instructions thoroughly.
- Installation DOES require some mechanical skills. A qualified mechanic is always recommended.
- Do not attempt to install the intake system while the engine is hot.
- The installation may require removal of radiator fluid lines that may be hot.
- For technical inquiries, please email us at [tech@hpsperformanceproducts.com](mailto:tech@hpsperformanceproducts.com)

### **PLEASE READ CAREFULLY BEFORE INSTALLATION!**

This installation is not for the novice customer. Install this product with EXTREME caution! Misuse of this product can destroy your engine! If you are not mechanically inclined, please have a professional automotive mechanic install this kit.

***NOTE: HPS holds no responsibility for any engine damage that results from misuse of this product.***

### **GETTING STARTED**

1. Turn the ignition OFF and disconnect the vehicle's negative battery cable. If the engine has run within the past two hours let it cool down.

NOTE: Disconnecting the negative battery cable erases pre-programmed electronic memories. Write down all memory settings before disconnecting the negative battery cable. Some radios will require an anti-theft code to be entered after the battery is reconnected. The anti-theft code is typically supplied with your owner's manual. In the event your vehicles' anti-theft code cannot be recovered, contact an authorized dealership to obtain your vehicles anti-theft code. We also highly recommend NOT discarding any stock parts after the installation.

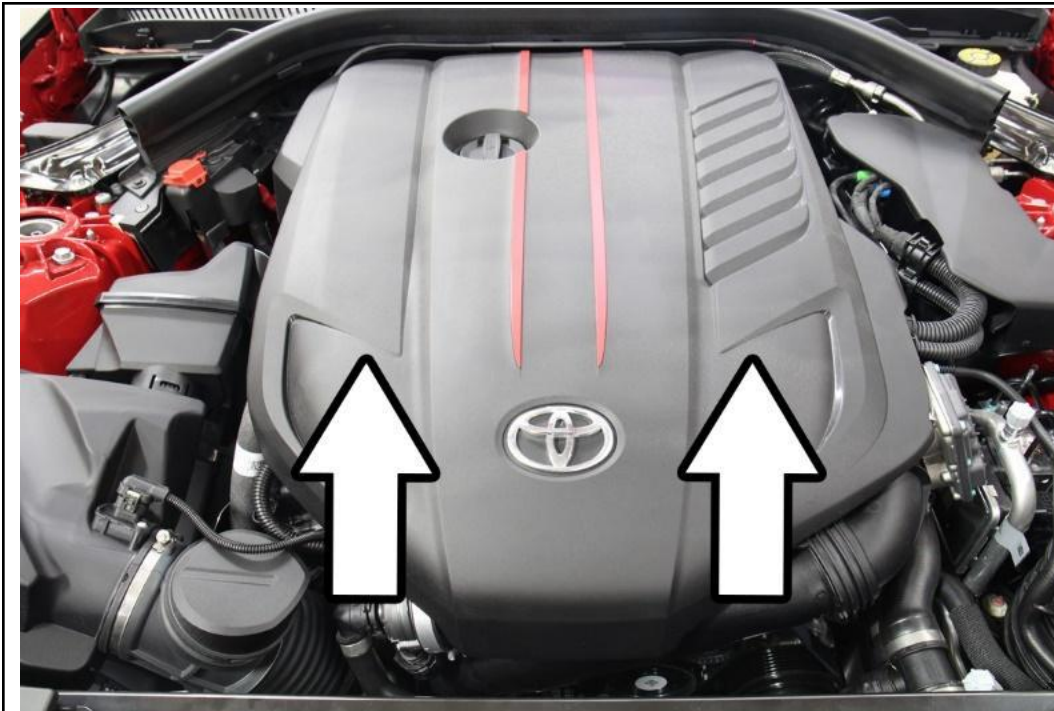

2A. Lift and remove the engine cover from the vehicle.

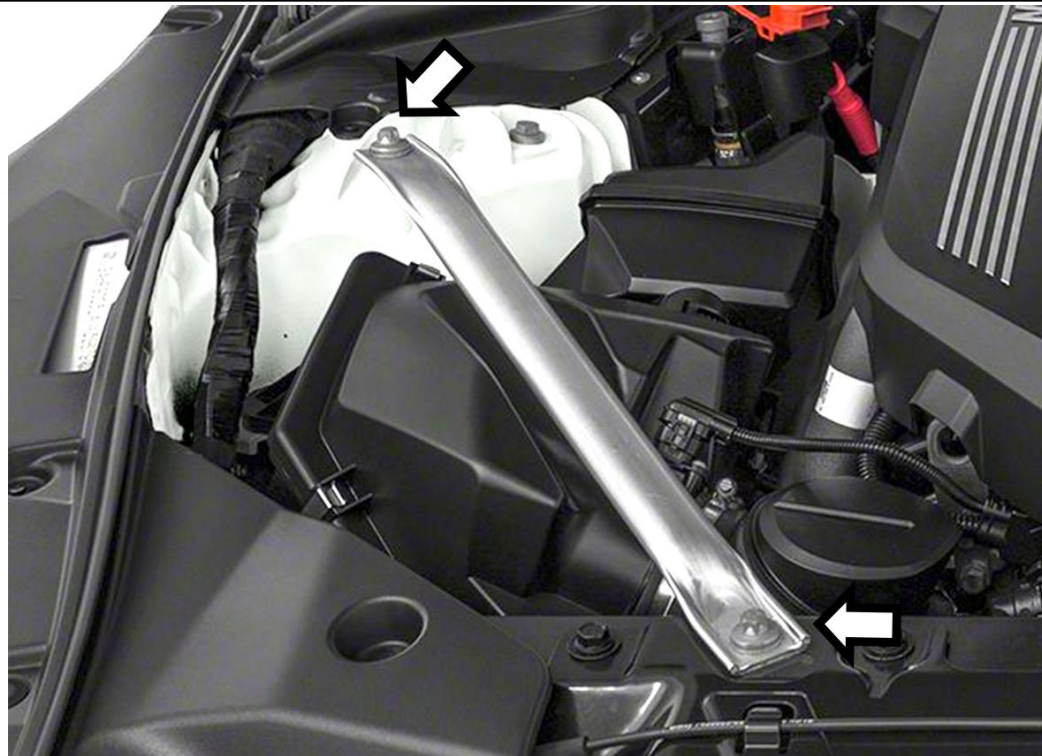

2B. For BMW Z4 only, use a E12 socket to remove the strut tower brace before proceeding.



3. Disconnect the temperature electrical harness clip from the temperature sensor.

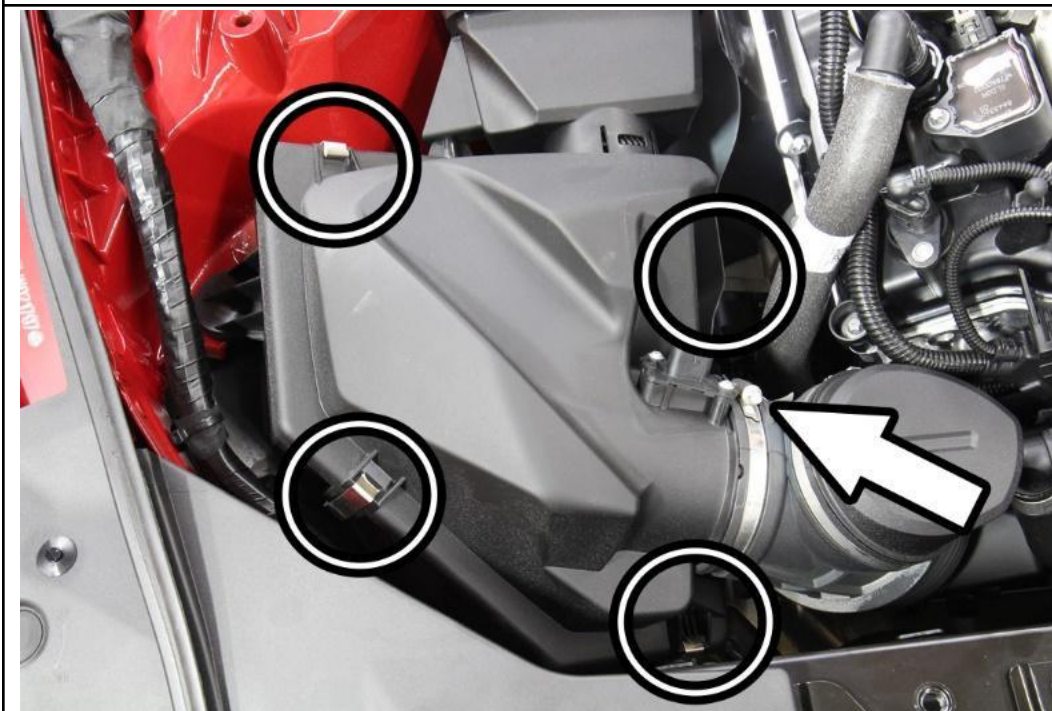

4. Disconnect the four retaining clips securing the upper air box assembly. Loosen the hose clamp securing the intake tube from the air box.



5. Disconnect the intake tube from the upper air box assembly and remove it from the vehicle.

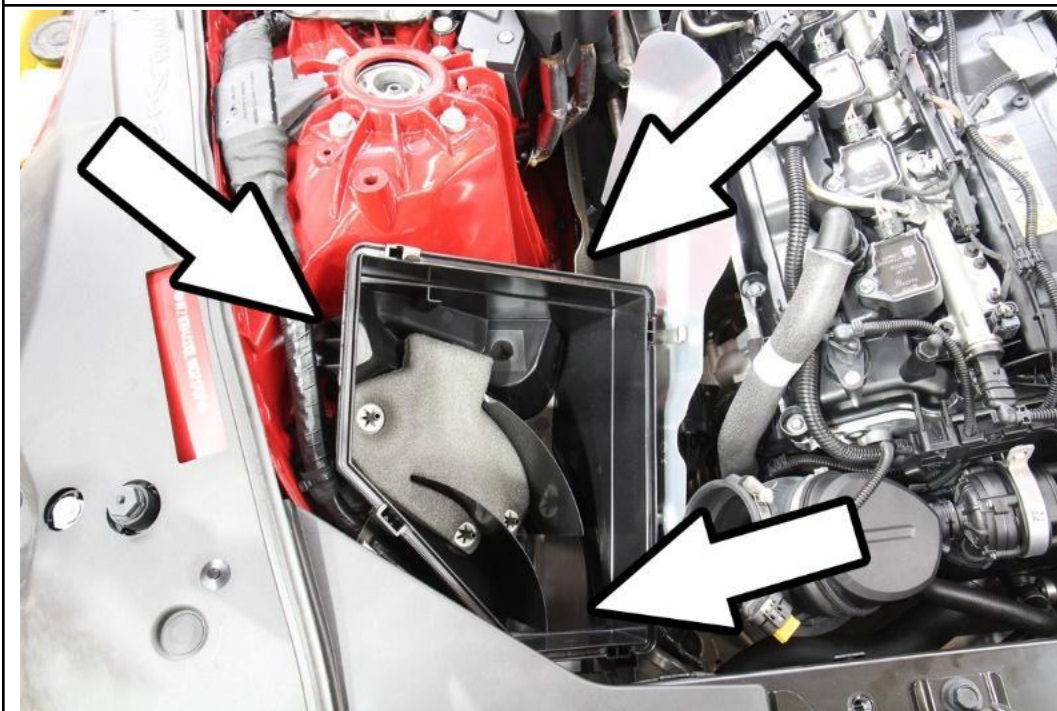

6. Lift and disconnect the lower air box assembly from its grommets.



7. Remove the lower air box from the vehicle.

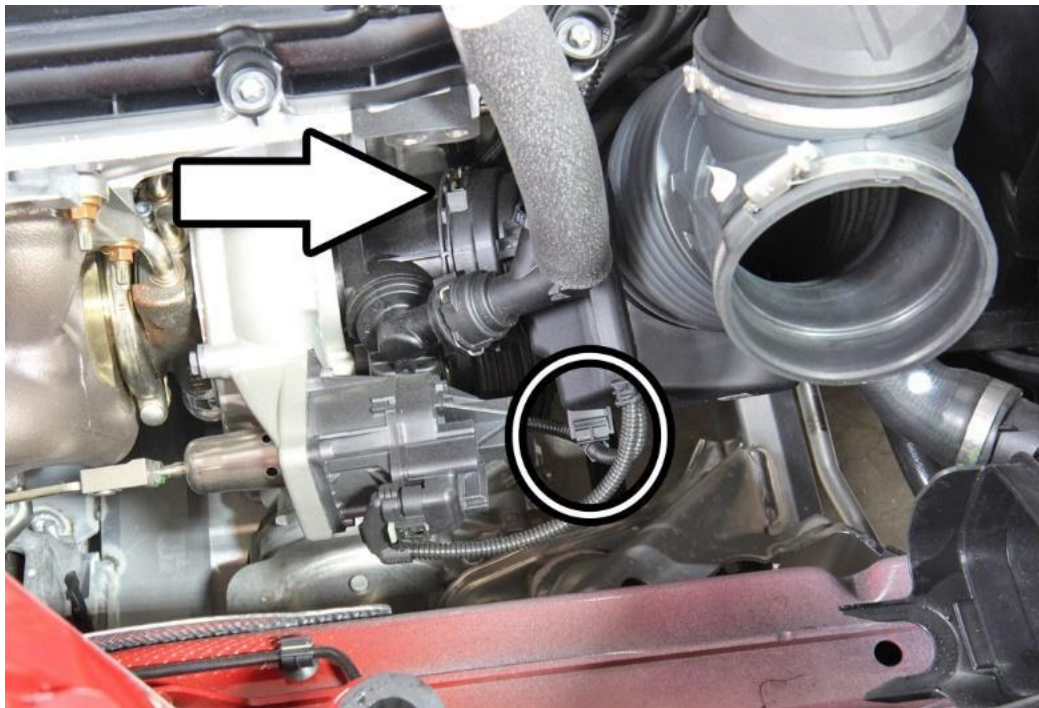

8. Disconnect the electrical harness from the intake tube. Using a flat head, push the retaining clip down to release the intake tube from the turbo inlet.



9. Disconnect the crankcase breather line from the intake tube.



10. Remove the intake tube from the vehicle.



11. Remove the factory O-ring and the retaining clip from the intake tube and insert them into the provided turbo connector fitting.

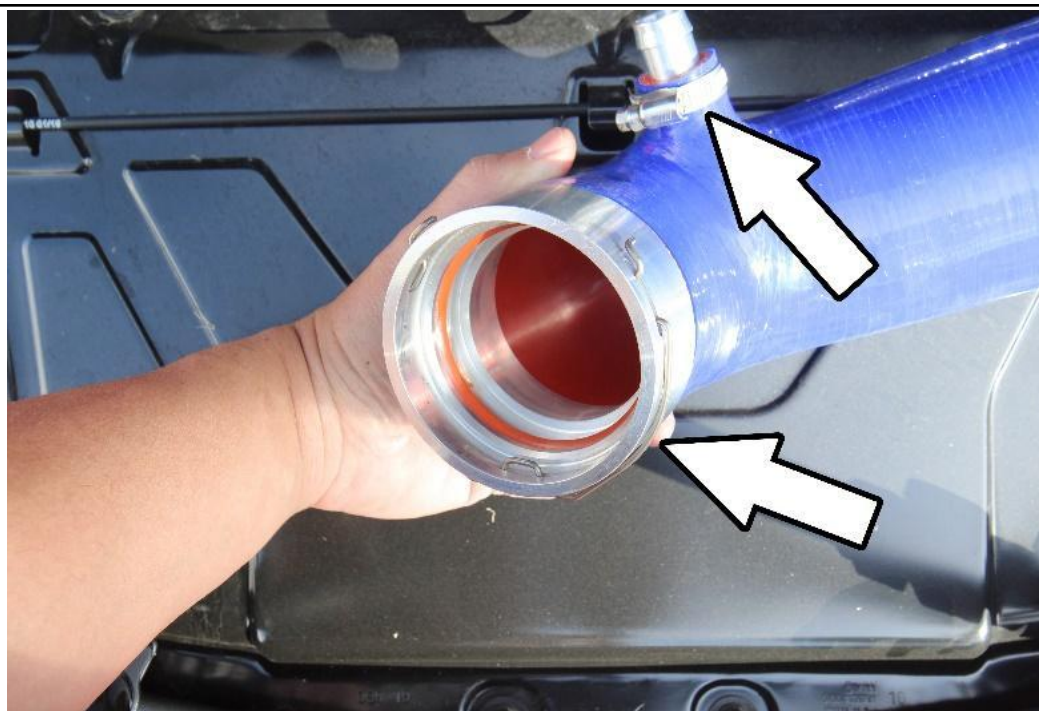

12. Transfer the factory retaining clip onto the HPS quick connect and secure the turbo connector fitting onto the HPS silicone intake tube using the provided EMSC-70-90 clamp. Insert and secure the breather barb onto the silicone tube using the EMSC-20-32 clamp.





13. Install the HPS silicone intake tube onto the turbo inlet until the retaining clip snaps into place. Reconnect the breather quick connect onto the barb.



14. Insert the lower air box assembly and air filter back into the vehicle.



15. Insert the upper air box into the HPS silicone intake tube and secure the upper air box back onto the lower air box assembly. Reconnect the electrical harness connector back onto the temperature sensor.

### **Final Steps**

Once the intake has been positioned, tighten all of the clamps and secure all of the parts. Reinstall strut tower brace (Z4 only).

Upon completion of the installation, reconnect the negative battery terminal before you start the engine. Double check to make sure everything is tight and properly positioned before starting the vehicle.

Start the engine. Let the car idle for 3 minutes. Perform a final inspection before driving. Listen carefully for any odd noises, rattles and/or air leaks prior to taking it for a test drive. If any problems arise go back and check the vacuum lines, hoses and clamps that may be causing leaks or rattles and correct the problem.

Periodically, recheck the alignment of the intake system and make sure there is proper clearance around and along the length of the intake. Failure to follow proper maintenance procedures may cause damage to the intake and will void the warranty.



HPS Performance Silicone Air Intake Tube  
2020-2022 Toyota Supra 3.0T  
Part Number: 57-1851

Maximum Torque Gains = 8.1 ft/lb @ 5000 rpm

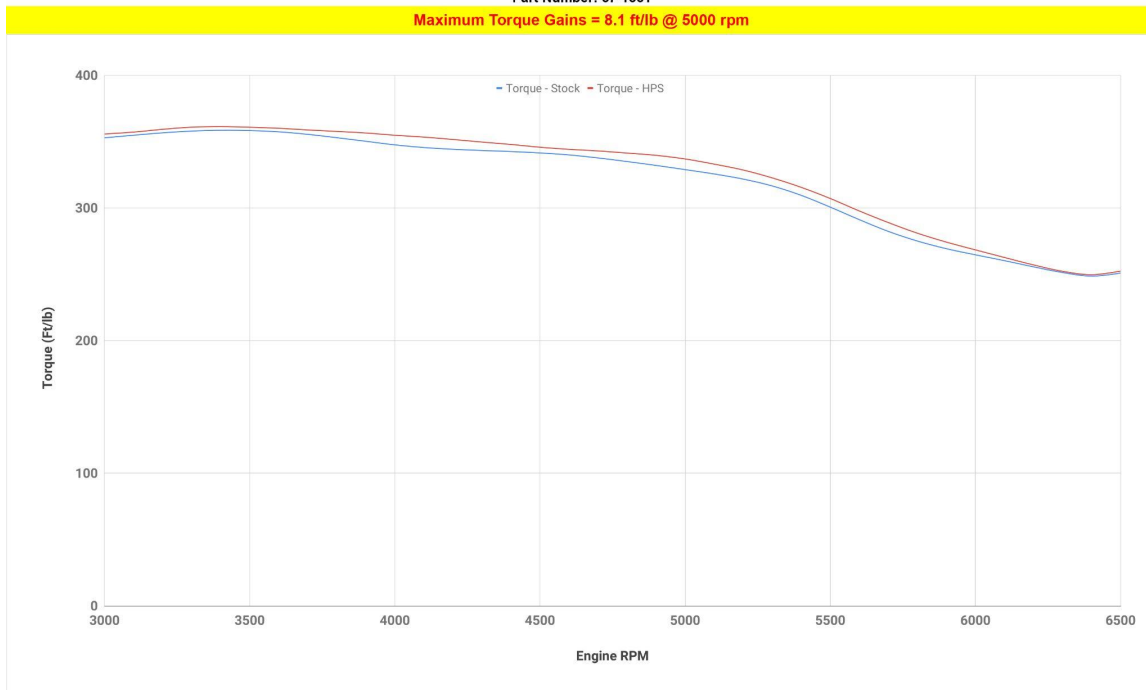

HPS Performance Silicone Air Intake Tube  
2020-2022 Toyota Supra 3.0T  
Part Number: 57-1851

Maximum Horsepower Gains = 7.7 whp @ 5000 rpm

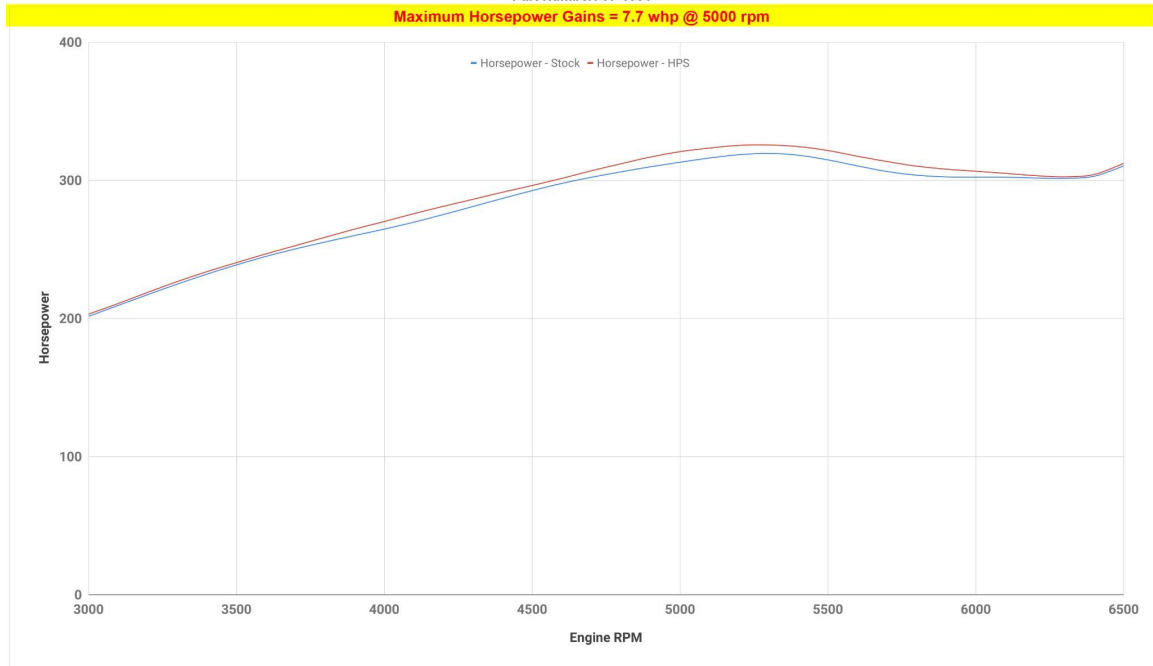

**Also available for:**

**2020-2022 Toyota Supra 3.0L Turbo (B58)**

**2020-2022 BMW Z4 M40i 3.0L Turbo (B58)**

**HPS Drop In Panel Air Filter**

**[Part Number HPS-457371](#)**



**HPS Titanium Coolant Bleed Screw**

**[Part Number HW22-1001](#)**



**Contact an authorized HPS Performance Products dealer or visit us at  
[www.hpsperformanceproducts.com](http://www.hpsperformanceproducts.com) for more details.**