

# Model 840

## TURBO COMPRESSOR & EXTENDED TANK SYSTEM

Your purchase of a Wolo Turbo Compressor & Extended Tank System is a perfect choice to power your high-pressure air horns. The Wolo name, with more than twenty years experience, is your guarantee of a superior horn product. If you need help installing this product, our technicians are available to answer your questions, Monday through Friday from 9 AM to 4 PM EST by calling 1-888-550-HORN (4676).

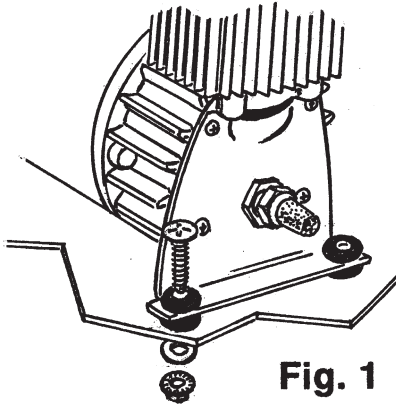

Fig. 1

### COMPRESSOR INSTALLATION:

1. Locate an area in the engine compartment that is dry and safe from the heat of the exhaust manifold heat. Try to mount compressor as far to the front of vehicle as possible to provide a good airflow around compressor. **IMPORTANT!** Do not mount on fender well or other flexible material.
2. Using the compressors mounting brackets as a template, mark the hole locations and drill to size 13/64". Secure the compressor to the mounting surface with the hardware provided. (Fig 1.)

### TANK INSTALLATION:

3. Locate a convenient area in the vehicle to mount the air storage tank. **IMPORTANT!** When selecting a mounting location for the tank, make sure that the compressor metal braided hose is close enough to connect to the tanks brass female fitting.
4. Use the tanks mounting bracket as a template, mark the hole locations and drill to size 15/64". Secure tank with hardware provided using the rubber gasket to prevent vibration noise. (Fig.2.)

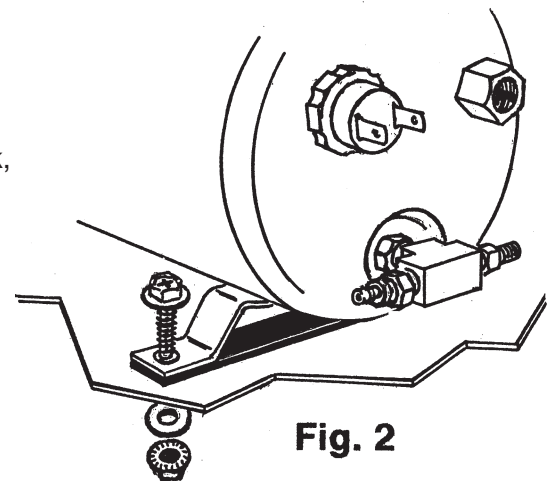

Fig. 2

### HOSE INSTALLATION:

5. Connect the metal braided hose from the compressor to tanks female brass inlet fitting. (Fig 3).
6. Using the plastic hose provided, cut to size to connect the tank to the horn's lanyard or solenoid valve. Place the brass-fitting nut onto the plastic hose. Push the hose onto the tanks male fitting. Tighten the brass nut onto outlet fitting. **CAUTION:** Do not over tighten fittings. (Fig 4.)

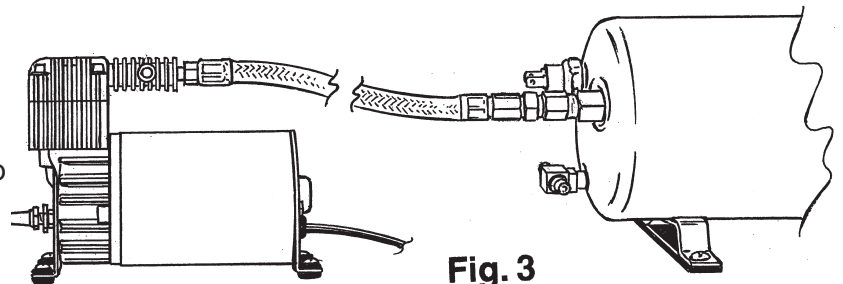

Fig. 3

7. Connect other end of plastic hose to horn lanyard or solenoid valve.

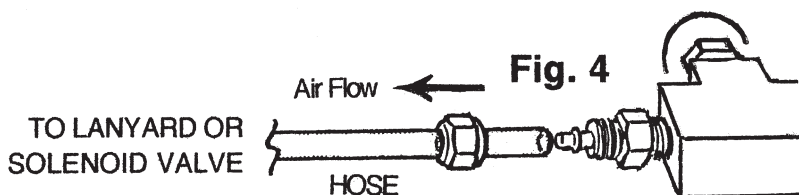

Fig. 4

### WIRING COMPRESSOR:

8. The compressor's red wire is connected to (+) 12-volt power source using the fuse provided.

**IMPORTANT!** The red wire must be connected to a (+) 12-volt power source only when the vehicle ignition is turned on. This will protect your compressor from running continuously and being damaged if an air leak develops

when the vehicle is not in operation. Suggested connection points are: blower motor, windshield wiper motor or accessory terminal on the fuse panel. Make sure the connection point has a wire that is as heavy as the compressor wire. (Fig. 5).

**OPTIONAL:** A switch can be installed into the compressor's red wire. This will permit the driver to turn-off the system if it is not required.

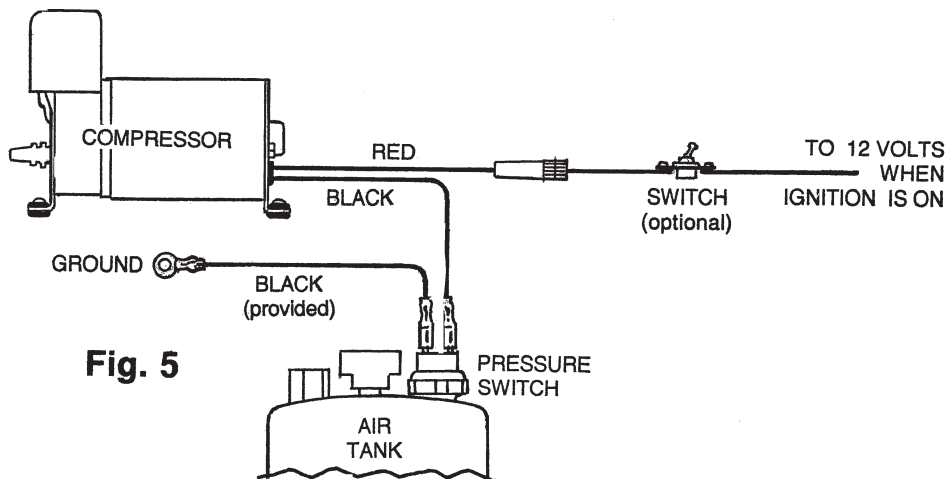

**Fig. 5**

9. Remove the plastic cap covering the pressure switch. The compressor's black wire is connected to one of the terminals of the pressure switch on air tank. (Fig 5).

10. Connect the short black length of wire provided to the other terminal of the pressure switch.

11. The other end of the black wire is connected to ground; secure the wire's terminal to either the (-) side of vehicles battery or under any metal body bolt. Make sure that ground connection is free of rust and paint. (Fig. 5.)

**NOTE:** The compressor is now ready to be used and will automatically start when the pressure drops in the tank. The built-in regulator will automatically turn off the compressor when the tank pressure is approximately 110 p.s.i. If the compressor does not shut off after 4 minutes of running time, check all air hose connections for leaks. Use soapy water or bubble solution on each fitting while the compressor is pumping. Use a thread sealant if leak persists after tightening.

**CAUTION:** Do not touch compressor or fittings with bare hands during or immediately after usage, they will be hot.

**IMPORTANT!** Compressor is equipped with THERMAL OVERLOAD PROTECTOR. If unit should shut off automatically during operation, do not attempt to restart compressor. Allow compressor to cool off for approximately 40 minutes before resuming use.

## WARRANTY

Wolo Manufacturing Corporation ("Wolo") warranties to the original purchaser, for three months from the date of purchase, that this product is free from defects in workmanship and materials. If there is such a proven defect, Wolo, at its option, will either repair or replace the item free of charge, if it is returned to Wolo within three months from the date of purchase together with proof of purchase as described below. Wolo reserves the right to inspect any defect prior to settling any warranty claim by repair or replacement. This warranty is limited as above provided and Wolo will not be responsible for fire or other casualty or accident, due to neglect, abuse, abnormal use, modifications, faulty installation of this product, or natural causes.

ANY EXPRESSED WARRANTY NOT PROVIDED HEREIN IS EXCLUDED AND DISCLAIMED. THE IMPLIED WARRANTIES OF MERCHANTABILITY AND OF FITNESS FOR A PARTICULAR PURPOSE ARE EXPRESSLY LIMITED TO A TERM OF THREE (3) MONTHS. UNDER NO CIRCUMSTANCES SHALL WOLO BE LIABLE TO PURCHASER OR ANY OTHER PERSON FOR ANY SPECIAL OR CONSEQUENTIAL DAMAGES, WHETHER ARISING OUT OF BREACH OF WARRANTY OR OTHERWISE.

To obtain warranty service, return the product prepaid, and include the original bill of sale showing the date of purchase. Provide with the return a brief description of the problem. Also, include with the return a check or money order in the amount of \$20.00 to cover return shipping. Mail to:

**Wolo Manufacturing Corp. • One Saxwood Street, Deer Park, NY 11729**

**Attn: Warranty Service  
E-mail: tech@wolo-mfg.com**