

# INSTALLATION INSTRUCTIONS

# **EGR *ROLLTRAC***

## MANUAL

**Vehicle Model: Ford F-150 5.5Ft Bed RHD&LHD - Compatible with Boxlink®**  
**Year of manufacture: 2018 onwards**

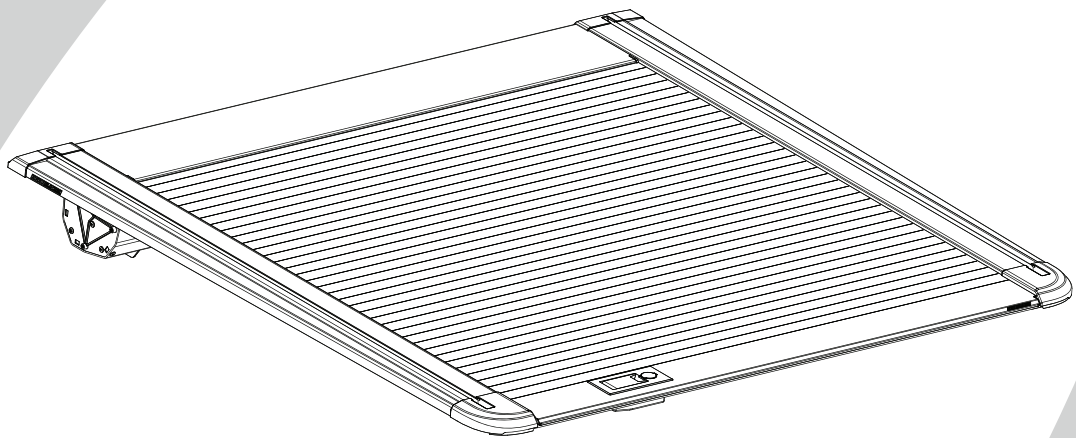

Installation time: 120 minutes

\* Image shows LHD version, handle location may vary

### Caution

- Do not attach EGR RollTrac in a location or by a method not specified.
- Do not use this product for any vehicle make or model, other than those specified in this document.
- Do not remove the plaque or label from this product.
- Do not modify the structure of the EGR RollTrac in any way.

### General Notes

- Read through the fitting instructions before installation of EGR RollTrac.
- Always install the accessory following the fitting instructions. Failure to do so may cause damage to the vehicle or the accessory.
- Ensure all recyclable discarded vehicle accessory components and packaging are recycled following local recycling regulations.
- It is always recommended that this accessory is fitted by a qualified Technician.
- Safely store and protect any removed vehicle components.
- Ensure all bare metal surfaces are protected using Automotive Bare Metal Primer and touch-up paint.
- Remove all metal swarf and dust from all vehicle surfaces if surface is used for accessory installation.



### Safety Notes

- Check that all work practices comply with safety standards.
- Please wear appropriate clothing and use safety equipment.



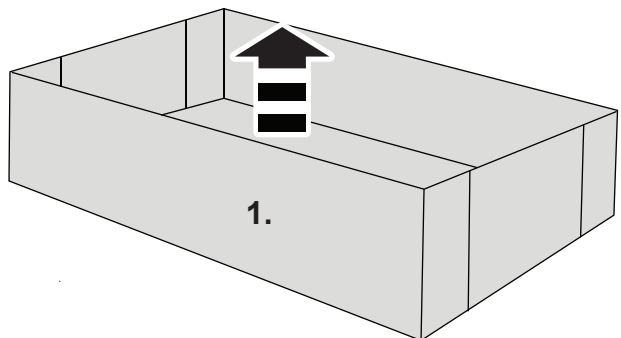
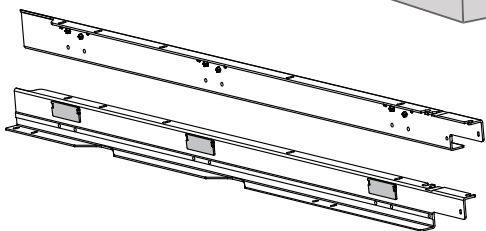
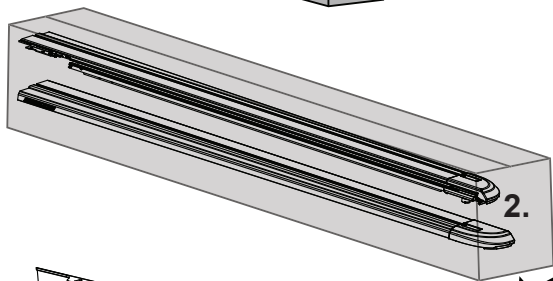
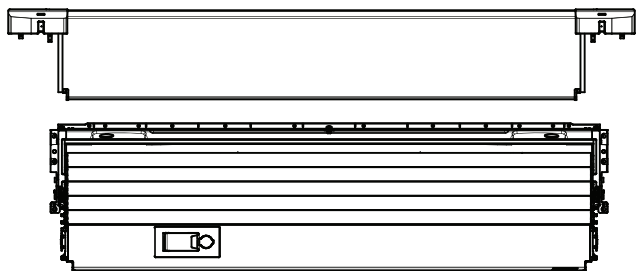
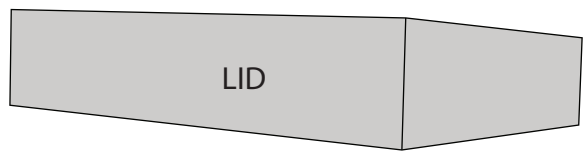
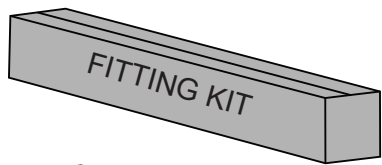
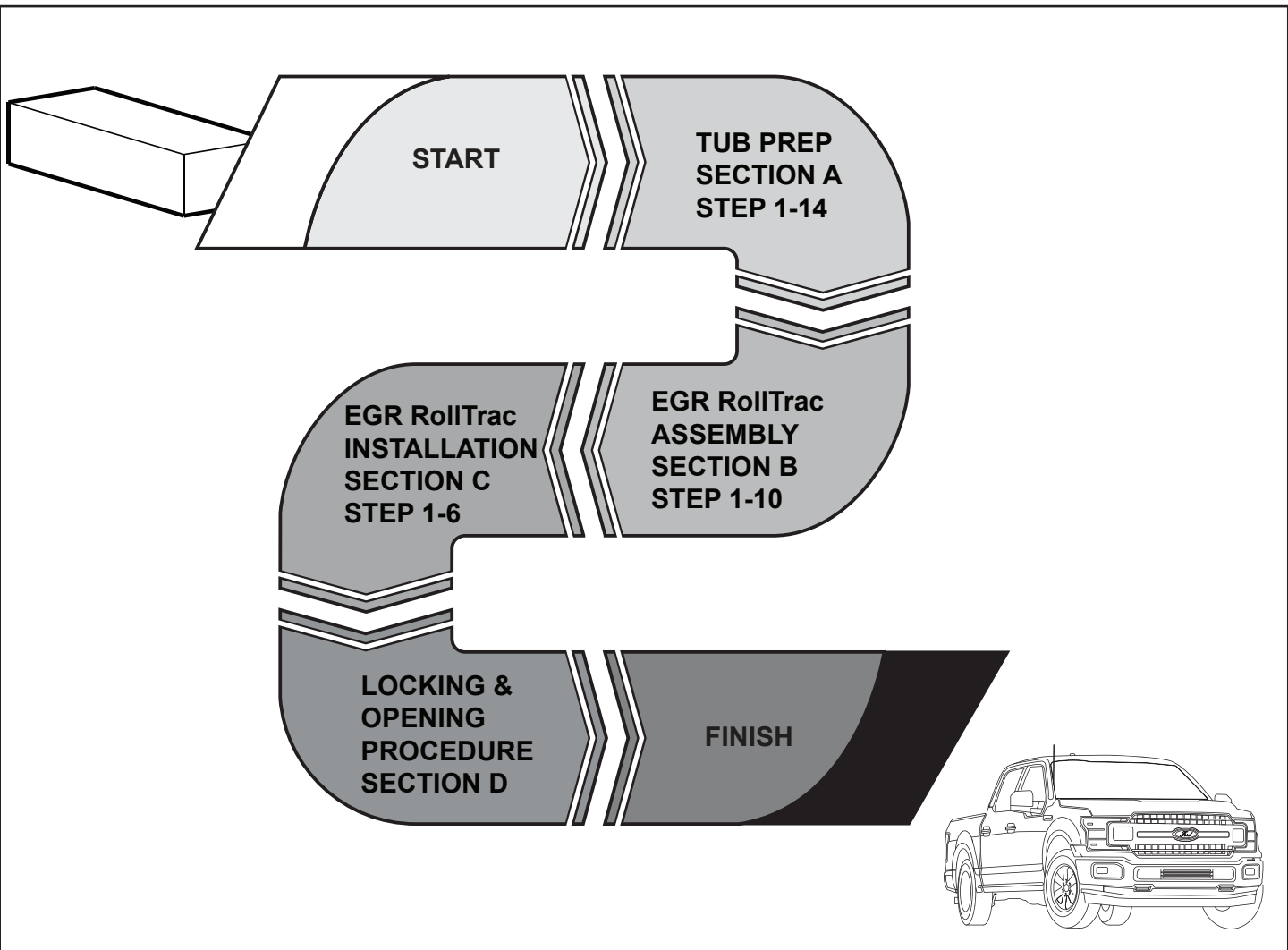

## KIT CONTENTS - COMPONENT NUMBER AND QUANTITY

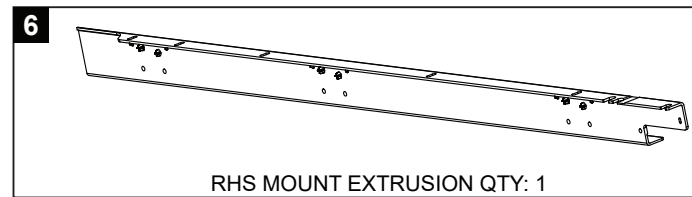
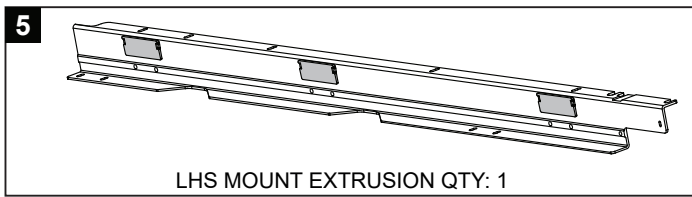
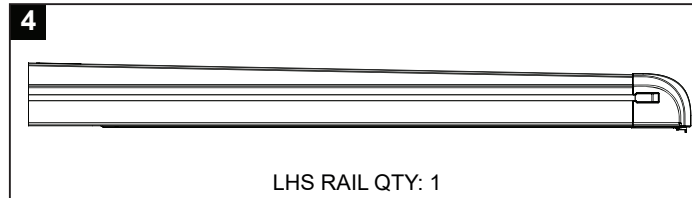
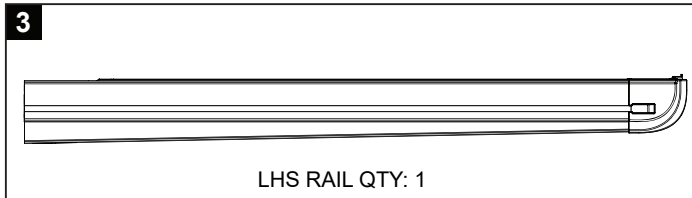
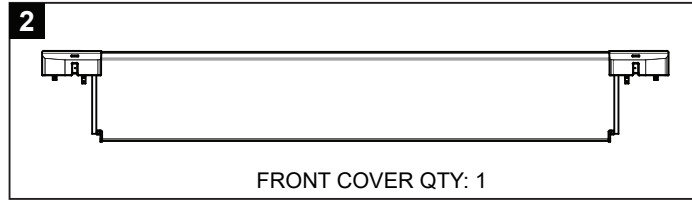
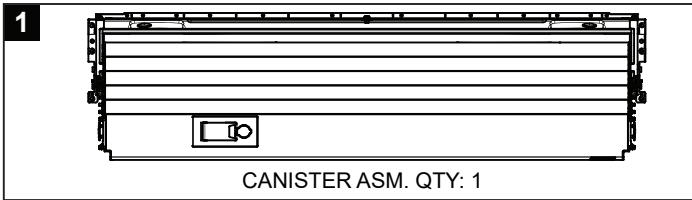

### EGR RollTrac M-Bar Assy Hardware Kit

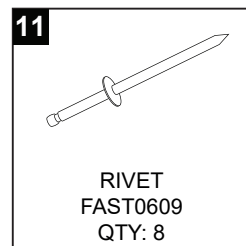
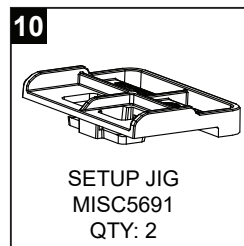
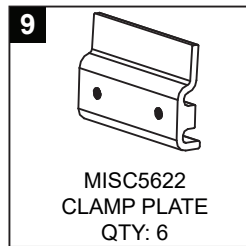
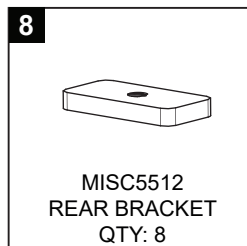
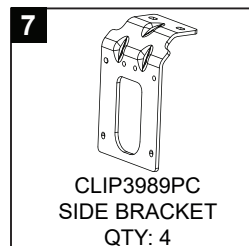

### EGR RollTrac FITTING KIT IN BOX

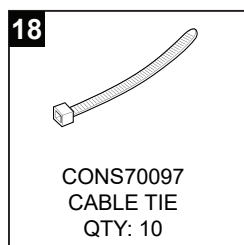
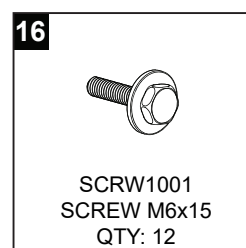
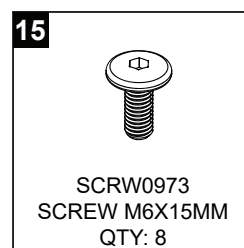
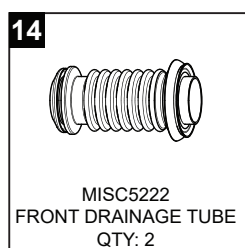
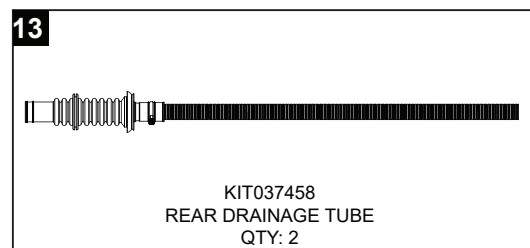

## EGR RollTrac FITTING KIT ADDITIONAL ITEMS

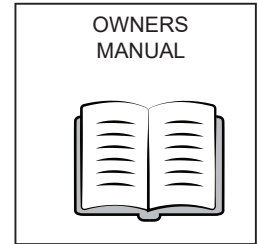
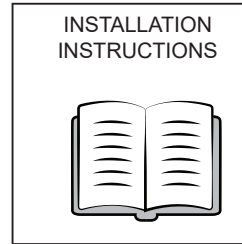
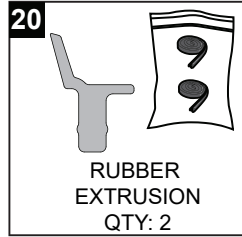
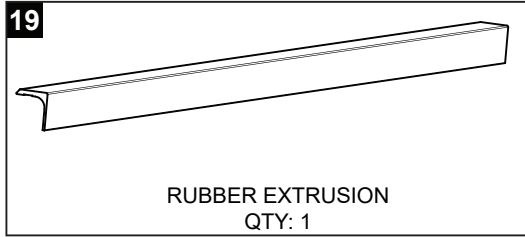

### TOOLS REQUIRED - NOT SUPPLIED IN KIT

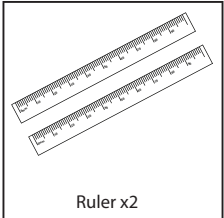
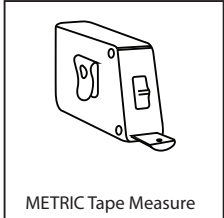
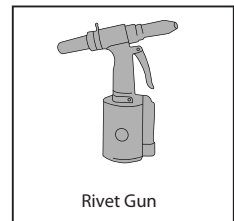
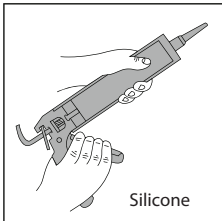
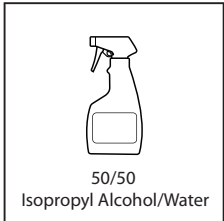
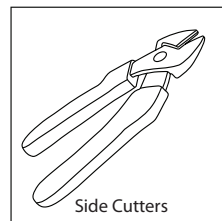
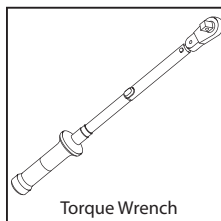
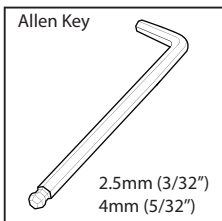
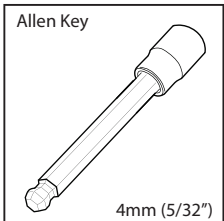
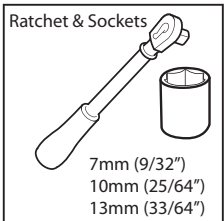
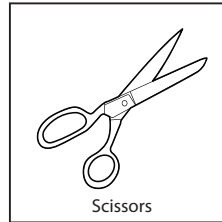
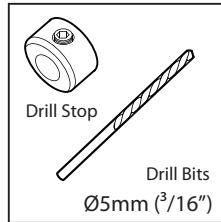
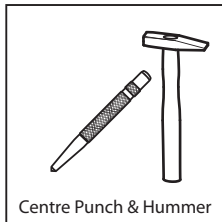
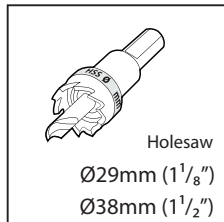
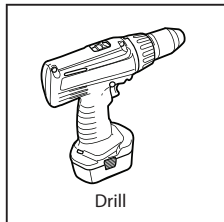

3M Primer 94  
(preferred) or  
equivalent

#### GLOSSARY:

- 1** Number inside a square indicate part number
- 1** Number inside circle indicate the sequence within a step
- 1** Number inside the hexagon indicate torque instruction

# SECTION A

# BED PREPARATION

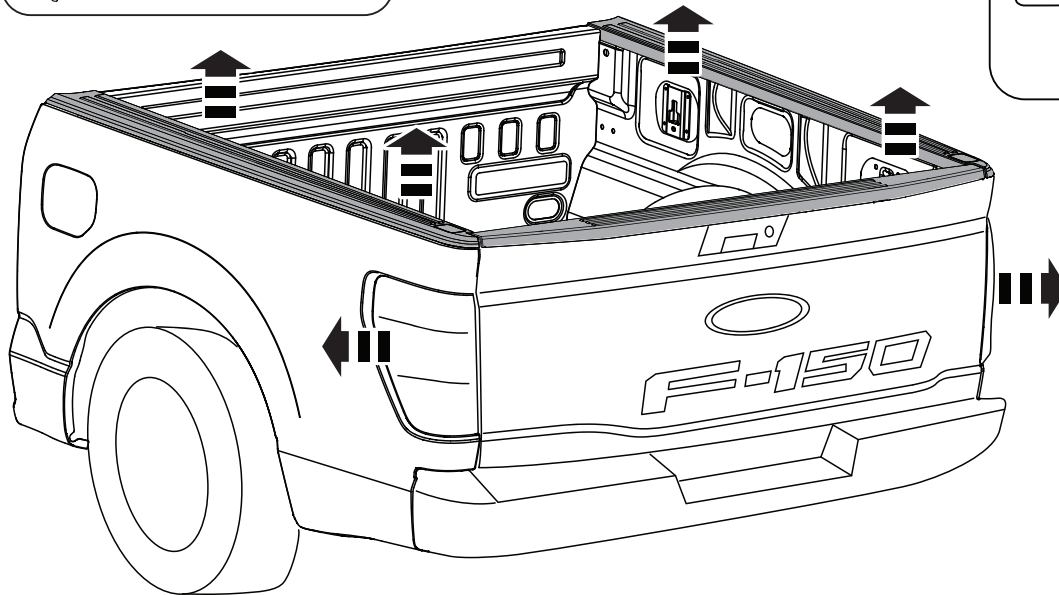
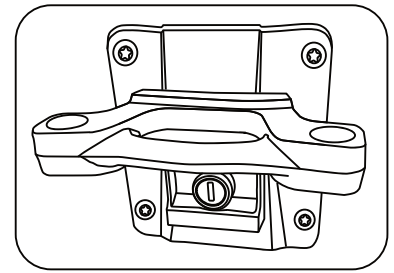
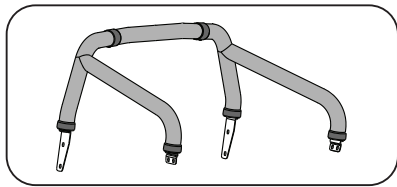

**1** Carefully remove any accessories (Sports Bars, Cabin Guards, etc.) attached to the bed of the vehicle. Thoroughly wash the vehicle and bed and ensure that all dirt and grease is removed. Allow to dry. Clean the top surfaces of the bed and tailgate and allow to dry. Carefully remove both Rear Tail Lamps with the appropriate tools and store in safe place. Retain all hardware for re-installation. **IMPORTANT:** Remove and retain Tie Down Hooks with mounting plates. Discard the screws.

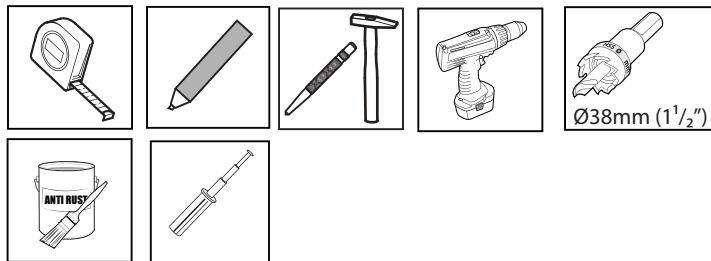

## HOLES FOR FRONT DRAIN TUBES RHS & LHS



**ATTENTION** Ensure that the diameter of the hole does not exceed  $\text{Ø}38\text{mm}$  ( $1\frac{1}{2}''$ ). Larger hole size will lead to water ingress into the bed

### INSTALL FRONT DRAIN TUBES TO BED

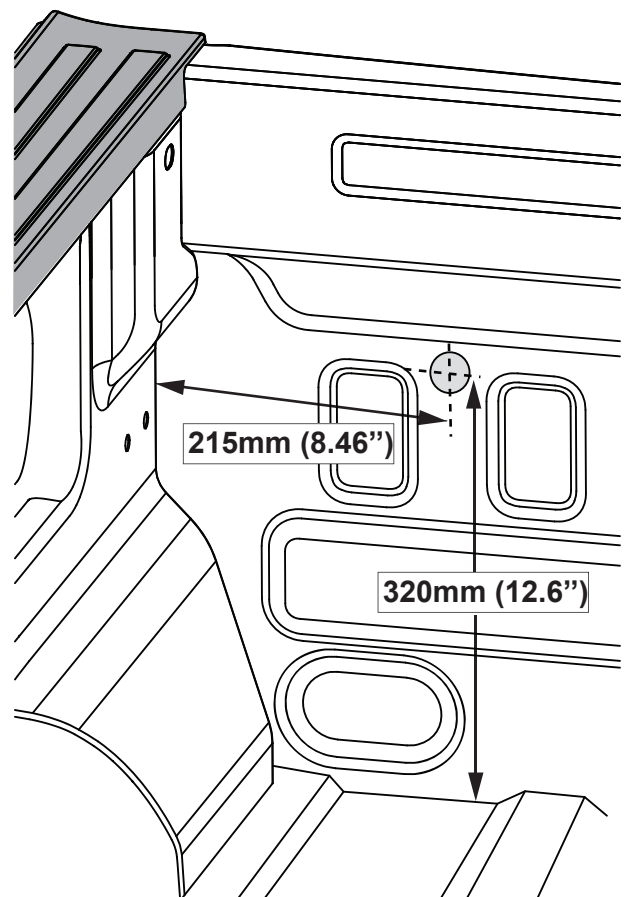
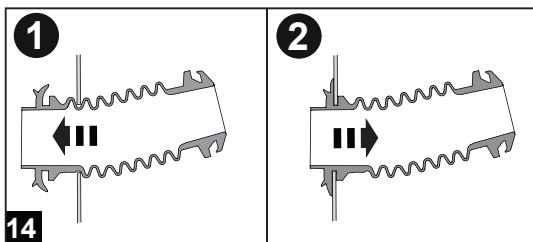

**2** Mark the position of the front drain tubes holes in the bed front panel and drill with  $\text{Ø}38\text{mm}$  ( $1\frac{1}{2}''$ ) holesaw. LHS shown, repeat on the RHS. Clean all burrs and coat the exposed metal with a suitable rust preventative (not supplied). Fit front drain tubes (14).

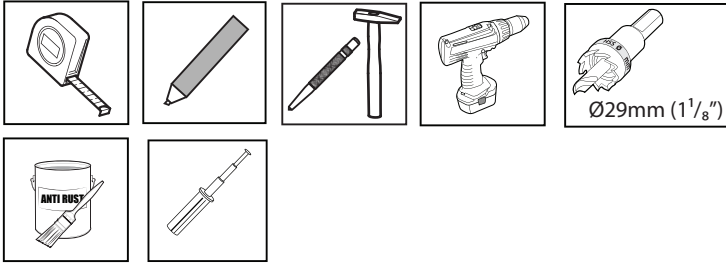

## HOLES FOR REAR DRAIN TUBES RHS & LHS



**ATTENTION** Ensure that the diameter of the hole does not exceed  $\varnothing 29\text{mm}$  ( $1\frac{1}{8}''$ ). Larger hole size will lead to water ingress into the bed

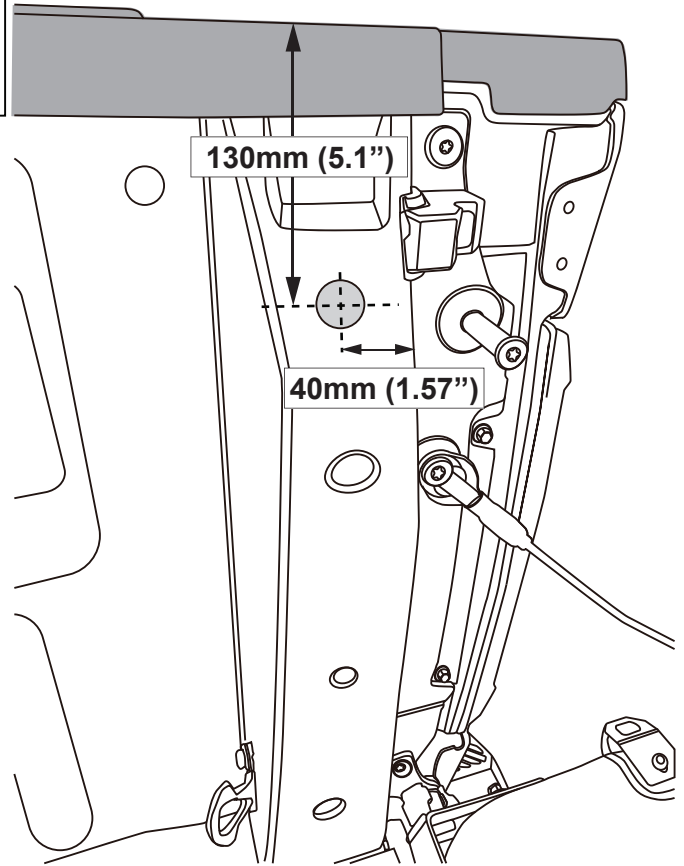

- 3** Mark the position of the rear drain tubes holes in the bed rear panel and drill with  $\varnothing 29\text{mm}$  ( $1\frac{1}{8}''$ ) holesaw. LHS shown, repeat on the RHS. Clean all burrs and coat the exposed metal with a suitable rust preventative (not supplied).

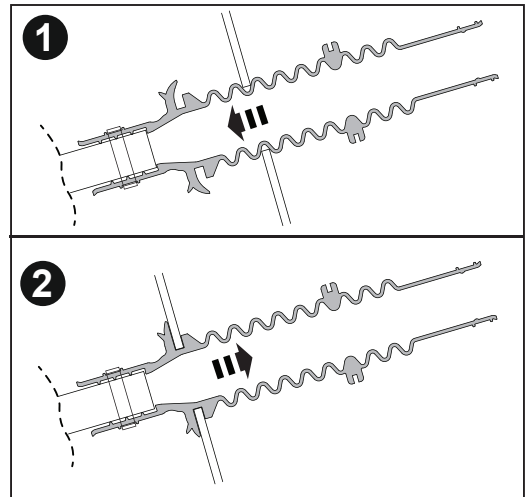
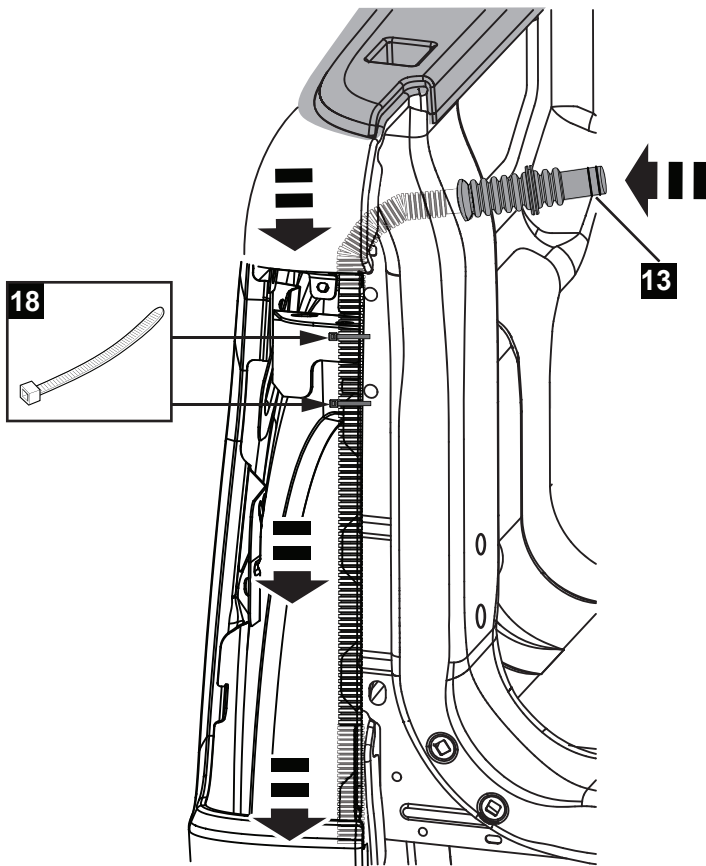

- 4** Feed the rear drain tube into the drilled hole. Guide the plastic tube inside the tail light cavity towards the ground. Push the rubber tube in until it sits firmly in the hole as shown. Secure the drain tube (13) to the existing harness inside the tail light cavity using 2 cable ties (18). Refit Rear Tail Lamps.

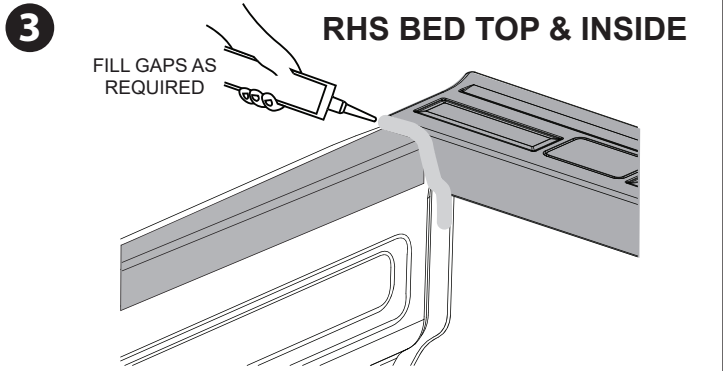
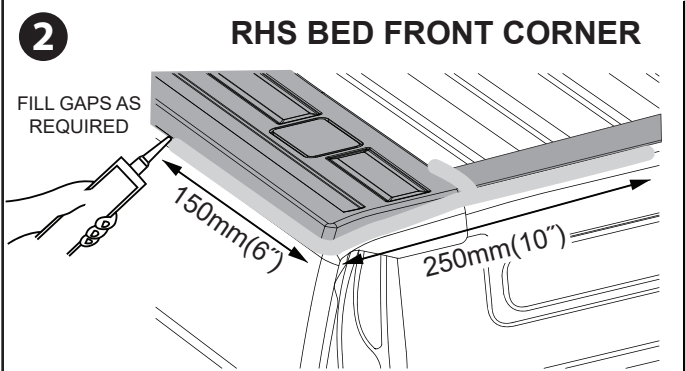
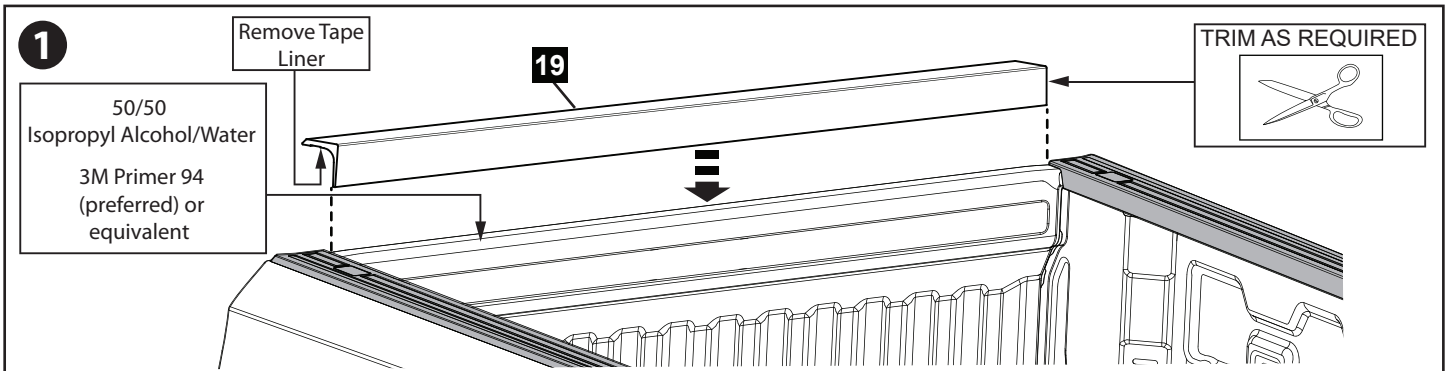

**5** Clean the front top of the bed using Isopropyl Alcohol/Water mix and apply primer to the top area. Allow to dry. Place the extrusion (19) on front of the vehicle bed, check the length and trim to full width if required. Pre-peel 50mm (2") of the tape liner from one end of the Rubber Extrusion (19). Place the Rubber Extrusion on top of the bed as shown and centralise. Once in position, peel the liner and apply firm pressure from the top. Silicone the gap between the panels as shown on both sides. NOTE: Holes in the bed should be sealed with Silicone to prevent dust and water ingress as required.

**RHS MOUNT EXTRUSION ASSEMBLY**

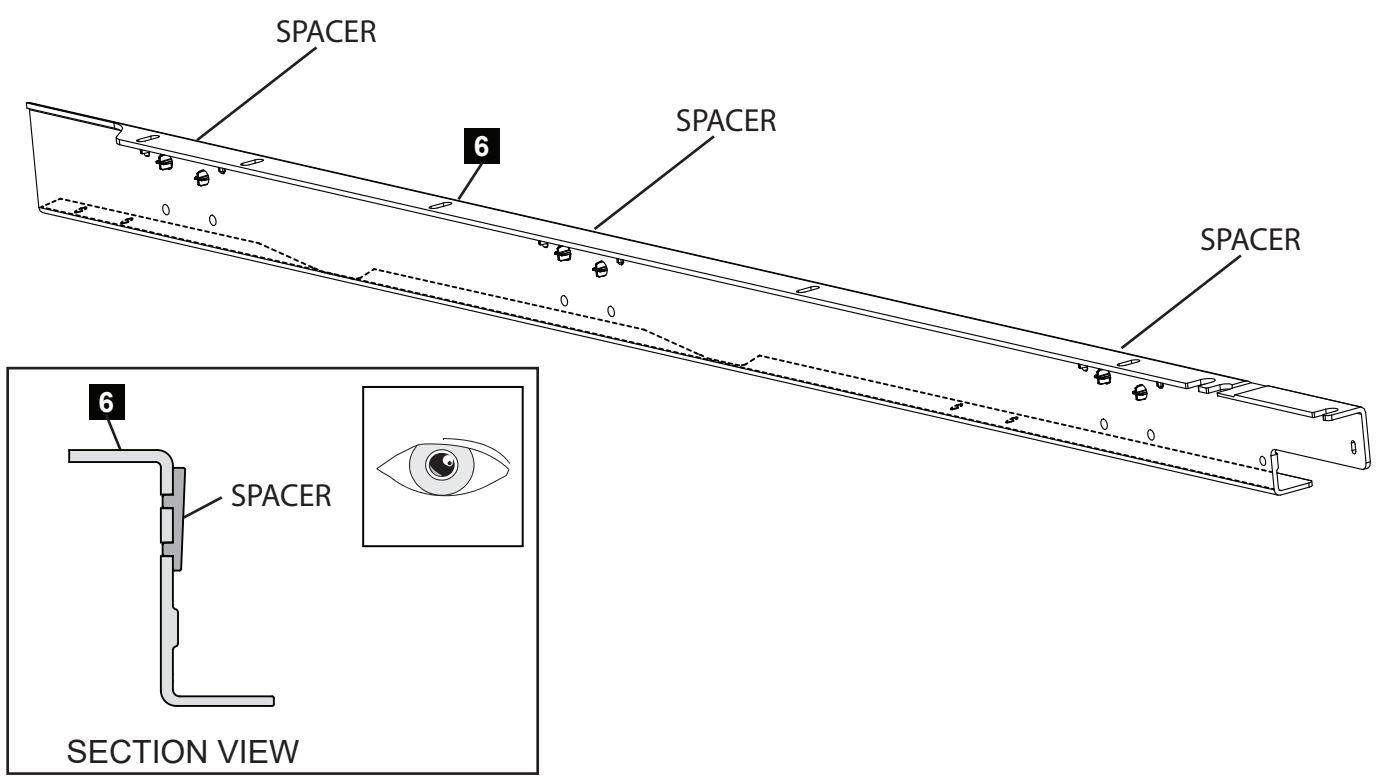

**6** Check if the plastic spacers are in place, if they have fallen out during transport, please refit.

## LHS MOUNT EXTRUSION ASSEMBLY

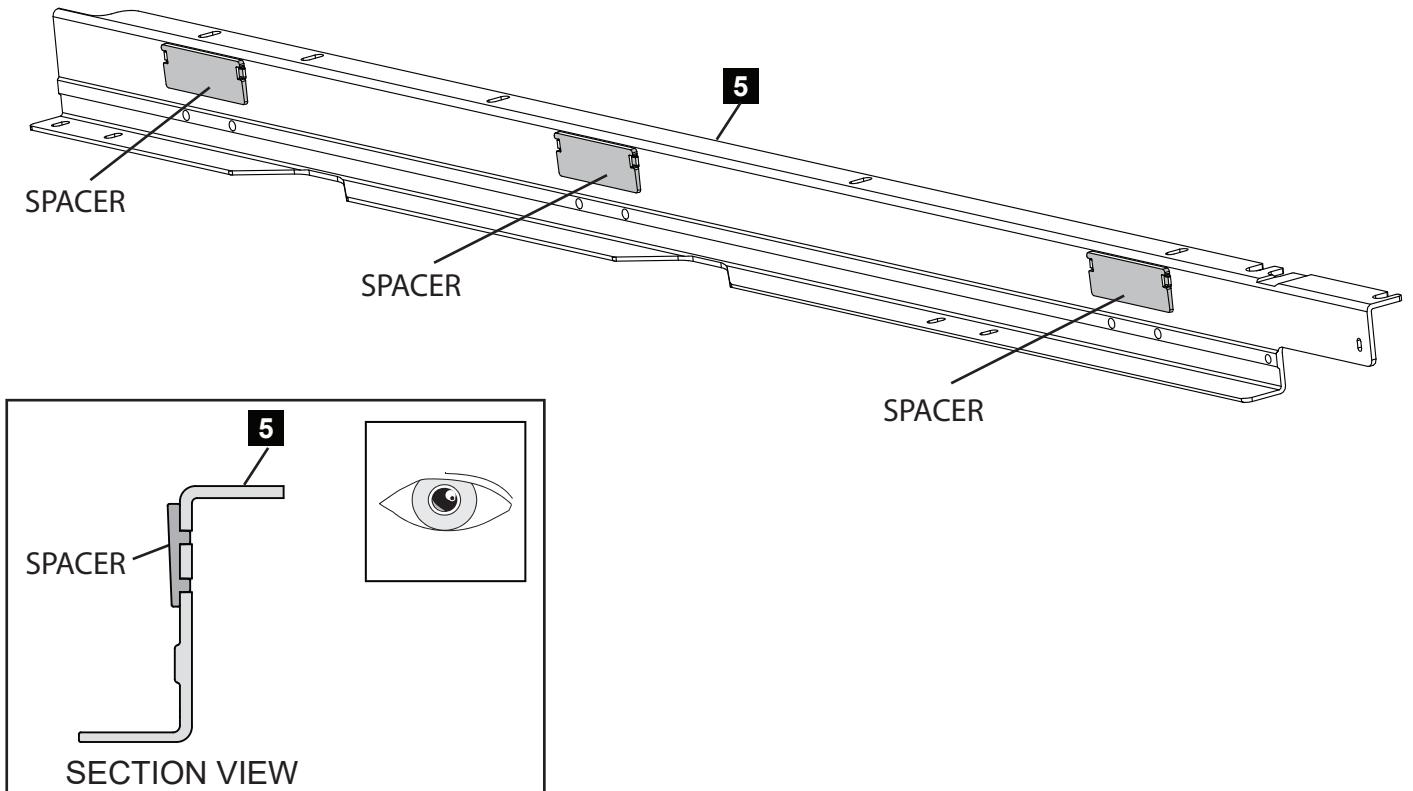

**7** Check if the plastic spacers are in place, if they have fallen out during transport, please refit.

## RHS MOUNT EXTRUSION ASSEMBLY

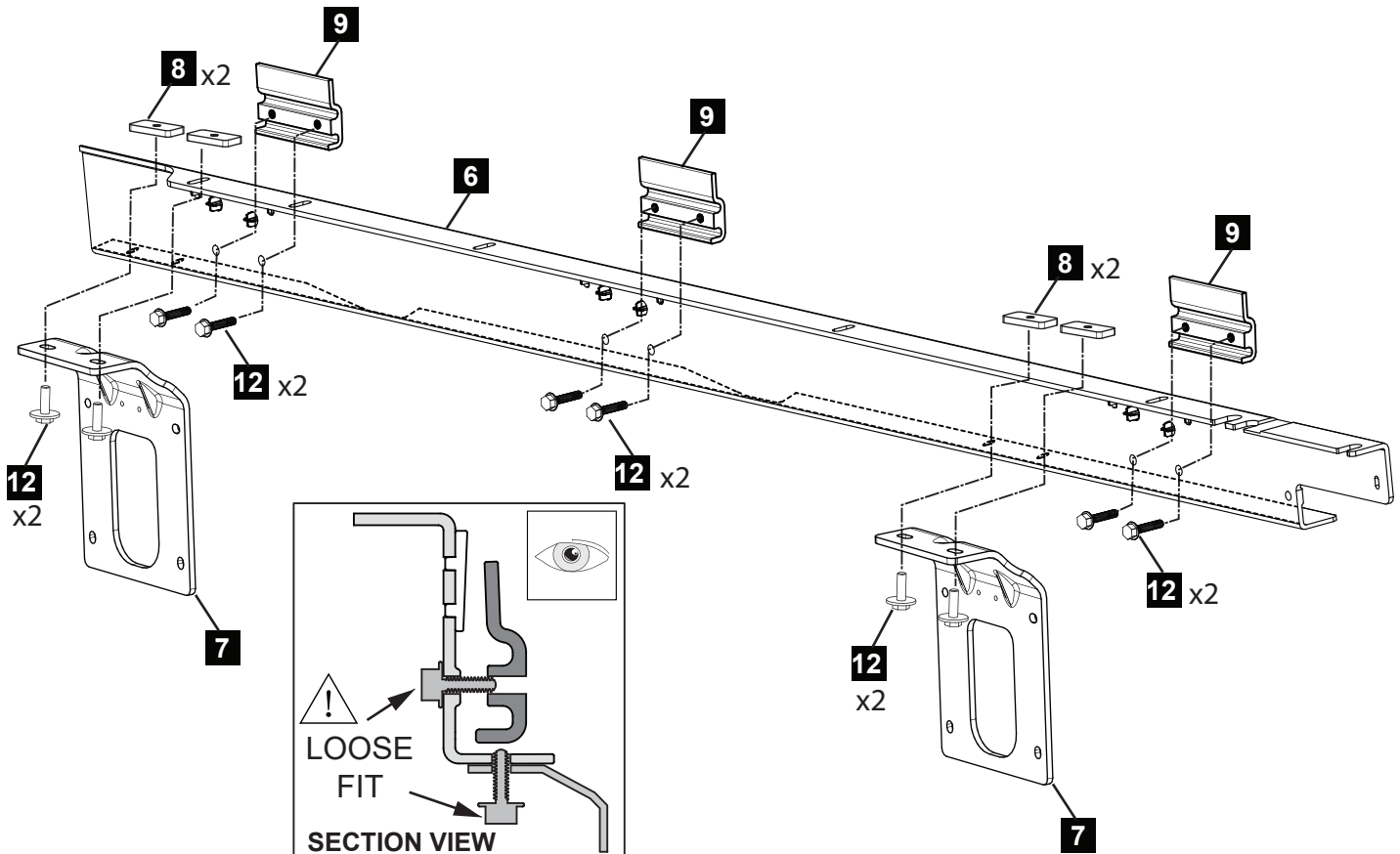

**8** Fit the side brackets (7) to the mount extrusion (6) as shown. Do not torque the screws at this stage.  
**Attention:** Fit screws only two rotations into the plates.



## LHS MOUNT EXTRUSION ASSEMBLY

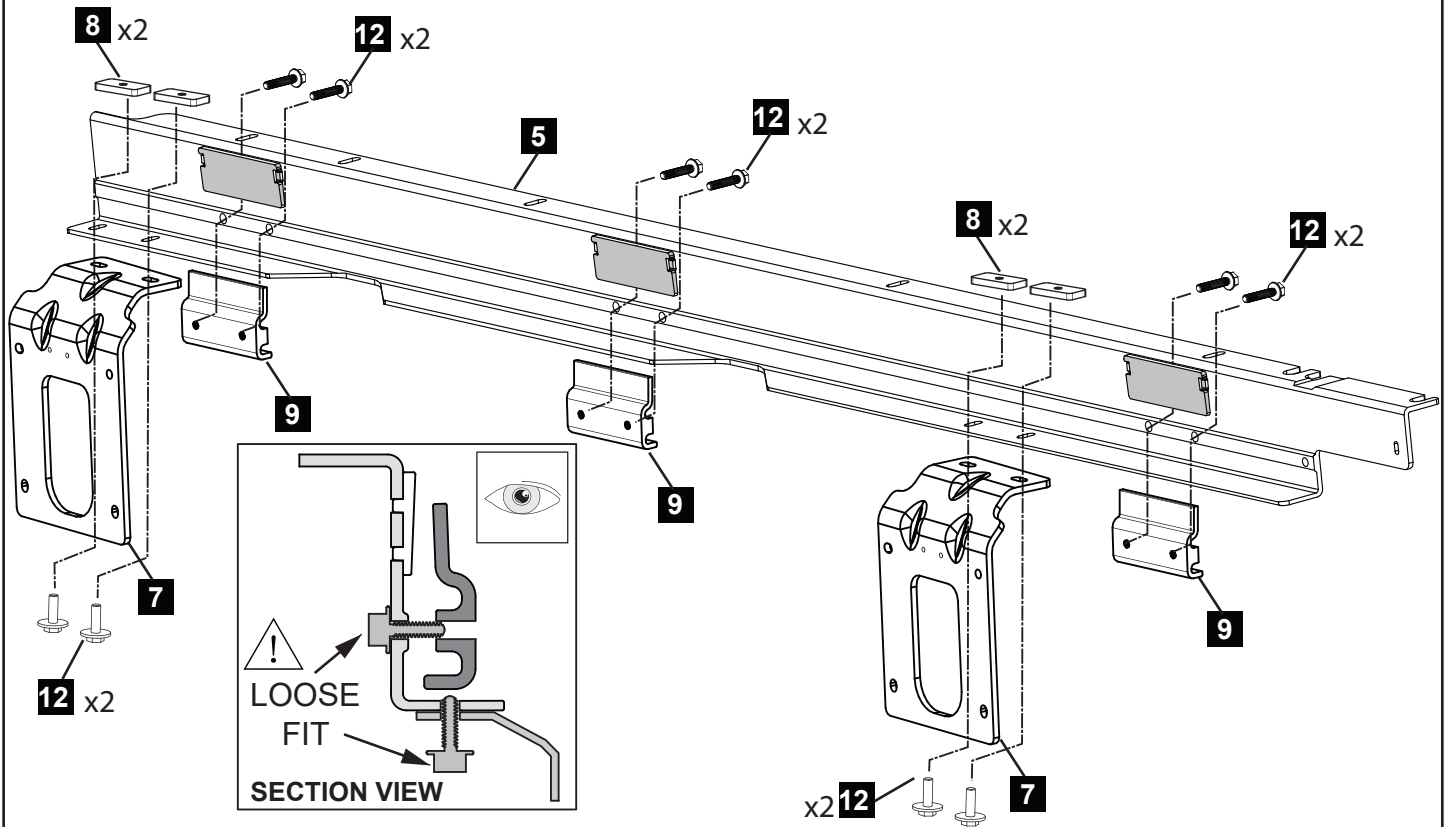

- 9** Fit the side brackets (7) to the mount extrusion (5) as shown. Do not torque the screws at this stage.  
**Attention:** Fit screws only two rotations into the plates.

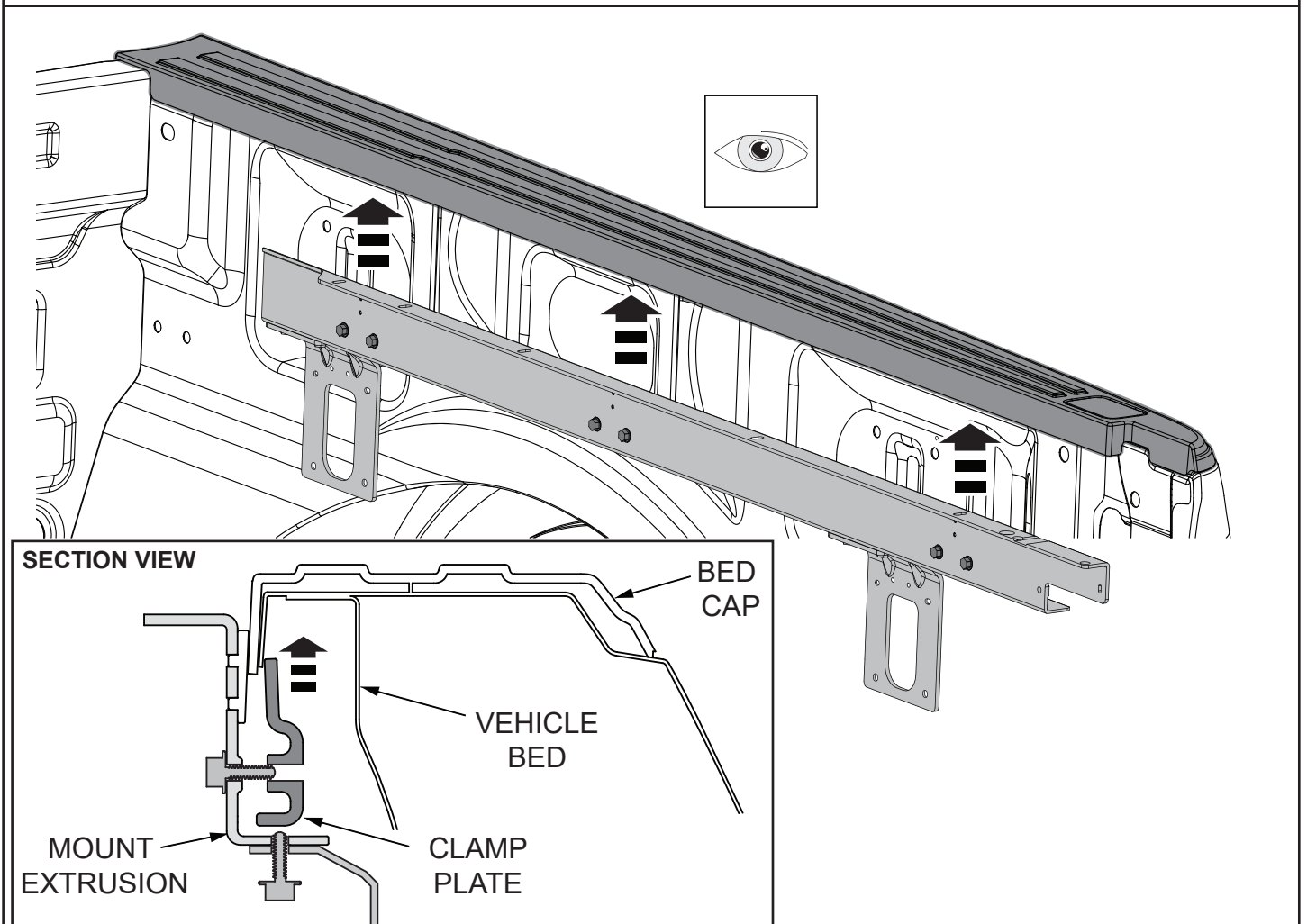

- 10** Fit the mounting bar assembly onto the vehicle bed, by moving it up vertically until the clamps grab the lip of the bed as shown in the section view.

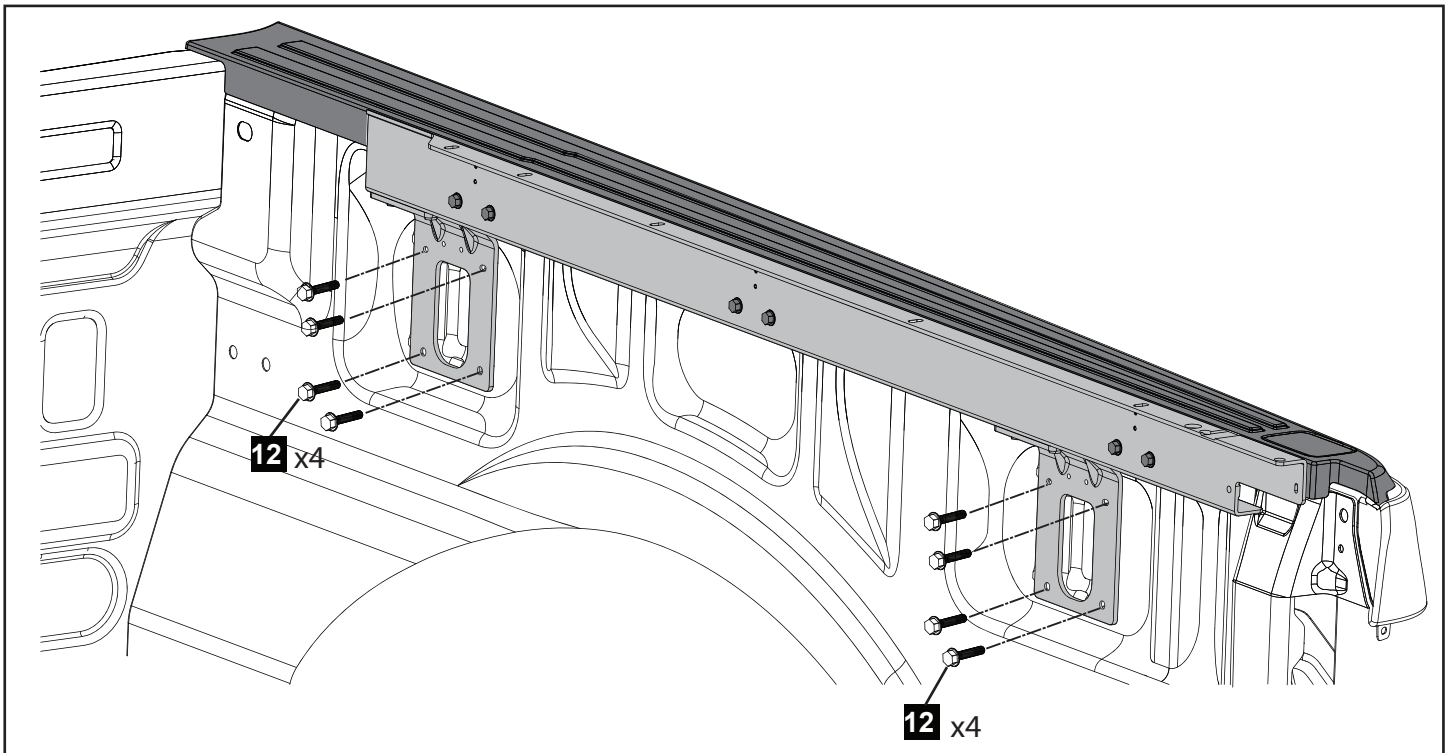

**11** Hold the assembly in position and fit screws (12). Do not torque the screws.

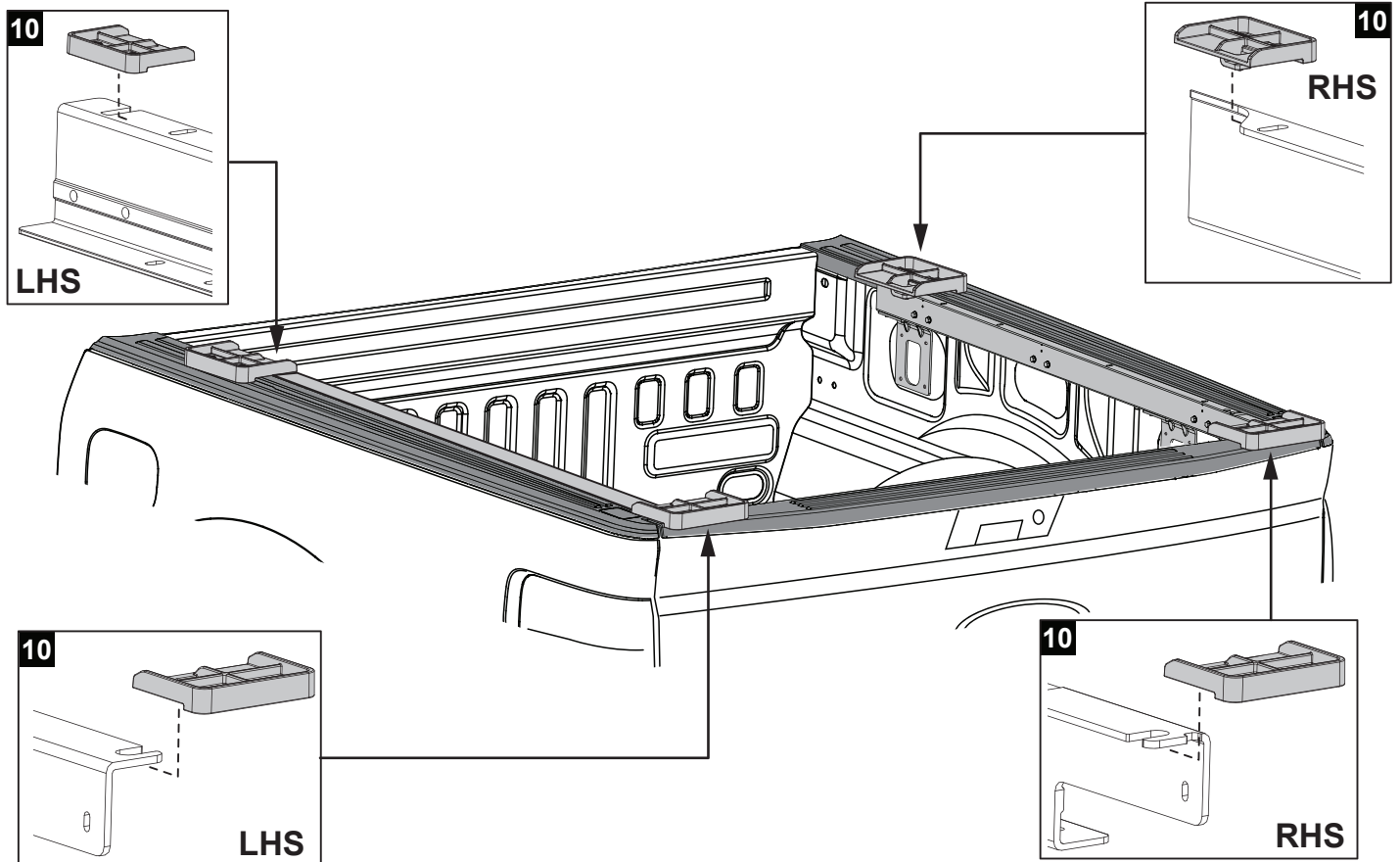

**12** Fit the setup jigs, to set up the RH mount extrusion first. Adjust the mount extrusion front position to the bed cap and rear position to the top of the tailgate using the setup jigs as a guide.

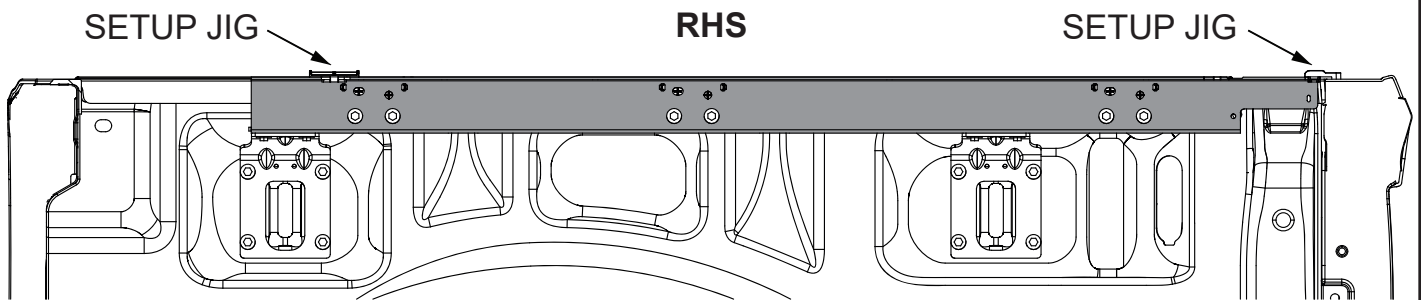
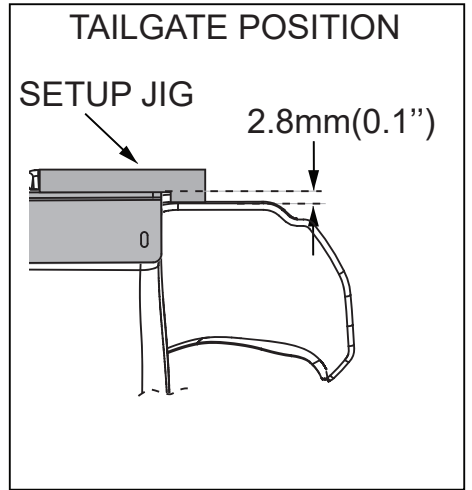
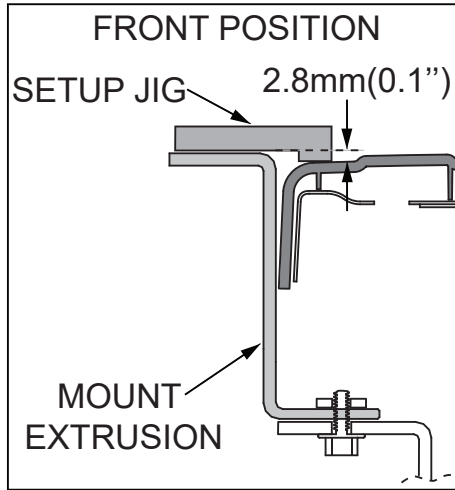
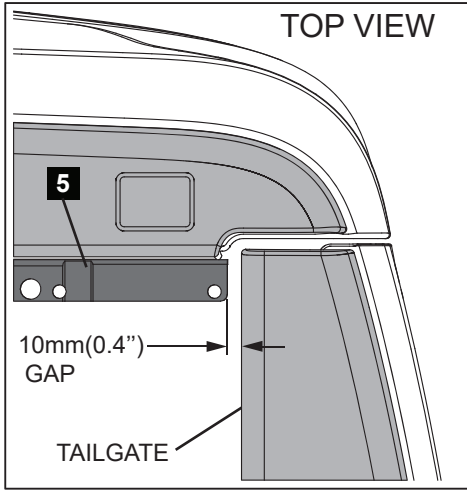

- 13** Set front/back position of the mount extrusion relative to the tailgate 10mm(0.4") gap as shown in top view. Set the vertical position of mounting extrusion by adjusting the extrusion relative to the bedcap (ensuring parts are held level). Use the setup jigs to achieve a 2.8mm(0.1") step between the front end of the extrusion Vs bedcap; and a 2.8mm(0.1") step between the rear end of extrusion Vs tailgate - as shown in detail views above.

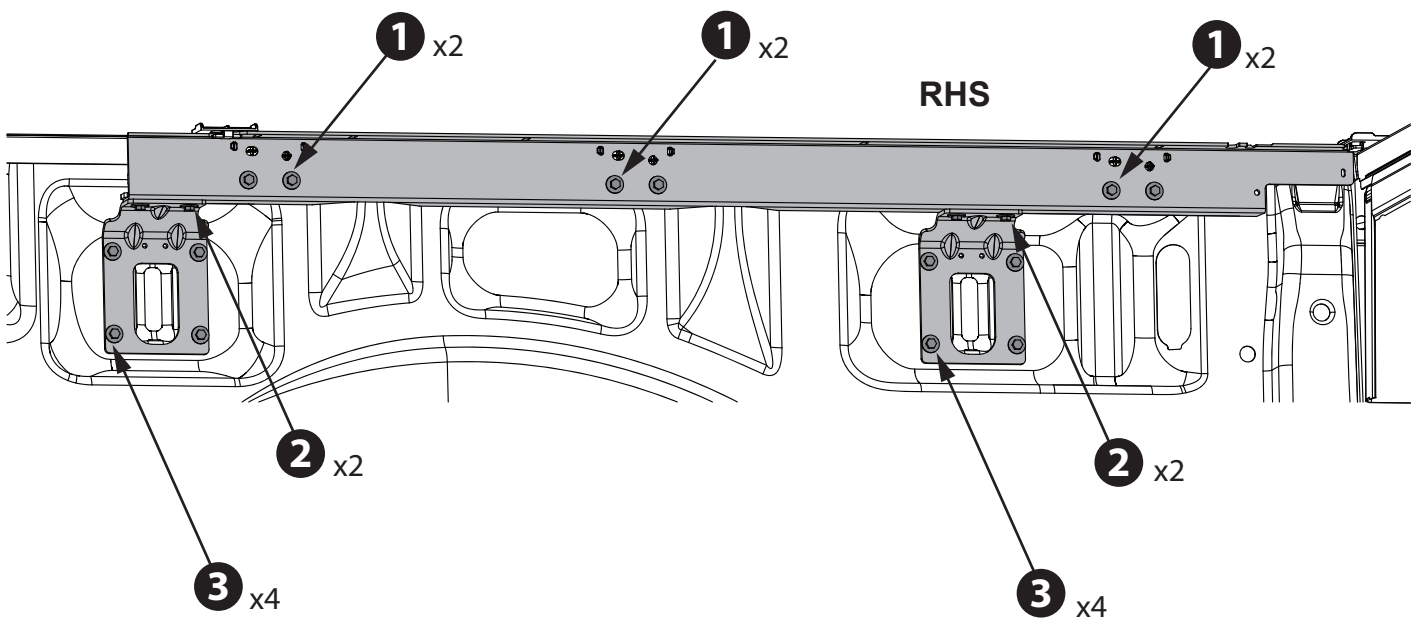
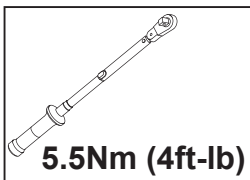
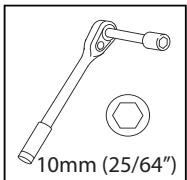

- 14** Torque all screws to 5.5Nm(4ft-lb) in order shown above. Recheck mounting extrusion position from step 13 and remove setup jigs. Repeat step 10-14 on LH side.



DURING ASSEMBLY PROCEDURE SUPPORT AT CENTER OF CANISTER ONLY, PLACE ON TOP AND BASE CARTON (OR SIMILAR), COVER WITH FOAM BLANKET. TO AVOID SCRATCHING POWDERCOATED SURFACES.

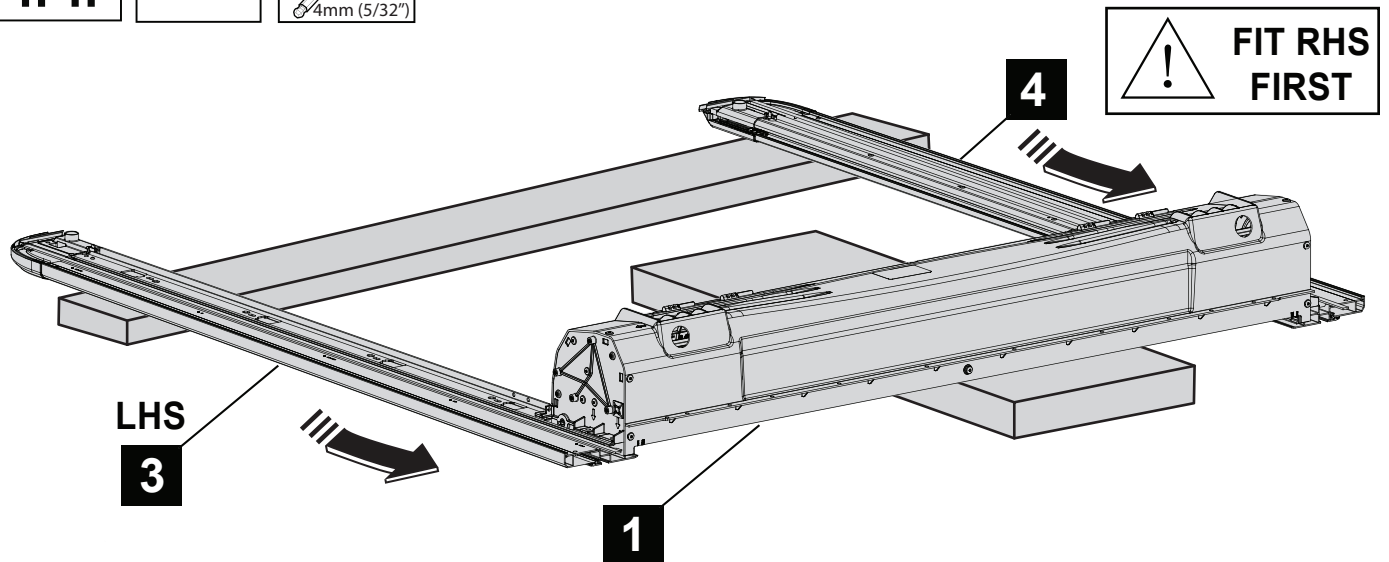
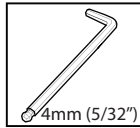
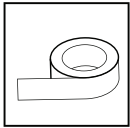

**1** ATTENTION: SEAL MUST FACE IN THE DIRECTION AS SHOWN. WARRANTY VOID IF ASSEMBLED INCORRECTLY.

HOLD SEAL FLAT USE CLOTH TAPE

RHS SHOWN

APPROX 300mm (12")

**2** ATTENTION: EXPOSE 3 SLATS PRIOR TO FITTING SIDE RAILS.

ENSURE ENDS ARE ALIGNED

ATTENTION: WIPE THE SEAL AND SIDE RAIL WITH WAX & GREASE REMOVAL TO ENSURE THE CLOTH TAPE WILL ADHERE TO THE SIDE RAIL AND SEAL

- 1** Place the canister (1) on two protected boxes as shown, ensure hand rail and slat ends are aligned. Tape up the seal on the Side Rail (3) as shown.  
**IMPORTANT:** Carefully align and slide the rail over the handrail endcap and canister endplate taking particular care to ensure that the siderails are slid straight and no undue force is applied. Details in following steps.



DURING ASSEMBLY PROCEDURE SUPPORT AT CENTER OF CANISTER ONLY.  
PLACE ON TOP AND BASE CARTON (OR SIMILAR), COVER WITH FOAM BLANKET TO  
AVOID SCRATCHING POWDERCOATED SURFACES.



**1**

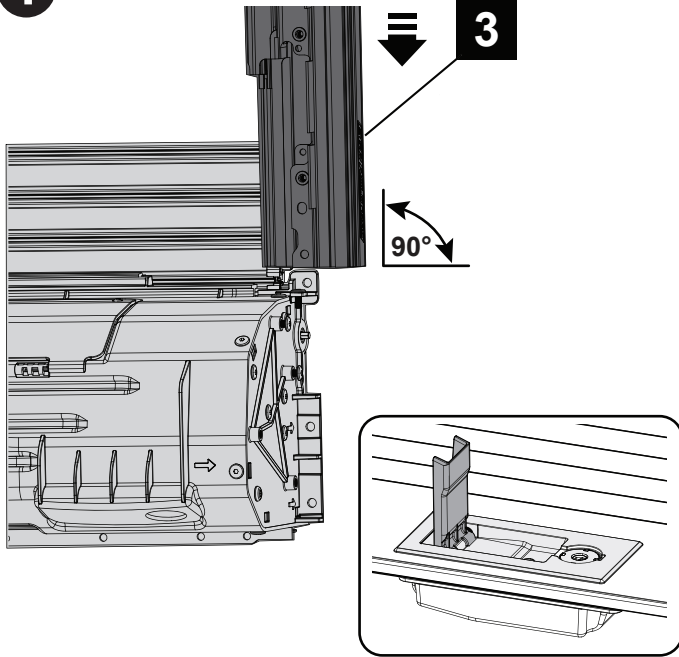

**2**

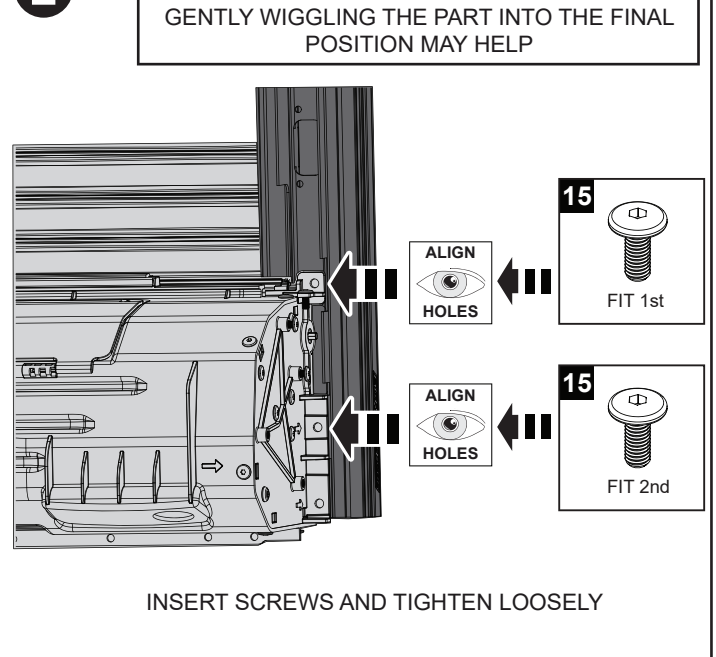

**2** Pull hand rail to expose 3 slats. Fully open handle to retract brake pads. Slide the Rail over slat ends and onto endcap location pins. Align the holes and secure loosely with two screws (15). Do not tighten. Repeat for LHS Rail (4).

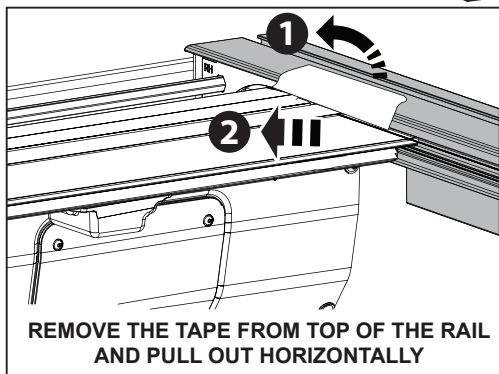
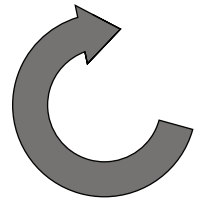
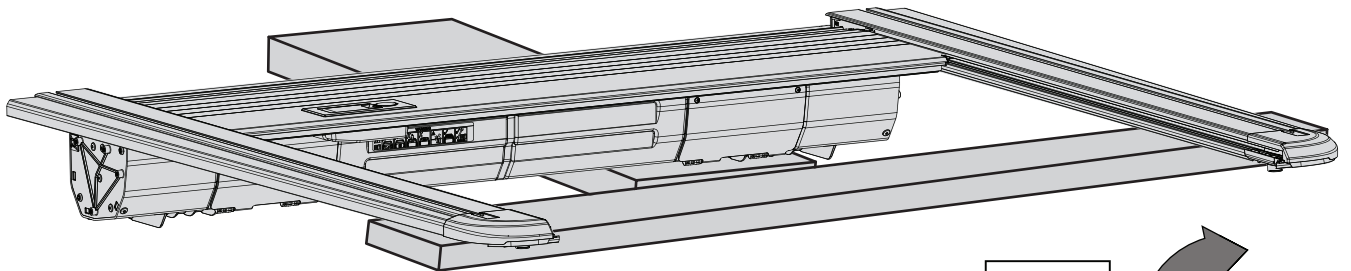

**ATTENTION: SEAL MUST FACE IN THE DIRECTION AS SHOWN. WARRANTY VOID IF ASSEMBLED INCORRECTLY.**

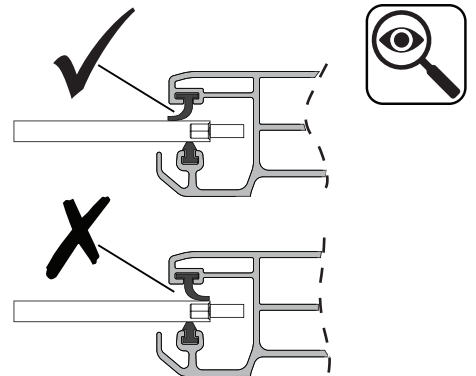
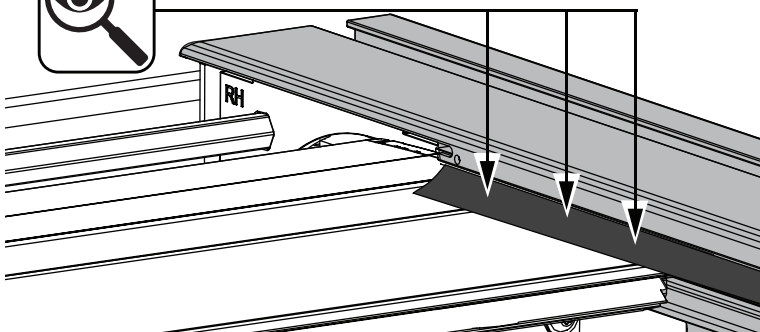

CHECK SEAL IS IN POSITION AND NOT DAMAGED

**3** Carefully turn the assembly over and place onto a protected surface. Remove the tape holding the rubber seal and check the seal position as shown. Repeat for LHS Rail.

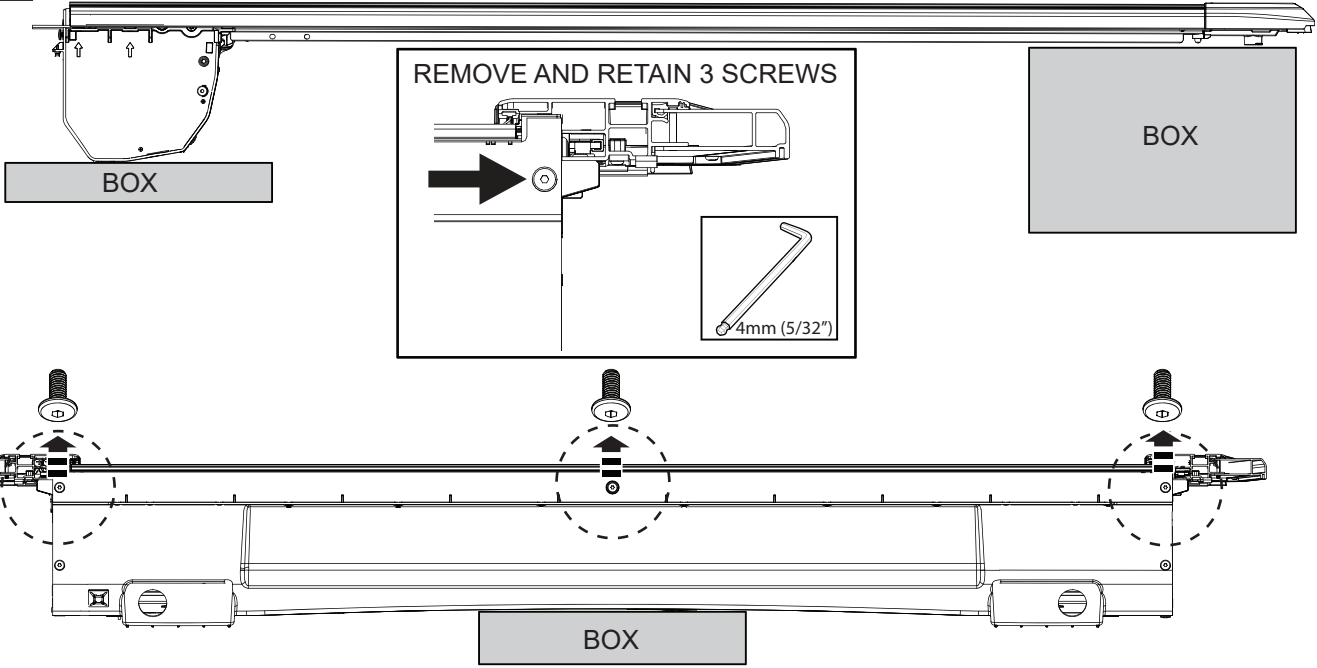

**4** Remove the 3 pre-fitted screws from the rear of the cover which will be used to secure the Front Cover (2) to the assembly. Ensure the product is not scratched or damaged when laying flat.

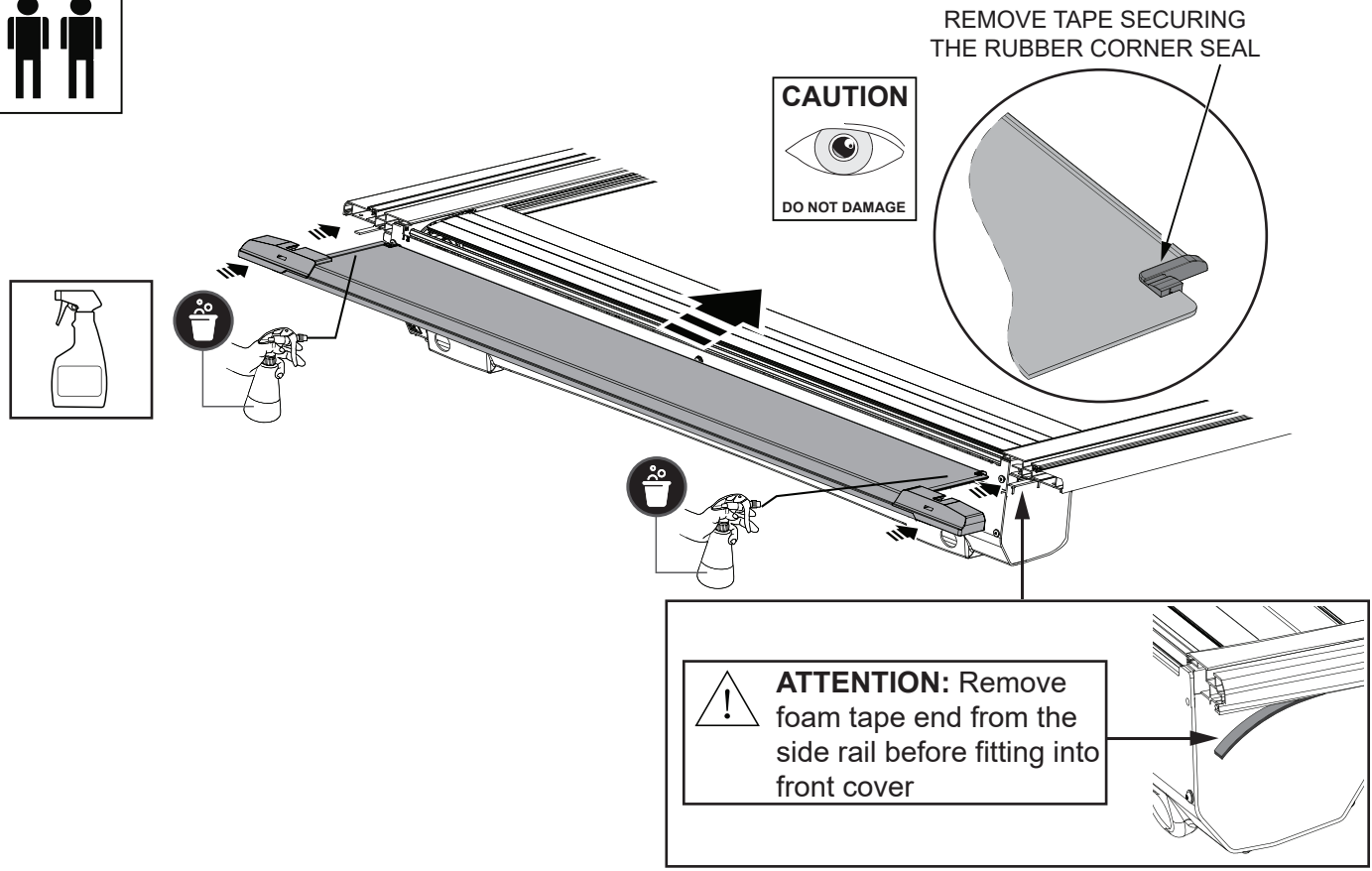
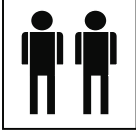

**5** Slide the Front Plate (2) over the canister and into the side rail channels ensuring that the foam side rail tape is pulled out of side rail and the small rubber corner seal on the RHS and LHS of the front plate are not damaged. **IMPORTANT:** Spray the front cover edge with soapy water to allow it to slide easily into the sides, twisting side rails outwards will also help.

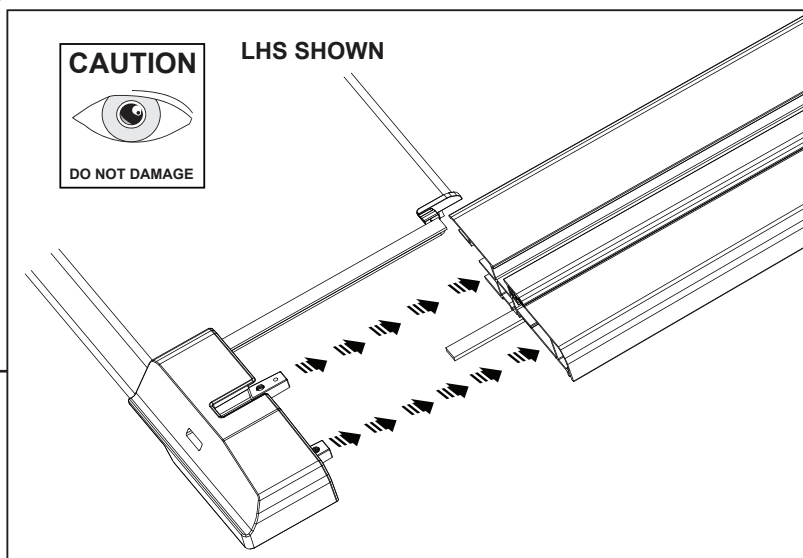
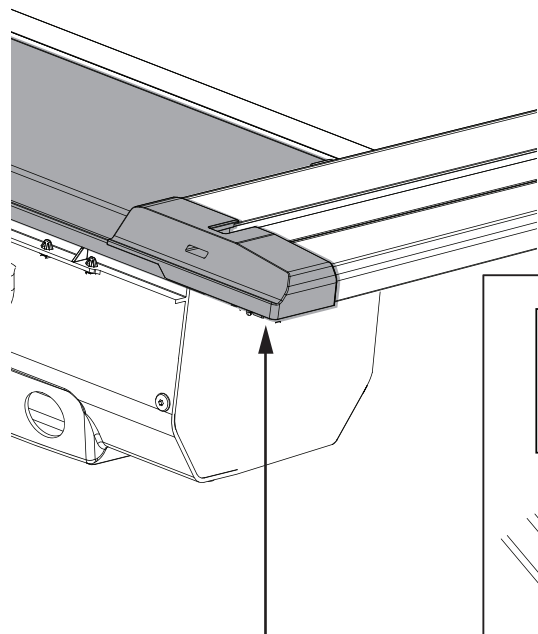

**6** While sliding the front cover ensure the cast connectors are align.

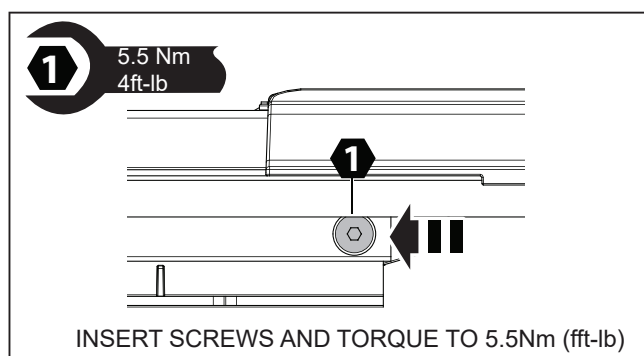
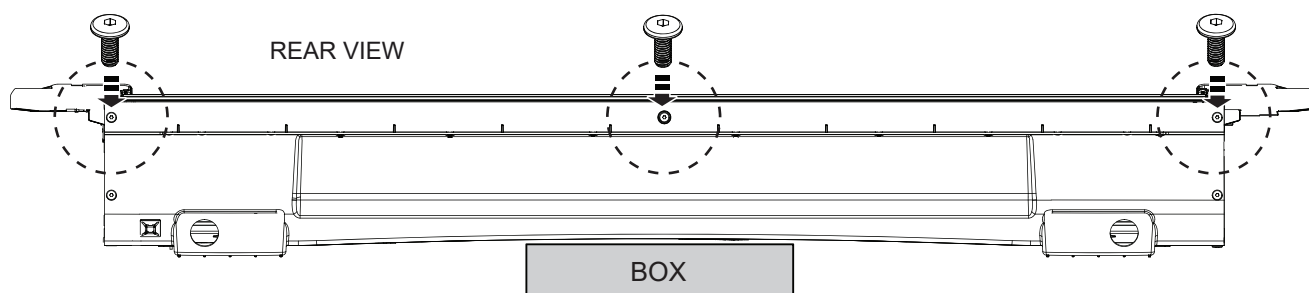
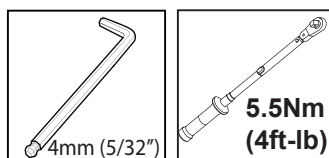

**7** Using the 3 screws removed from Step 4, secure the Front Plate (2) to the Canister Assembly (1) and torque to 5.5Nm (4ft-lb).

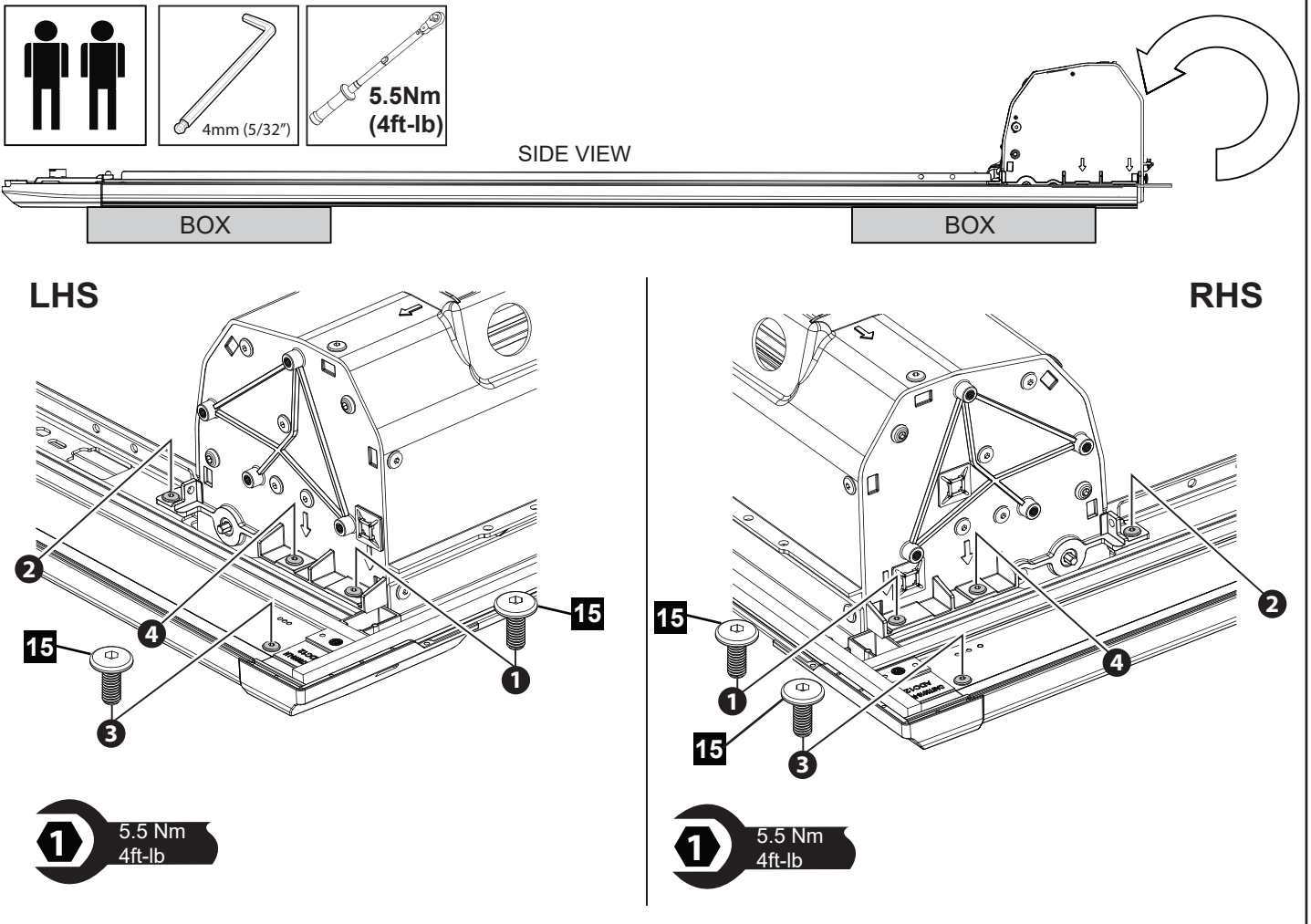

**8** Carefully flip the assembly over onto a flat protected surface which will not damage the cover or scratch the paint work. Install the 2 screws (15) on each side through the canister and side rail into front cover. Torque all screws in order shown to 5.5Nm (4ft-lb).

LHS SHOWN - RHS IS A MIRROR IMAGE

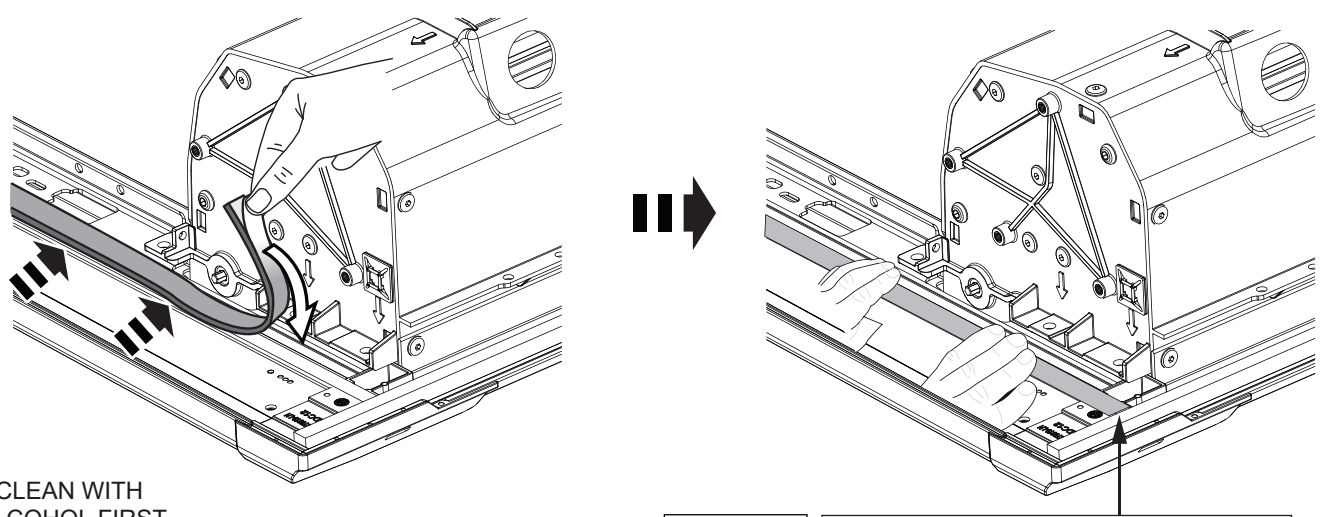

CLEAN WITH ALCOHOL FIRST

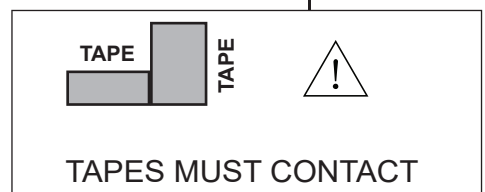
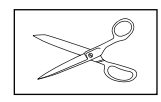

**9** Clean powder coated surface first with alcohol spray. Trim foam tape length to ensure the end will butt against front cover seal - avoiding any gap. Peel the protective liner from the foam tape, adhere to the channel in the side rail, Press down firmly to secure. Repeat on RH side rail.



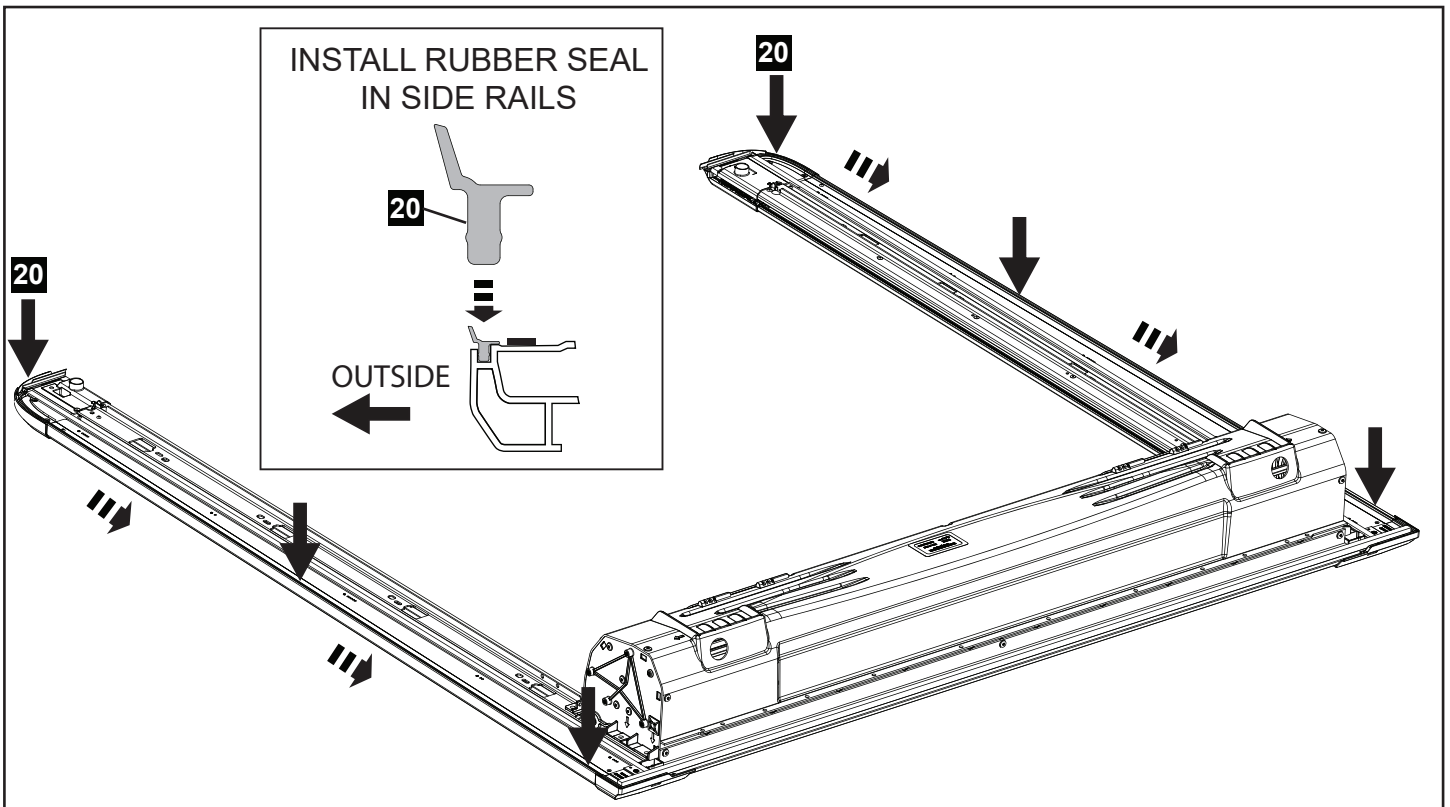

**10** Install the Rubber Perimeter Seal (20) into each side rail and ensure seal is firmly seated (note the seal orientation).  
**Important:** do not stretch the seal while fitting.

**SECTION C** **EGR RollTrac INSTALLATION**

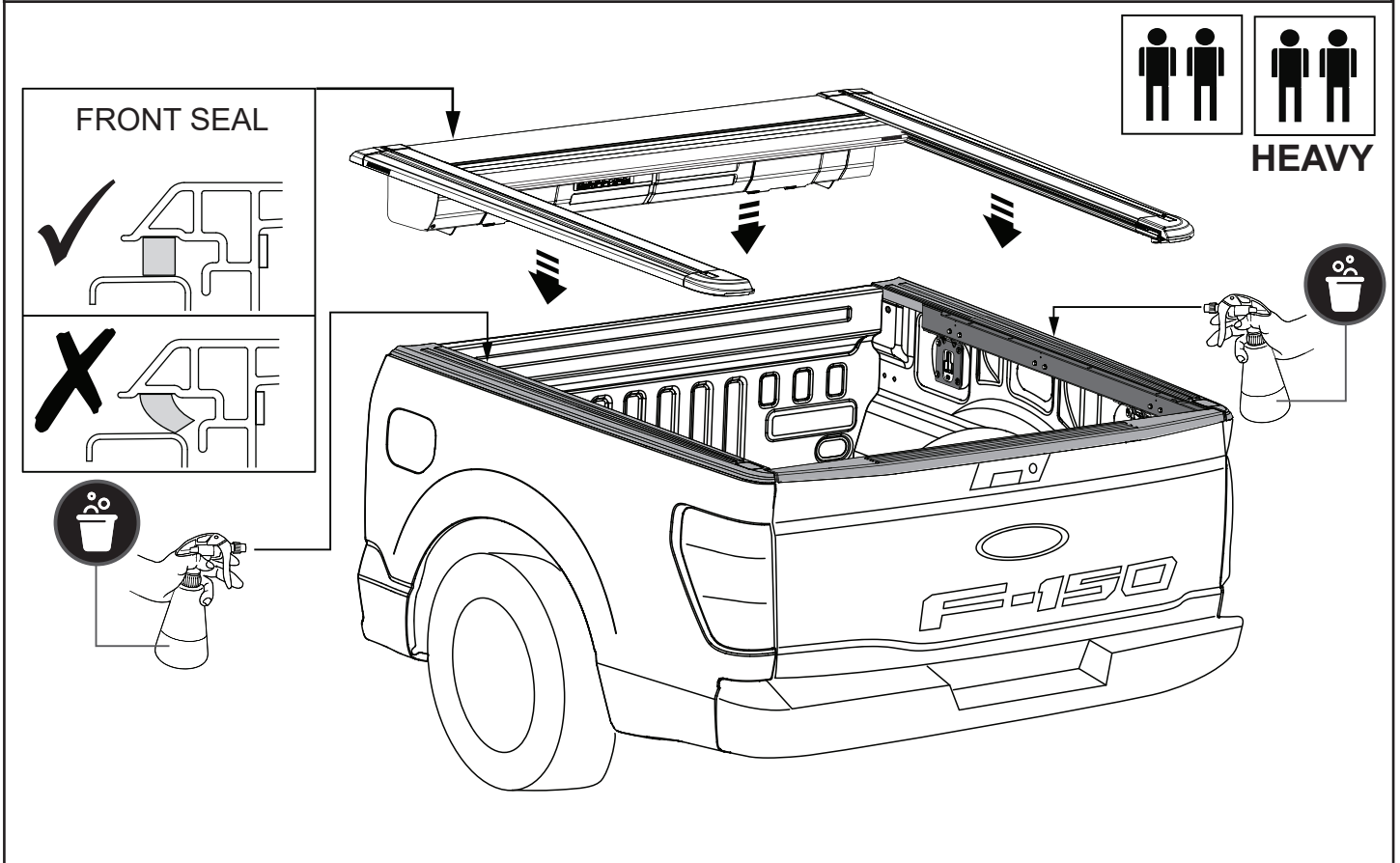

**1** Spray the top surface of the vehicle bed liberally with a soapy water solution to enable the Cover to slide easily. Using two people to lift the cover from both sides and carefully lower it onto the bed. Ensure all seals are sitting vertically as illustrated, by lifting the cover and dropping vertically into position.

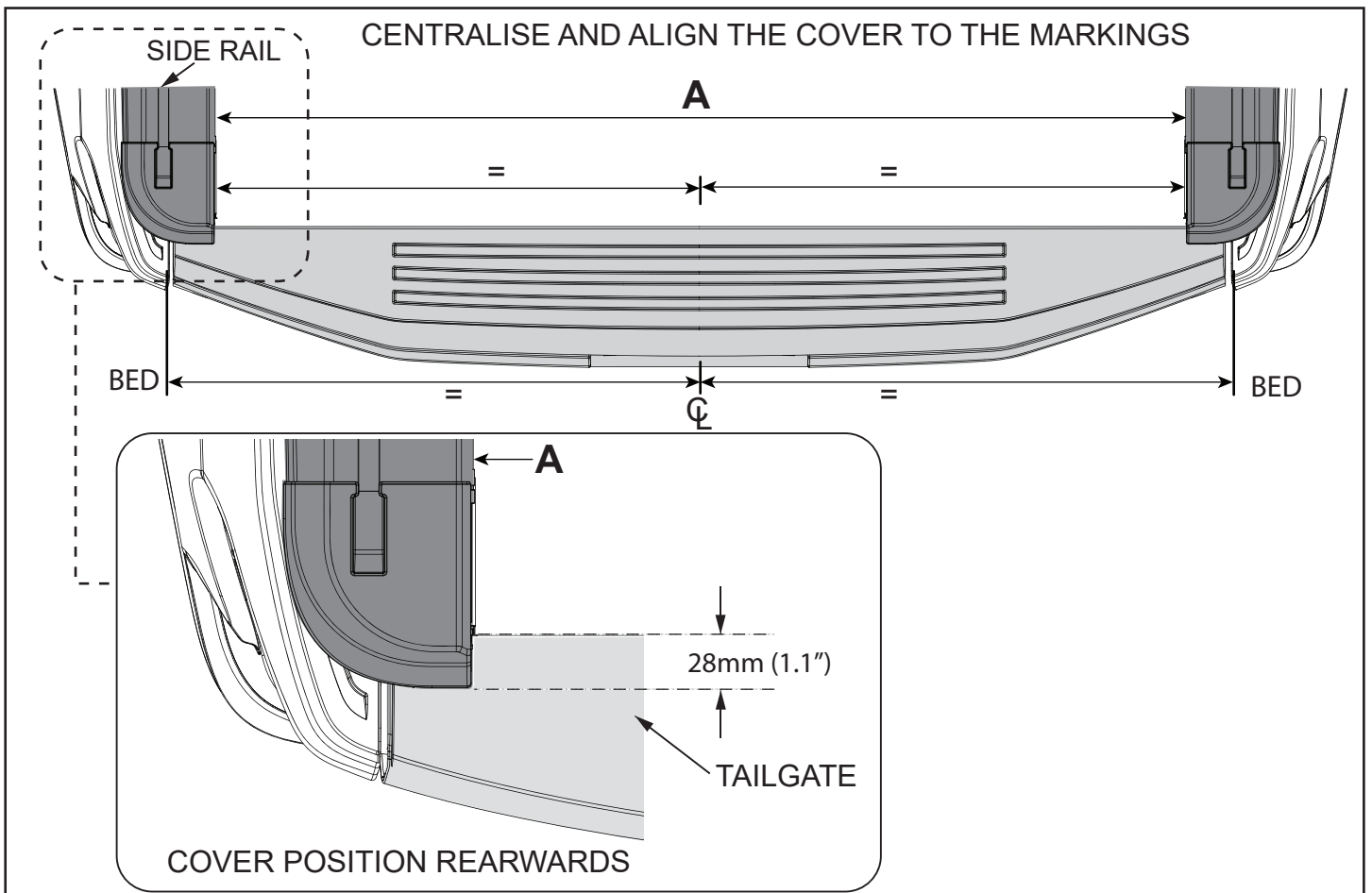

- 2** Apply masking tape at the center of the tailgate and each end to mark length. Measure the distance between the rear corners of the bed and draw a center line on the masking tape. Measure the distance from the marked center line to both rear corners of the RollTrac and ensure it is equally distanced. Adjust the cover so that it is aligned with the markings as shown. Ensure seals are not deformed by lifting cover and dropping vertically on bed.

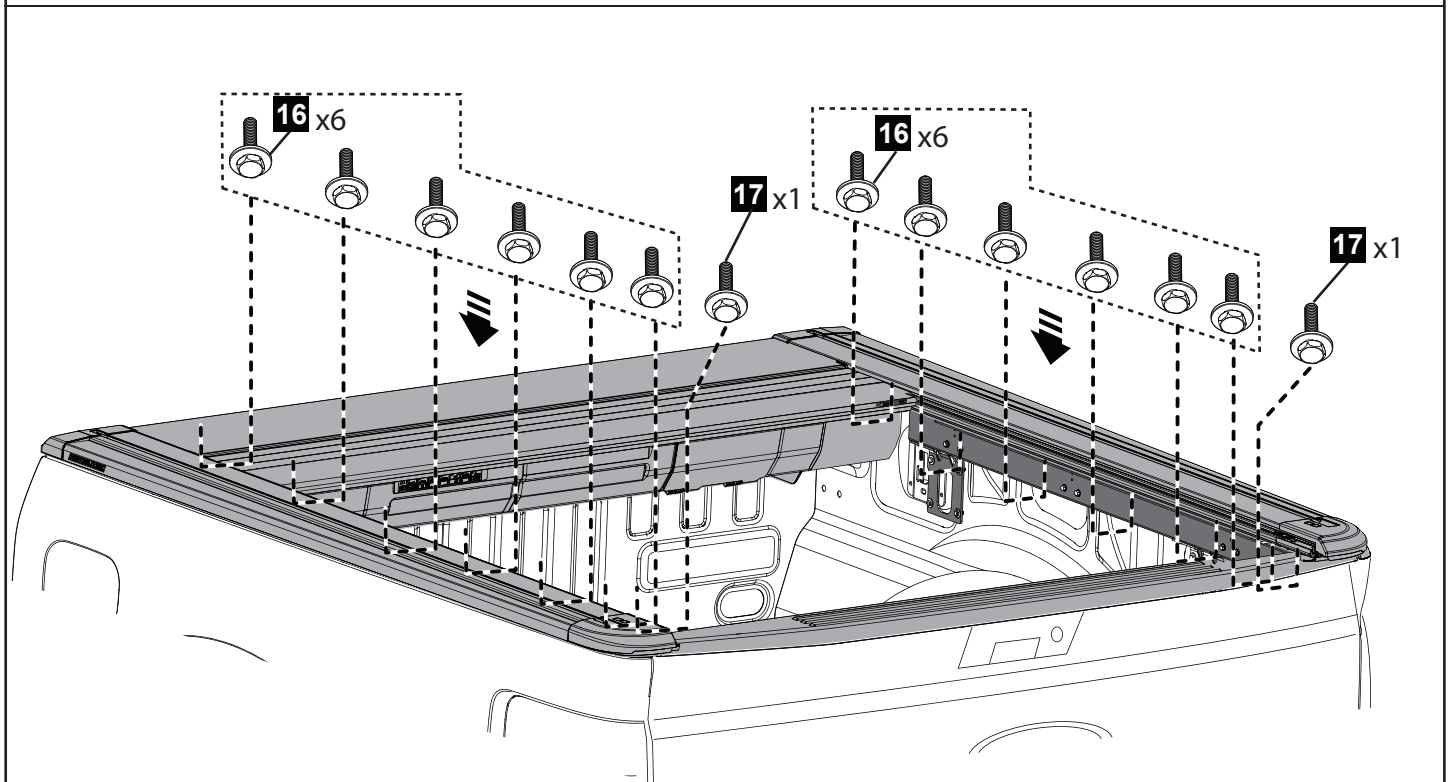

- 3** Secure the rear of the Rolltrac side rail to the mount extrusion with one screws (17) on each side as shown. Secure the side rail with 6 screws (16) on each side. Work from RHS to LHS to avoid one side lifting up.  
**NOTE:** M6 metal plates inside the side rail can be moved to line up with holes, before fitting screws. Do not tighten yet.



### PERFORM FITMENT CHECK

A = A    B = B

LIFT UP THE HANDLE AND PUSH THE COVER MANUALLY

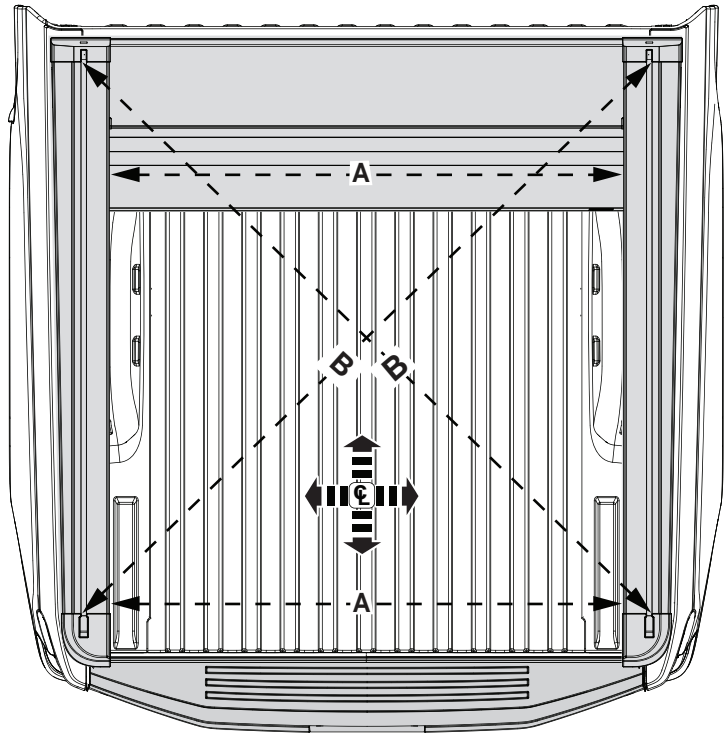
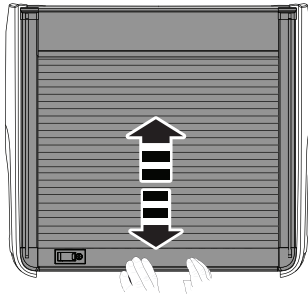
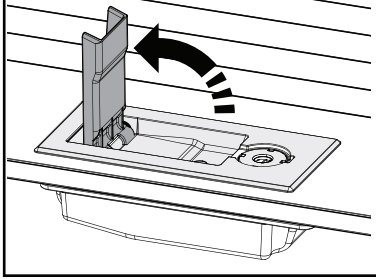

**4** Perform width check (using canister end as reference) and diagonal fitment check (mounting bolts may need loosening for adjustment). Open and close the cover by hand, checking for smooth operation and consistent 1.5-2.0mm(0.05-0.07") side to side free-play of slat assembly within side rails. If there are any tight spots, then check side rail position and re-adjust side rail width as required.

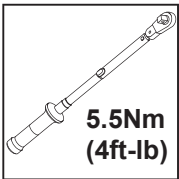

5.5Nm  
(4ft-lb)

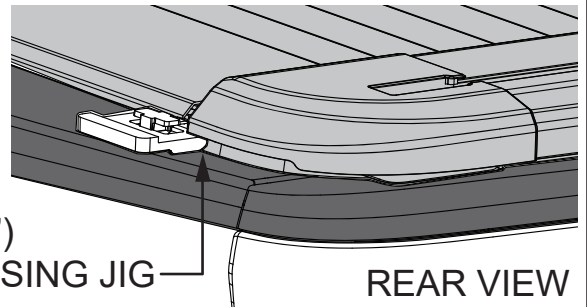

8mm (0.3")  
CHECK USING JIG

REAR VIEW

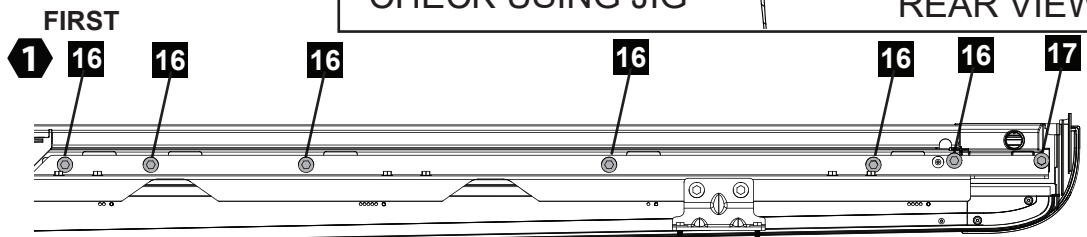

VIEW UNDER THE SIDE RAIL RHS (BED NOT SHOWN FOR CLARITY)



5.5 Nm  
4ft-lb

**5** Working from RHS to LHS (to avoid one side lifting up) torque all screws to 5.5Nm (4ft-lb). Perform final fitment check as per step 4. **IMPORTANT:** Check the clearance between rear corner casting and top of tailgate, target is 8mm(0.3"). Open and close the tailgate to check function of seal (makes contact with tailgate and does not over compress) if position requires adjustment refer to steps 12-14 (section A).

### CONNECT FRONT DRAIN TUBES TO CANISTER

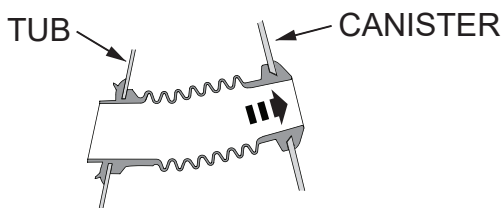

### FIT REAR DRAIN TUBES TO SIDE RAILS

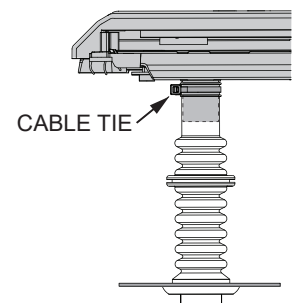

**6** Connect the front drain tubes to the canister. Connect the rear drain tubes to side rails and secure with cable ties.

**SILICONE LUBRICATION TO THE SPIRALS**  
(MODELS MAY VARY, IMAGES FOR REFERENCE ONLY)

**1** Open tailgate and EGR RollTrac

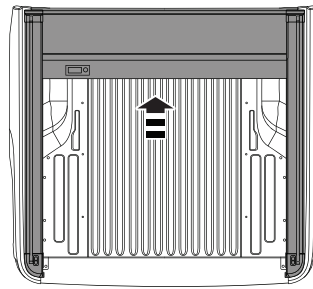
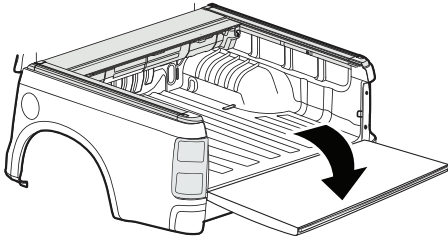

**TOOLS REQUIRED:**

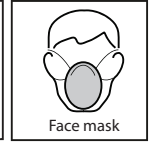
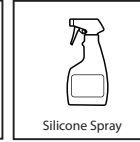
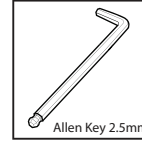

**2** Using a 2.5mm Allen Key remove the 4 screws and open the inspection covers.

**WARNING:** Keep clear of moving parts and avoid unnecessary operation of the EGR RollTrac while inspection covers are open.

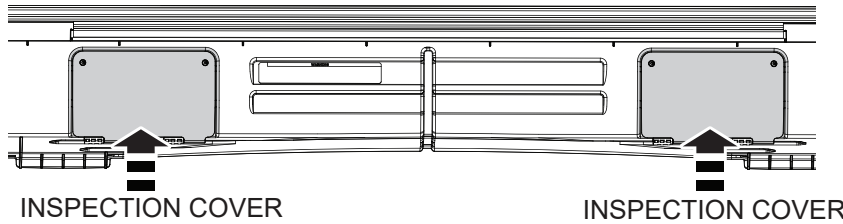

**3** Close the EGR RollTrac to access canister internals

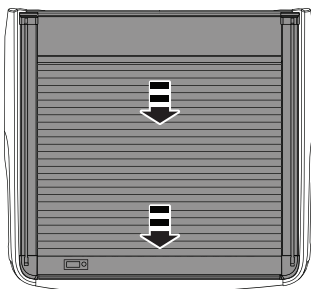

**4** To avoid water leaks, look into the inspection points and check that the flanges of both front drain tubes are correctly engaged to the canister cover (without any kinking etc.), readjust if required.

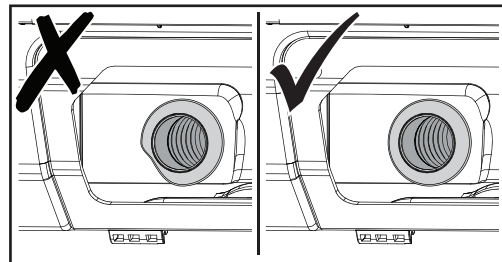

**5** Using plastic compatible 100% Silicone Spray (ONLY) spray onto the spirals on both ends of the canister through the inspection points.

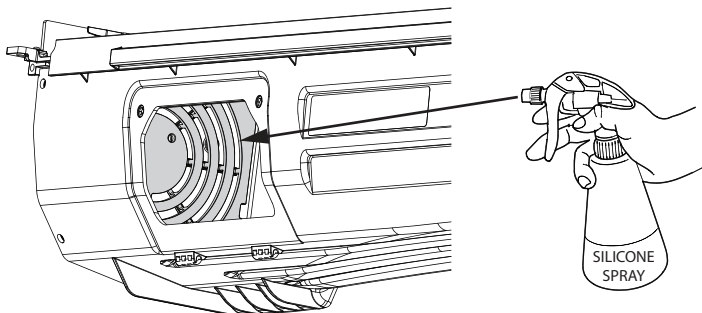

**6** Open the EGR RollTrac

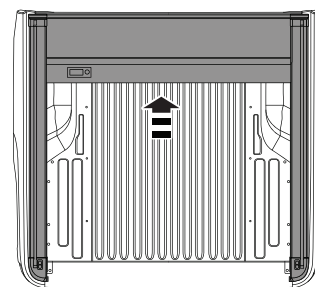

**7** Close the inspection covers and secure with retained screws. Open and close the EGR RollTrac to distribute lubricant and check operation.

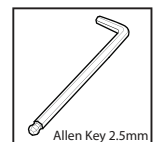
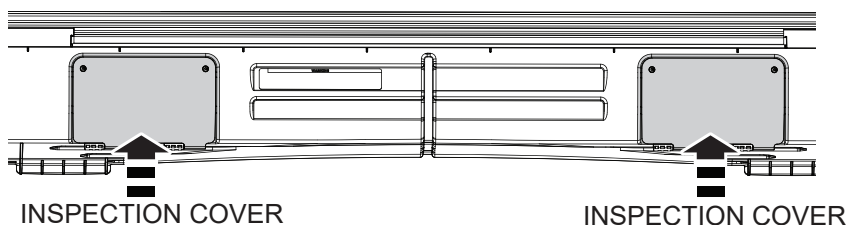

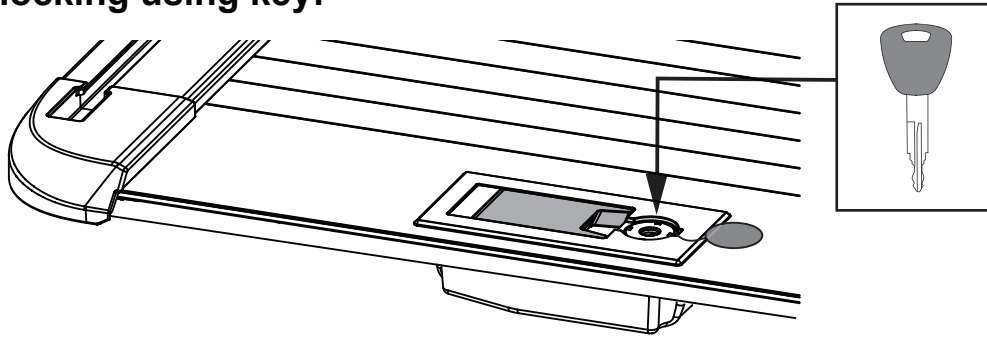
**Locking / unlocking using key:**

1. Ensure the EGR RollTrac handle is down.
2. Open the rubber cap covering the lock and using the provided key turn LEFT (CCW) to lock and RIGHT (CW) to unlock the hand rail.
3. Ensure the lock cap is pushed down to seal the lock.  
**Note:** handle must be folded down prior to locking / unlocking with key. Ensure the lock cap is pushed down to seal the lock after every use.

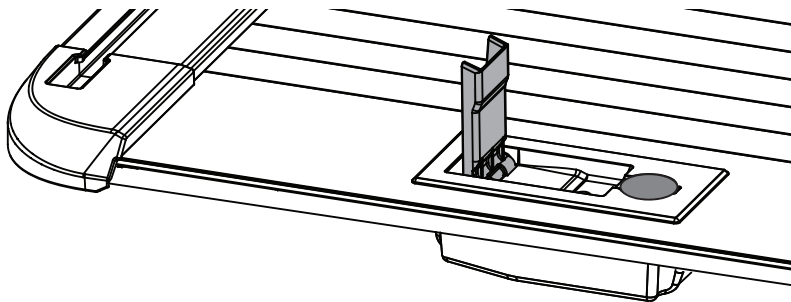
**Opening & Closing Procedure:**

1. Ensure the EGR RollTrac is unlocked.
2. Lift the handle 90 degree up, in order to release the latches from the tailgate rail and open the vehicle tailgate. Lifting the handle to 90 degrees will provide a hand hold so that the user can pull the cover into the next index position.
3. To ensure the EGR RollTrac is properly engaged in the desired position, gently push the handrail at both ends, if excessive movement is observed reposition the hand rail as required.

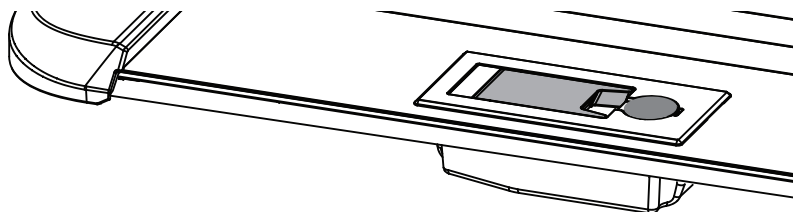

4. Set the hand rail to desired position and fold the handle down.  
**NOTE:** Cover should open and close smoothly. If cover does not lock or open correctly, please refer to the trouble shooting section in the Owners Manual.

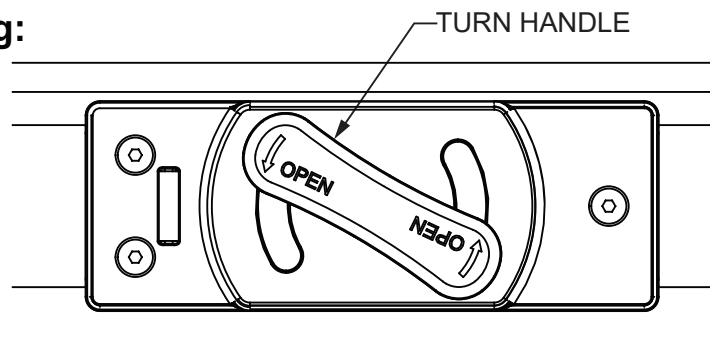
**Emergency Opening:**

Turn the emergency release handle located on the centre of the hand rail assembly and retract the EGR RollTrac.

## RIVETING SIDE BRACKETS

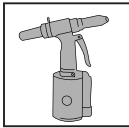
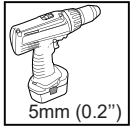

ROLLTRAC NOT SHOWN FOR CLARITY (RHS)

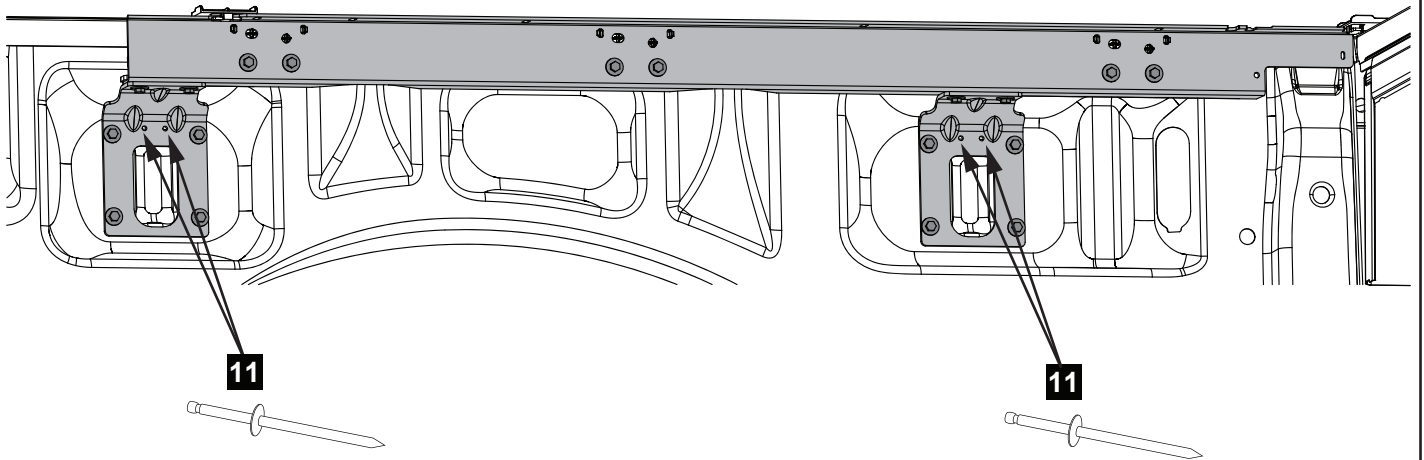

- 1 After running all fitment checks, confirming all functions and running calibration, drill the 4 hole locations using 5mm (0.2") drill bit. Secure the brackets with rivets as shown. Repeat for LHS.  
NOTE: Apply rust inhibitor to drilled holes.

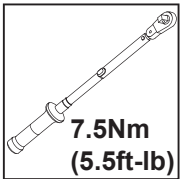

7.5Nm  
(5.5ft-lb)

## RHS MOUNT EXTRUSION ASSEMBLY

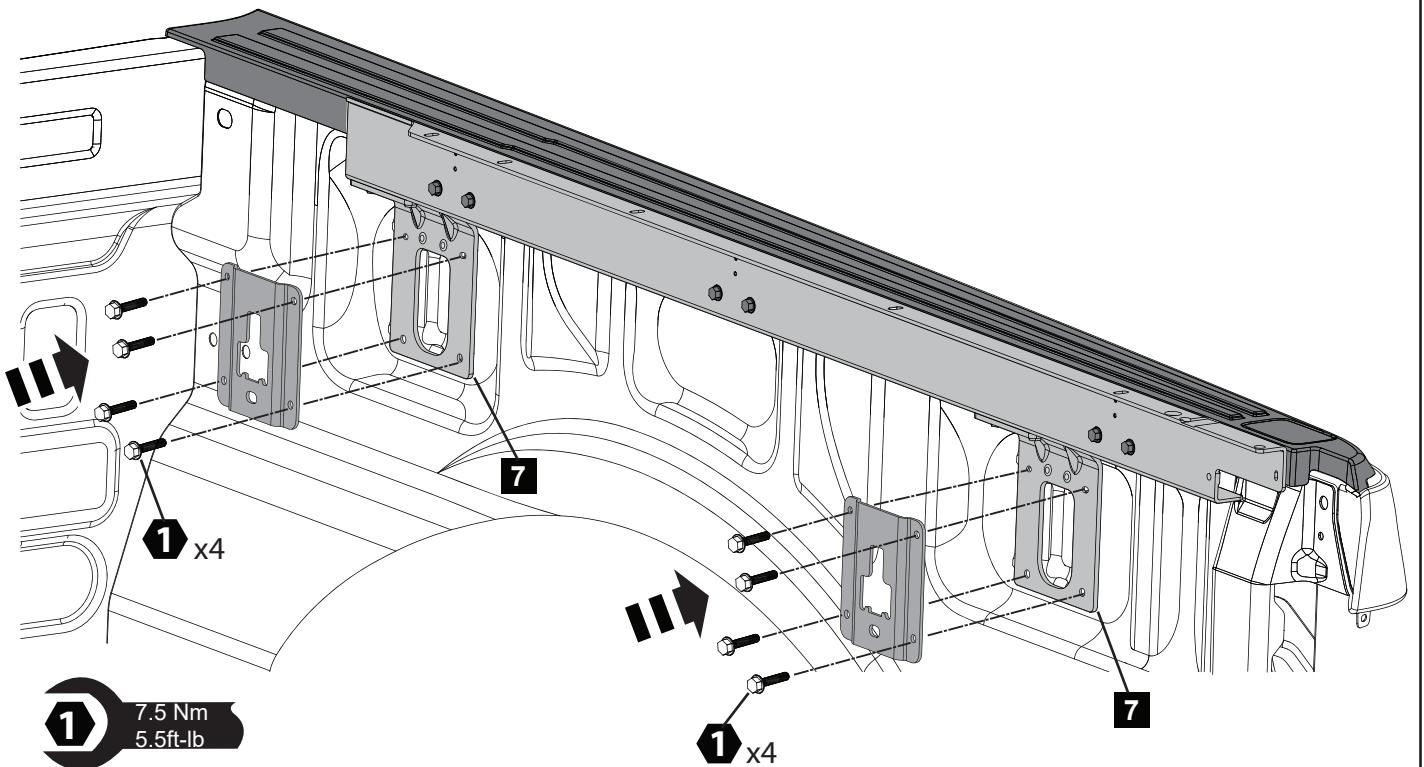

- 2 OPTIONAL: Remove the screws holding the side brackets (7). Fit the utility hook brackets (if provided - removed in step 1) and fit over the support brackets using same screws. Torque to 7.5Nm (5.5lb-ft).