



# EGR

## INSTALLATION INSTRUCTIONS

### Tools Required

		
Clean Dry Cloth	Soap & Water	Non-Permanent Marker



### Cleaning Notes

- Spray with a firm water spray to remove any loose dirt.
- Wash with water, detergent and a soft cloth or sponge.
- Do not use petroleum based solvents or abrasives.

1 • Wash the hood with a mild soap and water solution, then dry thoroughly.

Open the hood.

Trial fit the Hood Deflector centrally onto the hood.

With a non-permanent marker, mark the positions of the four outer tag slots in the Hood Deflector and where they correspond with the existing holes in the hood.

Note the positions of the inner holes in the Hood Deflector and where they correspond with hood lip.

Remove the Hood Deflector.

2 • Clean the three noted areas with the alcohol wipe provided. Wipe off any residue with a dry clean cloth. Adhere the abrasive resistant tape strips over the hood lip.  
Apply tape so approximately half of each strip is adhered to the top side and half is adhered to the underside of hood.



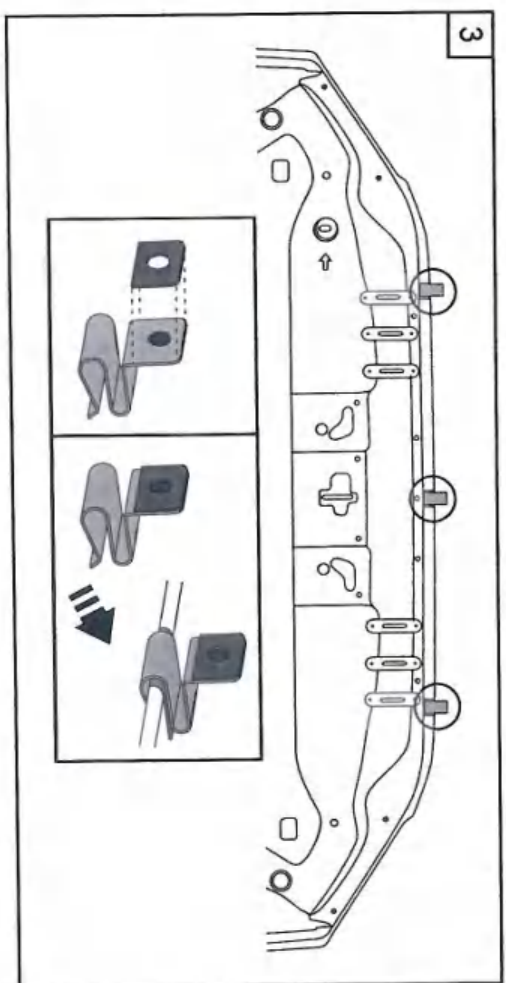
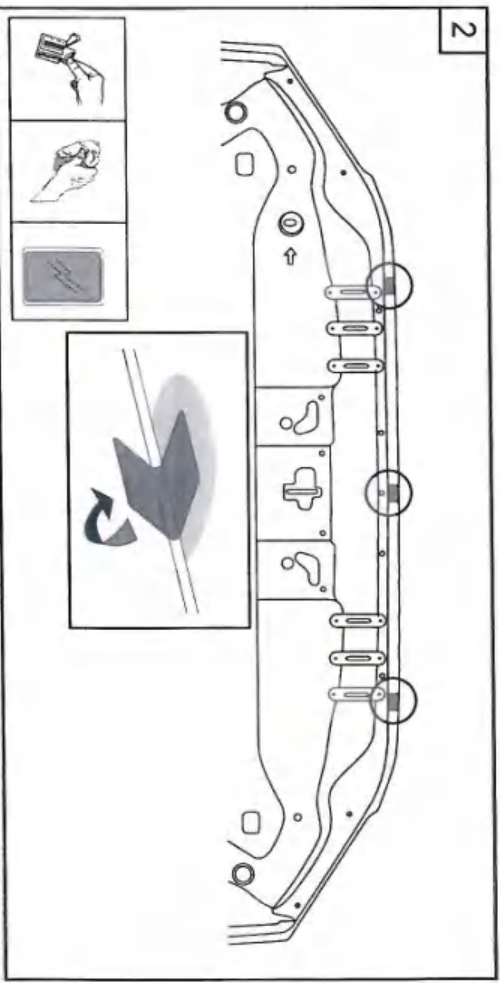
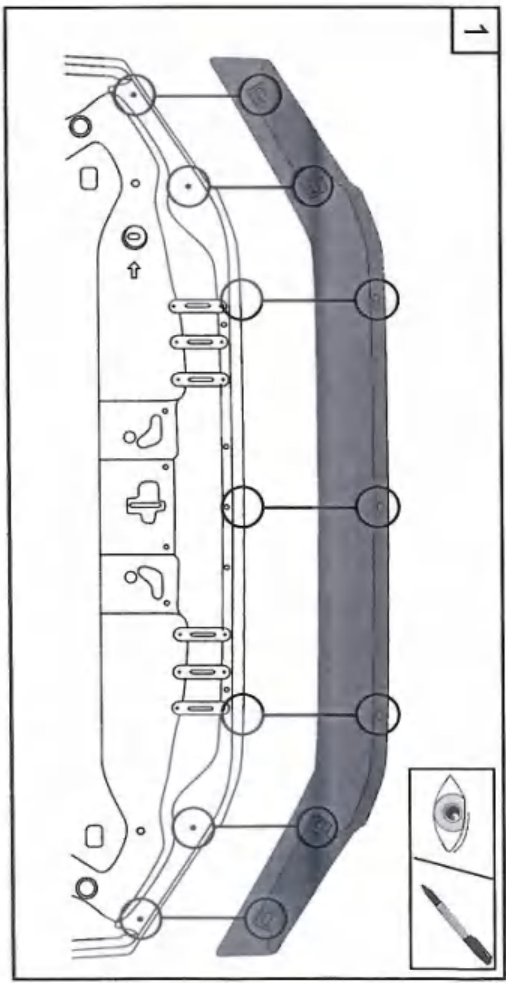

3 • Attach the three foam washers to the face of the three metal push on clips. Slide the metal wing clips over the abrasive resistant tape strips on the hood edge at the three previously noted positions.  
**IMPORTANT: Ensure the clips rest over the abrasive resistant tape and do not come in contact with hood paint work. Failure to do this may result in permanent paint damage.**



# EGR

## INSTALLATION INSTRUCTIONS

### Tools Required

 Clean Dry Cloth	 Soap & Water	 Non-Permanent Marker
 #2 Phillips Head Screwdriver		



### Cleaning Notes

- Spray with a firm water spray to remove any loose dirt.
- Wash with water, detergent and a soft cloth or sponge.
- Do not use petroleum based solvents or abrasives.

4• Insert the four screw plugs provided into the four vacant holes in the hood.

5• Install the Hood Deflector onto the hood ensuring that the collar of the screw plugs locate into and parallel with the slots in the Hood Deflector tags. While maintaining thumb pressure against the underside of the Hood Deflector, insert the four self-lapping screws through four fibre washers into the screw plugs. Do not fully tighten yet.

**Important: Thumb pressure must be maintained on the Hood Deflector to prevent the screw plug from rotating. Do not over-tighten screws.**

6• Loosely secure the Hood Deflector to the three metal push on clips with the three small screws and three remaining fibre washers.

Ensure the Hood Deflector is centralised on hood then fully tighten all screws.

**TO REMOVE:** Reverse the above procedure.

