



CURT™

The **FIRST** Name
in Towing Products™

18145 INSTRUCTIONS

BASKET STYLE CARGO CARRIER



WARNINGS

- Do not exceed maximum weight capacity of 500 lbs. when using 2" receiver tube
- Distribute weight evenly on platform
- This carrier is not intended for transporting people
- Do not carry loads wider or deeper than carrier
- Do not carry flammable items on carrier
- Do not allow exhaust fumes to blow directly on items. This is a fire hazard
- CURT Manufacturing, LLC is not responsible for any damage if warnings are not heeded

PARTS LIST

Item#	Qty	Description
1	18	M6 locking nut
2	18	M6 flat washer
3	6	V support bracket
4	2	Carrier platform
5	4	M10 locking nut
6	4	M10 spring washer
7	4	M10*1.5 flat washer
8	8	M8*35 hexagonal bolt
9	1	Receiver bar
10	4	M10*60 hexagonal bolt
11	18	M6*35 hexagonal bolt

Item#	Qty	Description
12	2	Upper U tube
13	8	M8 locking nut
14	8	M8 flat washer
15	2	Connection profile
16	1	v 4.5 split pin
17	1	1/2" - 13 hex bolt
18	1	1/2" flat washer
19	1	1/2" star washer
20	1	1/4" - 20*1/2" hex bolt
21	1	Nylon adaptor

ASSEMBLY

1. Lay carrier platform down, top of tube flush with plate. Assemble V support bracket (3) on carrier platform (4) and upper U tube (12). secure with M6*35 hexagonal bolts and M6 flat washer (1 and 2).
2. Align all the holes on assembled platforms (step 1) and receiver bar (9). Secure with M10*60 (10) hexagonal bolts. Lock the receiver bar (9) with connection profile (15), then assemble upper U tube into connection profile, and secure with M8*35 hexagonal bolts, M8 flat washer (13) and M8 locking nut (14).

(Note: the connection profile with reflective tapes should be assembled outside, and the one without tapes should be located on the receiver bar side.)

3. Lock M10*60 hexagonal bolt with M10 flat washer, M10 spring washer and M10 locking nut (7, 6 and 5)
4. Put the nylon adaptor (21) onto the receiver bar (9), align all the holes and secure with 1/4"-20*1/2" hex bolt. Insert carrier shank into vehicle receiver tube. Secure with anti-sway bolt & clip (16, 17, 18, 19). Ensure all hardware is tightly fastened.

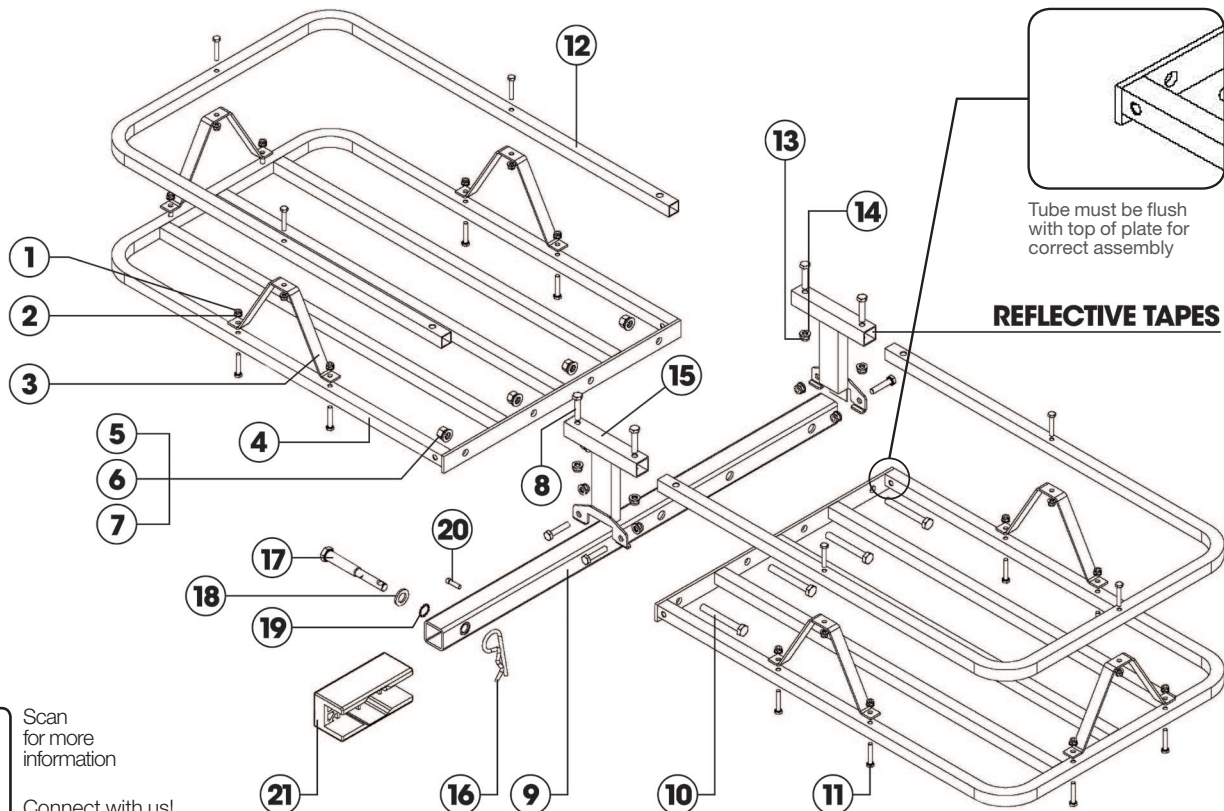

Scan for more information

Connect with us!

