



Fits: 2014-2018 Chevrolet Silverado 1500 / GMC Sierra 1500
: 2019 Chevrolet Silverado 1500 / GMC Sierra 1500 (old body style)

Engine Size: 5.3 L

Cab Size: Double Cab / Crew Cab

Note: Will Not Fit Crew Cab 2WD with 2 PC. Drive Shaft



ALLOW VEHICLE TO COOL DOWN BEFORE WORKING ON ANY ENGINE / EXHAUST COMPONENTS.



REMOVE CONTENTS FROM BOX. VERIFY ALL PARTS ARE PRESENT.



READ INSTALLATION INSTRUCTIONS COMPLETELY BEFORE BEGINNING REMOVAL AND INSTALLATION



LIMITED LIFETIME WARRANTY



60-120 min



Cutting May be Required



PPE Kit Recommended



support@trailfx.com



1 866 638 4870

REMOVAL:

1. Allow plenty of time for your vehicle to cool down prior to starting. Exhaust systems reach high temperatures and may cause serious burns. Always wear appropriate safety equipment including goggles and gloves.
2. Read instructions prior to installation. Use a penetrating lubricant and spray the exhaust clamp nuts and all the isolation rubber mounts before removal and re-installation.
3. For easier installation, lay out the exhaust system according to the diagram.
4. Use a vehicle hoist to raise vehicle to proper working height. If a vehicle hoist is not available, raise the vehicle and securely support using jack stands. Use of a jack or stand to support the muffler when removing or installing is recommended.
5. Remove factory band clamp behind the catalytic convert. A new clamp is provided with the hardware kit of the system. Remove the hangers from the rubber mounts on the vehicle and carefully lower the inlet pipe, muffler, front and rear tail pipe down and out towards the front of the vehicle.
(IMAGE 1)



IMAGE 1

**INSTALLATION:**

1. Install the new inlet pipe #1 onto the rear connection behind the catalytic converter. Install new band clamp and loosely tighten for possible later adjustments. Insert the hangers onto the pipe to the rubber mounts on the vehicle.
2. If installing exhaust system on a crew cab with a 6.5' bed, extension pipe #2 must be used. Slide extension pipe onto the end of the inlet pipe #1 and use provided clamp to loosely tighten for possible later adjustment. Skip step #2 if your vehicle does not have 6.5' bed. (IMAGE 2)
3. Slide provided 3" exhaust clamp over the muffler inlet. Slide the inlet of the muffler onto the back of inlet pipe using a stand to support the muffler. Loosely tighten the clamp for possible later adjustments.
4. Slide rubber hanger #10 onto L bracket and then mount the bracket with supplied bolts, washers, nuts, and backing plates to the left side of the vehicle on the frame using the elongated holes. Use of both backing plates on both sides of the frame is important to cover the elongated holes. (IMAGE 3)

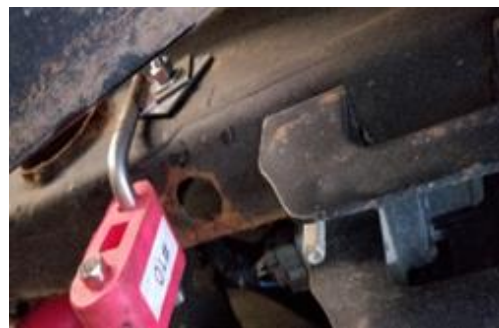
**IMAGE 2****IMAGE 3**

**INSTALLATION CONTINUED:**

5. Slide provided 3" exhaust clamps over the muffler outlets. Position the right tailpipe #4 into position over the rear axle and slide into the right muffler outlet. Insert the two hangers from the right tailpipe #4 into the OEM rubber mounts on the vehicle. Loosely tighten clamp for possible later adjustments. Right tailpipe should have about $\frac{3}{4}$ " clearance from shock after final adjustments. (IMAGE 4)
6. Slide the left front tailpipe #5 over the rear axle and into the left muffler outlet. Slide provided 3" exhaust clamp over the end of the pipe.
7. Install left rear tailpipe #6 onto front tailpipe. Insert hanger of rear tailpipe into rubber hanger installed in step #4. Tailpipe should be positioned between shock and spare tire at final adjustment. Loosely tighten clamps for possible later adjustment. (IMAGE 5)
8. Slide the supplied 3" exhaust clamps onto either the side exits pipes #7 or the rear exit pipes #8 onto the ends of both rear tailpipes #4 and #6. Loosely tighten clamps for possible adjustment. (IMAGE 6)

**IMAGE 4****IMAGE 5****IMAGE 6**



INSTALLATION CONTINUED:

9. Make all necessary adjustments for the pipes and muffler for proper clearances. From front to rear, fully tighten each clamp until connections are secure.
10. Install supplied hanger keepers onto inlet pipe and tailpipes. Hanger keeper are important to keep the system from shifting and allowing a hanger to come free from holder. (IMAGE 7)



IMAGE 7



IMAGE 8

Please consider these complementary SpeedFX products.

www.Speed-FX.com





PARTS LIST:

Qty	Part Description	Qty	Part Description
1	Inlet Pipe (#1)	1	Hardware Kit*** (#13)
1	Extension Pipe (#2)	1	Steel Frame Hanger (#11)
1	Muffler (#3)	2	Steel Back Plates
1	Right Tailpipe (#4)	1	Rubber Hanger (#10)
1	Left Front Tailpipe (#5)	7	3" Exhaust Clamps (#12)
1	Left Rear Tailpipe (#6)	1	Bolt – 3/8" X 1 1/4"
2	R / L Side Exit Pipes (#7)	1	3/8" Nut, Washer, Lock Washer
2	R / L Rear Exit Pipes (#8)	1	7/16" Hanger Keeper
2	Black Powder Coat Tips (#9)	5	1/2" Hanger Keeper

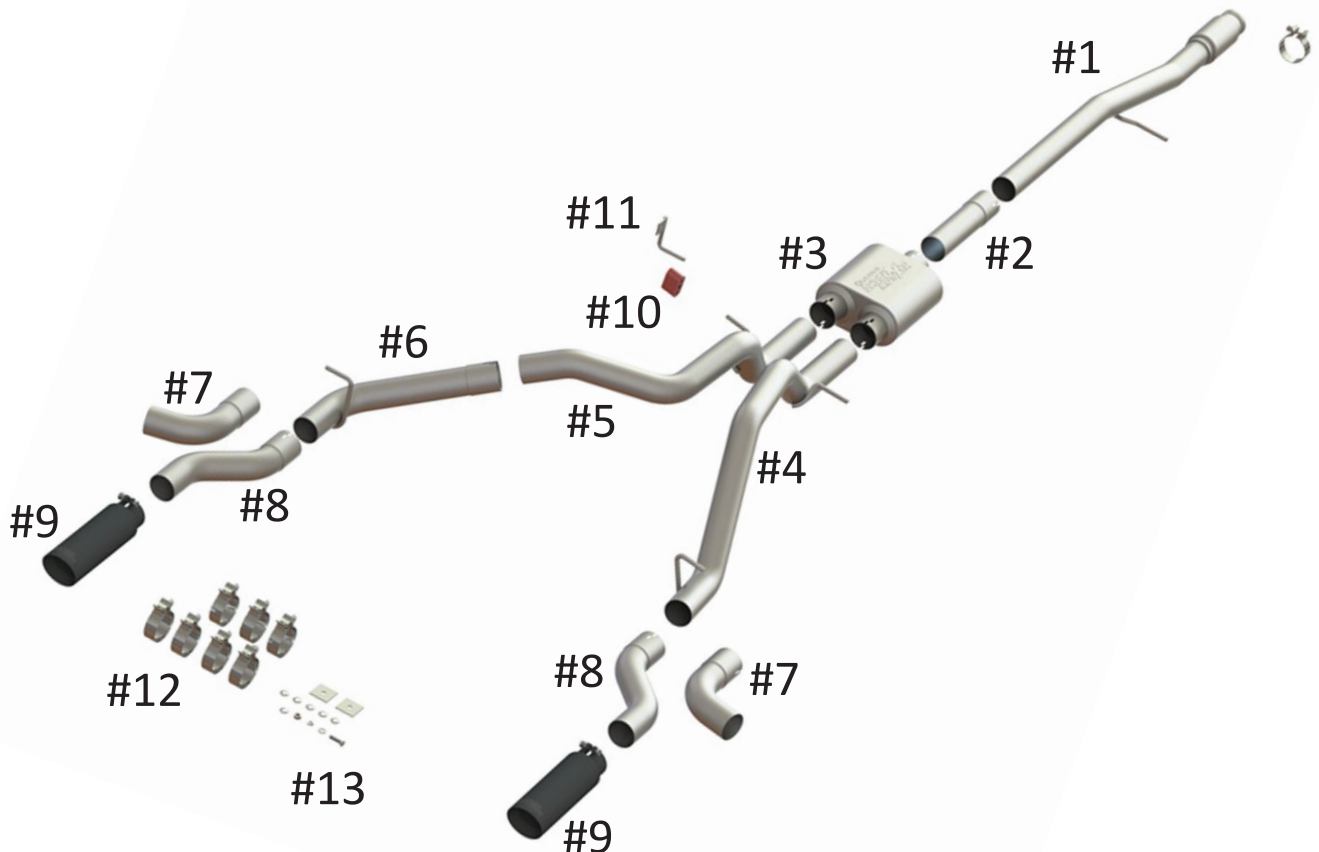

Keystone Automotive Operations (KAO) warrants this product to be free of defects in material and workmanship at the time of purchase by the original retail consumer. KAO disclaims any other warranties, express or implied, including the warranty of fitness for a particular purpose or an intended use. If the product is found to be defective, KAO may replace or repair the product at our option, when the product is returned prepaid, with proof of purchase. Alteration to, improper installation, or misuse of this product voids the warranty. KAO's liability is limited to repair or replacement of products found to be defective, and specifically excludes liability for any incidental or consequential loss or damage.