



Installation Instructions

For Part Number:

883-314 Intake Kit

**2011-15 Can Am Commander
1000cc**

Component Identification

1.	Airaid Premium Filter	1
2.	Air Box Base	1
3.	Left Panel	1
4.	Right Panel	1
5.	Foam Pre-Filter Tray	1
6.	Hood Scoop	1
7.	Foam Pre-Filter	1
8.	Silicone Coupler	1
9.	Rubber Edge Trim 33"	1
10.	5/8" Grommet	1
11.	5/8" Elbow	1
12.	1/4-20 x 1/2" Button Head Screw	8
13.	1/4" Flat Washer	10
14.	1/4-20 Serrated Flange Nut	2
15.	#12 x 3/4" Self Drilling Screw	2
16.	#8-32 Thread Cutting Screw	16
17.	#44 Hose Clamp	1
18.	#48 Hose Clamp	1
19.	Not Pictured 2" Cap	1
20.	Not Pictured #28 Hose Clamp	1
21.	Bubble Sticker	1

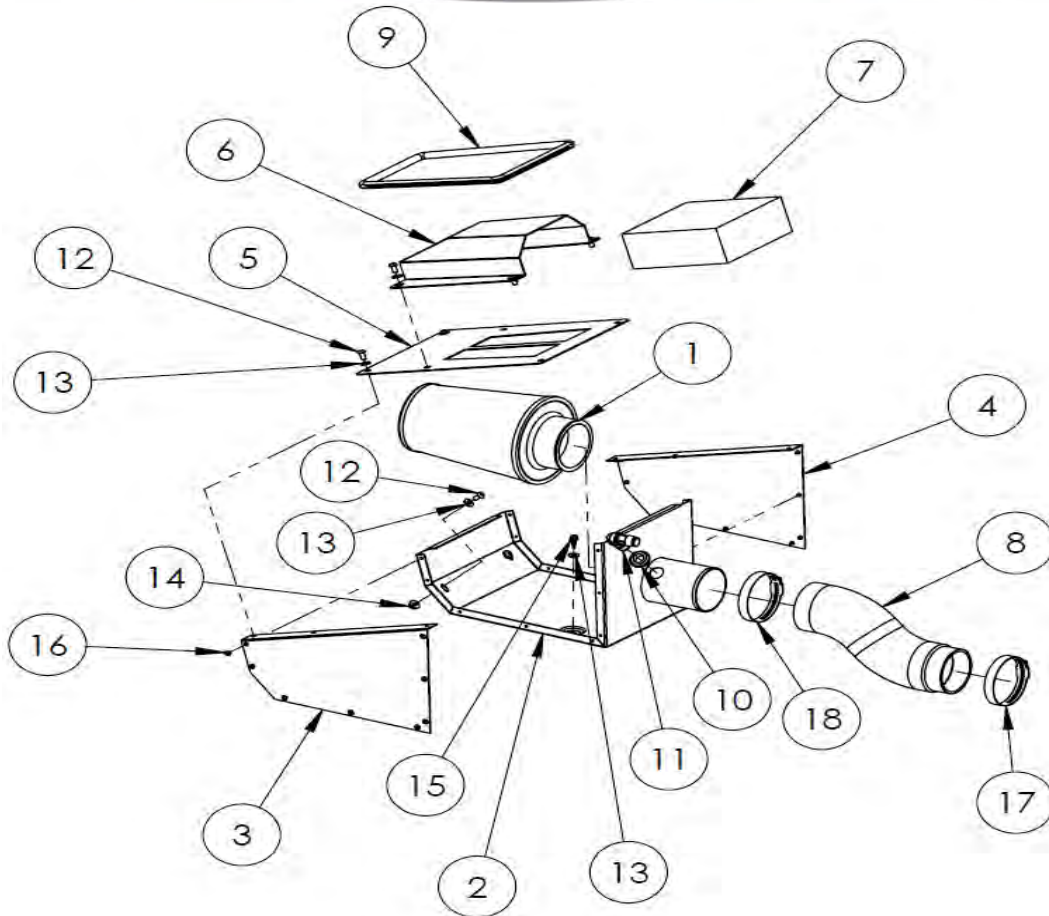

Full color instructions can be viewed on our web site at Airaid.com. Use the **Product Search** function to find your part number, and click **View Details**.



Disconnect The Negative Battery Terminal!

1. Remove the two T-25 Torx screws from the top of the center console and the two plastic rivets in the bottom.



2. Pull the console back to gain access to the factory air intake. Loosen the throttlebody clamp.



3. Loosen the firewall side clamp of the air inlet tube located in the passenger side front wheel well.

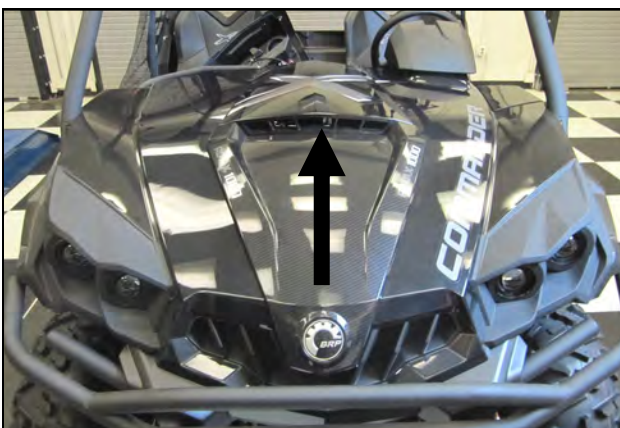

4. Remove the center section of the hood to gain access to the airbox assembly.

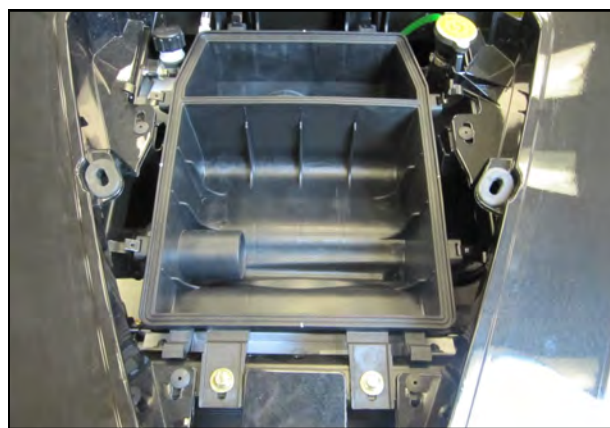

5. Remove the upper half of the airbox and the air filter.

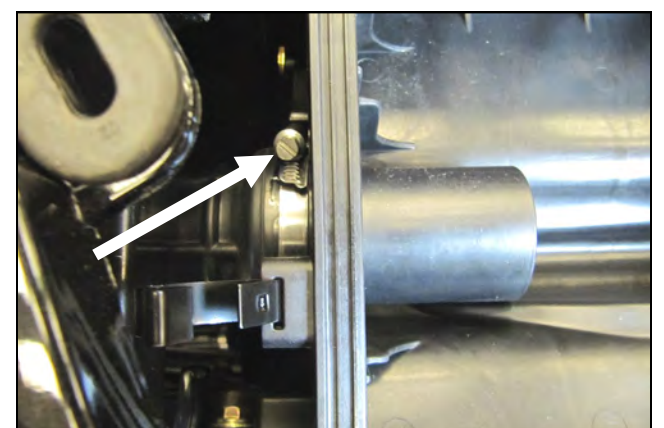

6. Loosen the airbox side clamp the air inlet tube and disconnect it. This tube will not be reused.



7. Using a 10mm box end wrench and socket, remove the two front airbox nuts and bolts in the core support.

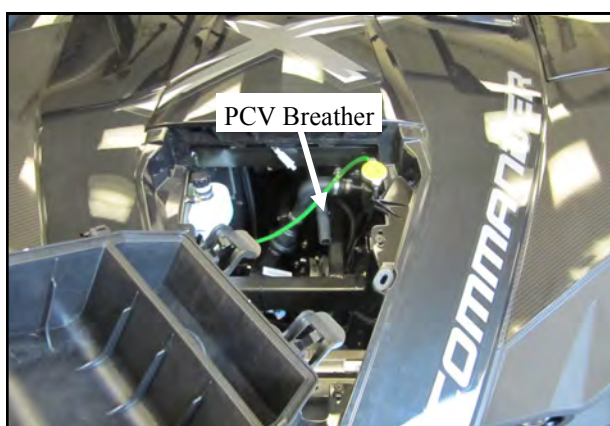

8. Disconnect the PCV Breather from the airbox lower half and remove it from the vehicle.

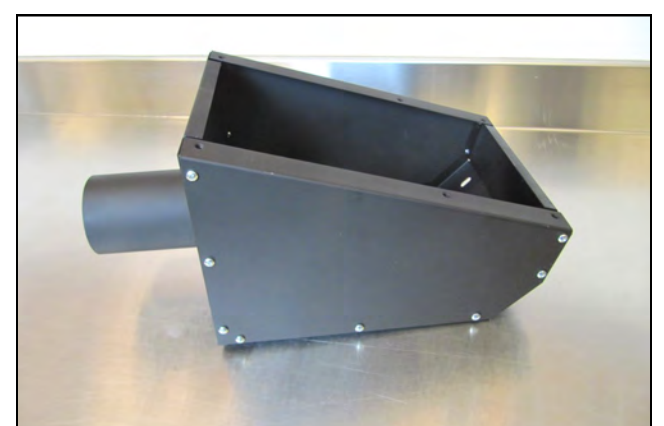

9. Install the Left and Right Panels (#3 and 4) onto the Air Box Base (#2) using the #8-32 Thread Cutting Screws (#16)



10. Install the Grommet (#10) and Elbow Fitting (#11) into the Airbox Tube.

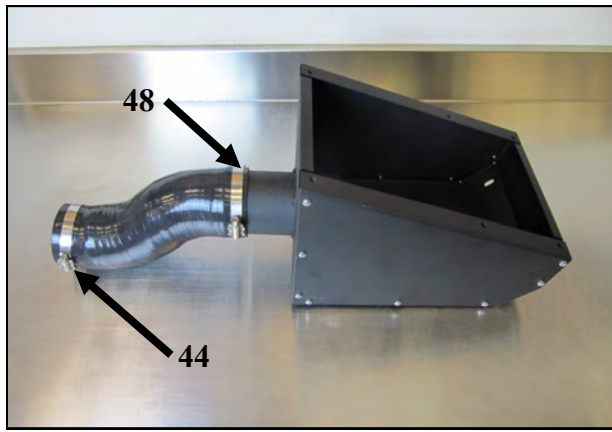

11. Slide the Silicone Coupler (#8) onto the Airbox tube as shown. Pre install the # 44 and 48 Clamps onto the Coupler with out tightening them.

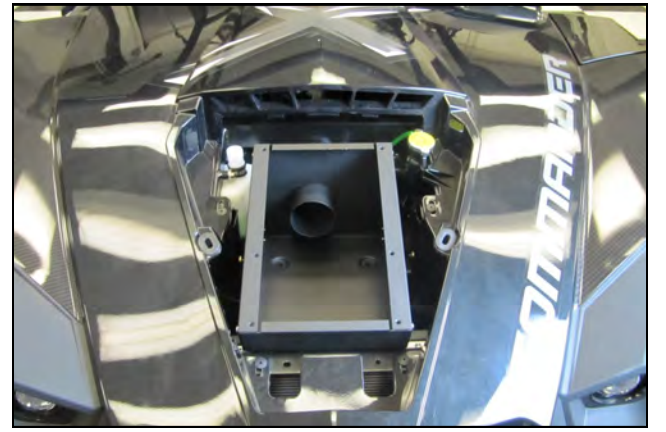

12. Position the Airaid Intake assembly into the vehicle and the coupler onto the throttlebody.

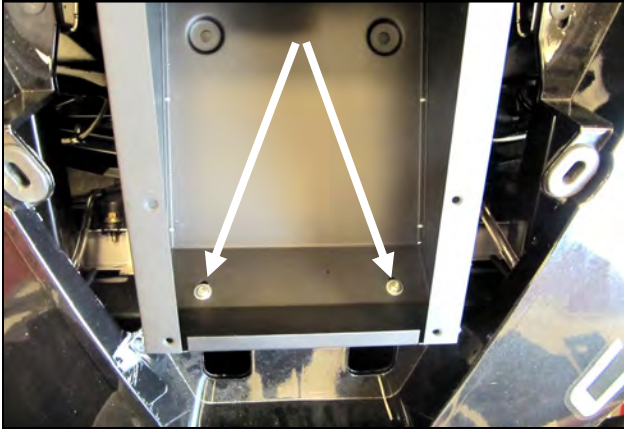

13. Secure the Intake assembly to the core support using the two 1/4-20 Button Head Screws (#12), 1/4" Flat Washers(#13), and 1/4-20 Flange Nuts (#14).

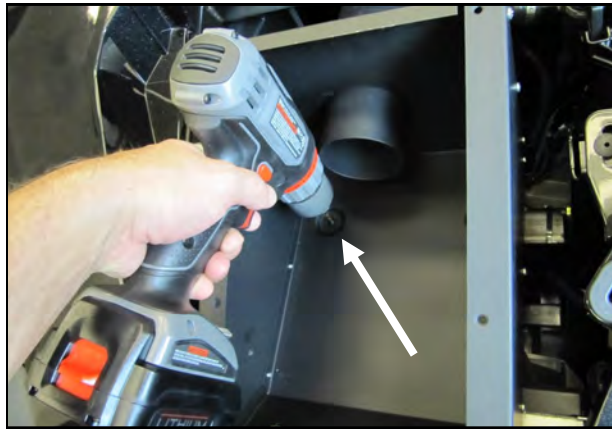

14. Drill two 1/8 inch pilot holes into the vehicle cross member underneath of the Airbox assembly's rear holes.



15. Using the drill and a 8mm socket, drive the Self Drilling Screws (#15) with a 1/4" Flat Washer into the cross member.

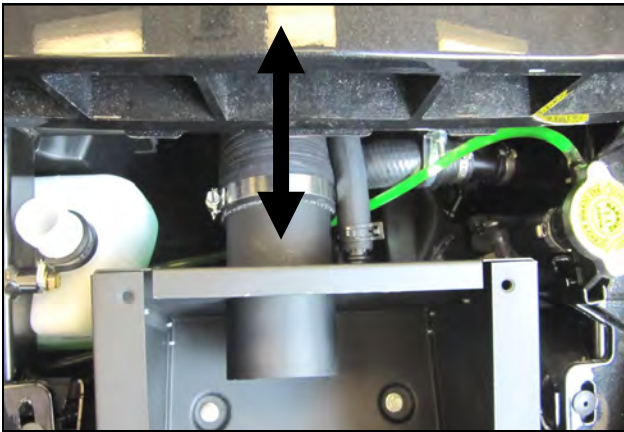

16. Slide the Coupler rearward to fully seat it onto the throttlebody and tighten both of the Clamps. Re route the PCV hose to run on top of the coolant hose and attach it to the Elbow Fitting .



17. Close up view of rerouted PCV hose. Note that the factory spring clamp is reused.

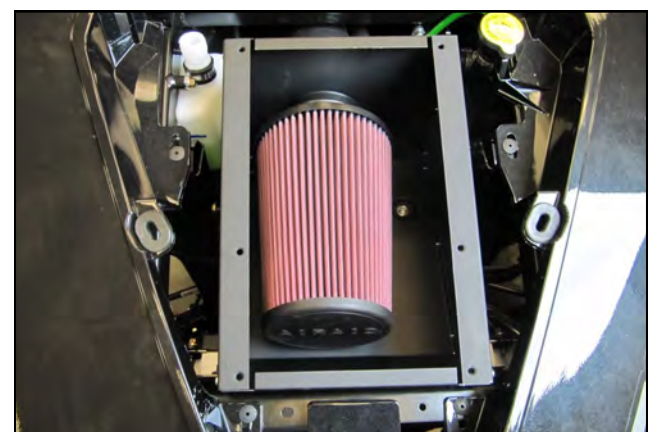

18. Slide the Airaid Premium Filter onto the inner Airbox tubing and tighten the Clamp.

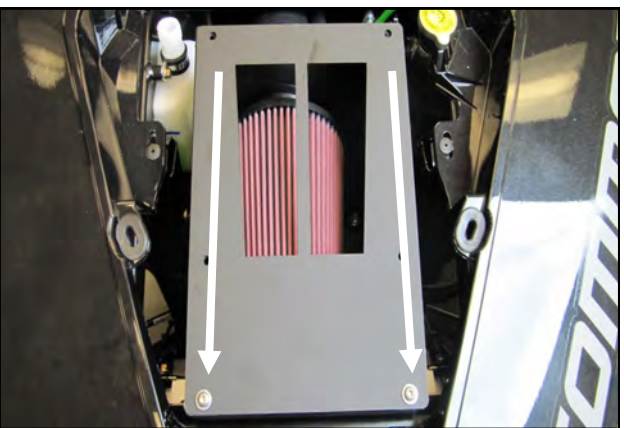

19. Install the Pre Filter Tray (#5) onto the Airbox using two 1/4-20 Button Heads and Flat Washers as shown.



20. Mount the Hood Scoop onto the Airbox assembly a shown using four sets of 1/4-20 Button Heads and Washers. Leave the Screws Finger Tight for now.



21. Prepare the hood for cutting by laying tape strips side by side all across the center section for scratch protection. Cut out the template and tape it into position.



22. Using a 1/8" bit, drill out four pilot holes in the hood followed by a 1/2" bit to finish.



23. Using a jigsaw or equivalent, cut along the template line and connect the 1/2" holes. Remove the hood center and the template.

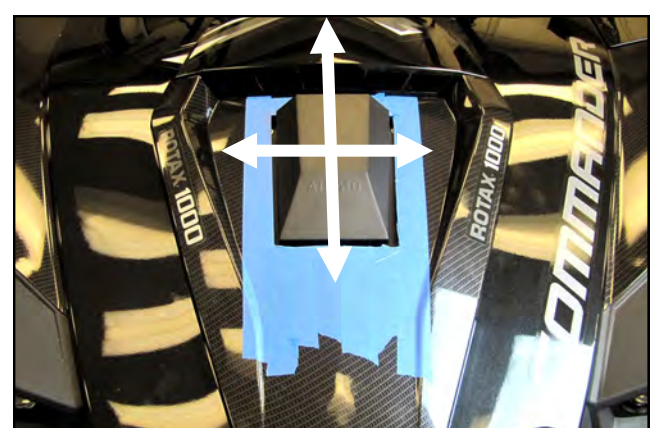

24. Install the hood and check the positioning of the Scoop. Reposition if necessary.



25. Remove the hood and make the Hood Scoop Fasteners Final Tight.

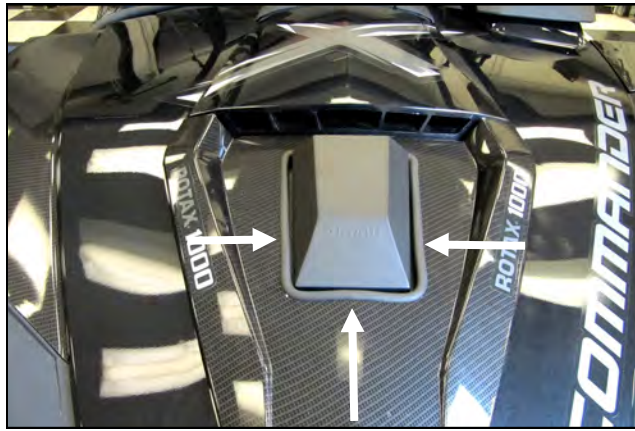

26. Finish the hood modification by installing the Rubber Edge Trim (#9) onto the cut edge.



27. Compress and install the Foam Pre Filter (#7) into the Hood Scoop.

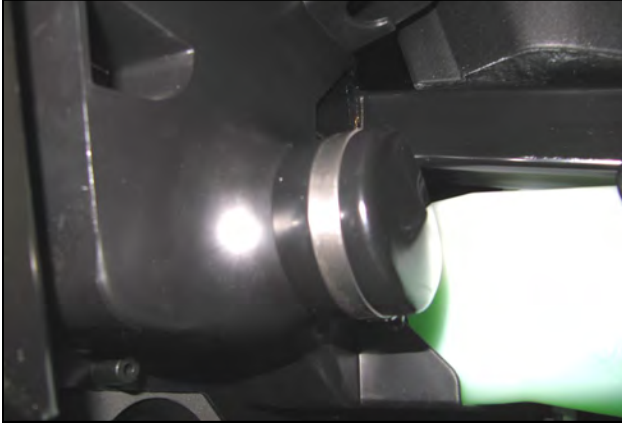

28. Install the 2" cap and # 28 Hose Clamp onto the fire wall in the passenger side inner fender (See step 3.).



29. Reinstall the center console using the factory hardware and reconnect the battery.



30. **Double check your work!** Make sure there is no foreign material in the intake path. Make sure all clamps, hoses, bolts, and screws are tight. Double check the hood clearance.

Thank you for purchasing the Airaid Intake System. Contact Airaid @ (800) 498-6951 8:00 AM - 5:00 PM MST weekdays for questions regarding fit or instructions that are not clear to you. Your Airaid Intake System was carefully inspected and packaged. Check that no parts are missing, or were damaged during shipping. If any parts are missing, contact Airaid. The air filter element is protected from direct exposure to water and debris; care should be taken not to drive through deep water. WATER INGESTION IS THE DRIVERS RESPONSIBILITY! The air filter is reusable and should be cleaned periodically.

For your Oiled media filter we suggest using the AIRAID Filter Tune-Up Kit!



P/N 790-551 Aerosol Spray
P/N 790-550 Squeeze Spray



**THIS PAGE HAS
BEEN
INTENTIONALLY
LEFT BLANK.**

ALIGN WITH EDGE OF HOOD

MARK HOLE CENTERS WITH CENTERPUNCH
AND DRILL WITH 1/2" BIT

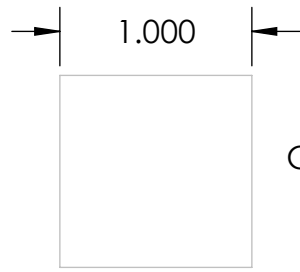

CHECK SIZE OF SQUARE TO CONFIRM
SCALE BEFORE CUTTING