



Installation Instructions

For Part Numbers:

302-372 702-466 SynthaMax Dry Media Filter - Black

2014-18 RAM 2500 /3500

V8-6.4L

NOT LEGAL FOR SALE OR USE ON ANY POLLUTION CONTROLLED MOTOR VEHICLE IN CALIFORNIA OR STATES ADOPTING CALIFORNIA EMISSION PROCEDURES.

See Airaid.com for CARB status on each part for a specific vehicle

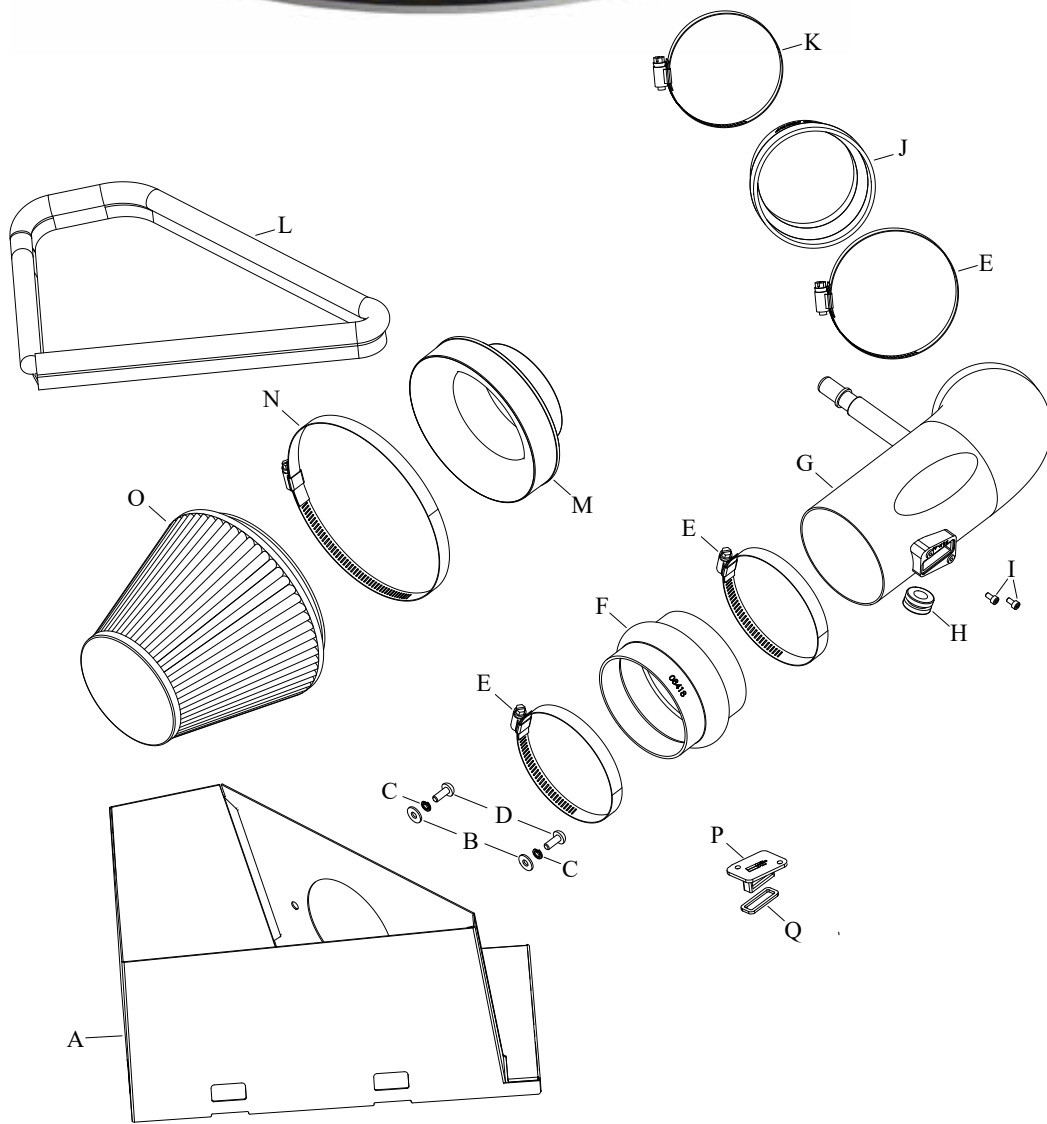

Component Identification

Description	Qty.	Part #
A HEAT SHIELD	1	073192
B WASHER; 6MM FLAT, SS	2	08269
C WASHER, M6 SPLIT LOCK ZINC	2	1-3025
D BOLT; M6 X 1.00 X 16MM, SS	2	07730
E HOSE CLAMP #64 STAINLESS	3	08645
F HOSE; 4" ID X 3" L HUMP	1	08418
G INTAKE TUBE	1	KIT27567TK
H GROMMET; 1"OD,1/2"ID,1/2"	1	08064
I BOLT; M4 - 0.07 8MM, A/H CAP	2	07733
J HOSE; 4"ID TO 3.5"ID X 3"L	1	08497
K HOSE CLAMP #56	1	08620
L EDGE TRIM (39")	1	102496
M ADAPTOR; 57-3058 #454	1	27300
N HOSE CLAMP #104	1	08697
O AIR FILTER	1	702-466
P BLOCK OFF	1	KIT348BP
Q GASKET	1	09076

Full color instructions can be viewed on our web site at Airaid.com. If you need any assistance please call 1-800-498-6951 to speak with a representative in our Customer Service Center before returning the product.

TO START:

1. Turn off the ignition and disconnect the negative battery cable.

NOTE: Disconnecting the negative battery cable erases pre-programmed electronic memories. Write down all memory settings before disconnecting the negative battery cable. Some radios will require an anti-theft code to be entered after the battery is reconnected. The anti-theft code is typically supplied with your owner's manual. In the event your vehicles anti-theft code cannot be recovered, contact an authorized dealership to obtain your vehicles anti-theft code.



2. Lift up and remove the decorative engine cover.



3. Disconnect the inlet air temperature sensor and humidity sensor electrical connections.



4. Depress the locking tab and then disconnect the crank case vent hose from the factory intake tube.



5. Loosen the hose clamp securing the factory intake tube to the throttle body.



6. Release the four locking tabs securing the air filter housing lid and then remove the housing lid and factory intake tube from the vehicle. Remove the factory air filter.

NOTE: AIRAID recommends that customers do not discard factory air intake.



7. Install the filter adapter into the heat shield as shown and secure with the provided hardware.



8. Install the provided edge trim onto the heat shield as shown.

NOTE: Some trimming of the edge trim will be necessary.

Continued...



9. Install the AIRAID® air filter onto the filter adapter and secure with the provided hose clamp.



10. Install the heat shield/filter assembly onto the lower air filter housing and secure with the four factory lid retaining clips.



11. Remove the two screws securing the mass air sensor then remove the sensor from the air filter housing. Remove the inlet air temperature sensor from the stock intake tube.



12. Install the provided grommet into the intake tube as shown.



13. Remove the O-ring from the inlet air temperature sensor and then install the sensor into the grommet installed into the intake tube during the previous step.



14. Install the humidity sensor into the intake tube and secure with the provided hardware.



15. Install the provided coupler hump hose (08418) onto filter adapter and secure with the provided hose clamp.



16. Install the provided step coupler (08497) onto the throttle body and secure with the provided hose clamps.



17. Install the intake tube into the hump coupler and then into the step coupler, then adjust the tube for best fit and secure with the provided hose clamps.



18. Connect the factory crankcase vent hose to the quick disconnect fitting on the AIRAID® intake tube.



19. Reconnect the humidity sensor and inlet air temperature sensor electrical connections.



20. Reinstall the decorative engine cover.



21. Double check your work!

Make sure there is no foreign material in the intake path. Make sure all clamps, hoses, bolts, and screws are tight. Double check the hood clearance!

Reconnect the negative battery cable!

Thank you for purchasing the Airaid Intake System. Contact Airaid @ (800) 498-6951 8:00 AM - 5:00 PM MST weekdays for questions regarding fit or instructions that are not clear to you. Your Airaid Intake System was carefully inspected and packaged. Check that no parts are missing, or were damaged during shipping. If any parts are missing, contact Airaid. The air filter element is protected from direct exposure to water and debris; care should be taken not to drive through deep water.

WATER INGESTION IS THE DRIVERS RESPONSIBILITY! The air filter is reusable and should be cleaned periodically.

FILTER IDENTIFICATION 702-466 Airaid SynthaMax Dry Media - Black

For your Oiled media filter we offer the
Airaid Tune Up Kit!



P/N 790-551 Aerosol Spray
P/N 790-550 Squeeze Spray



NOT LEGAL FOR SALE OR USE ON ANY POLLUTION CONTROLLED MOTOR VEHICLE IN CALIFORNIA OR STATES ADOPTING CALIFORNIA EMISSION PROCEDURES.

See Airaid.com for CARB status on each part for a specific vehicle

SynthaMax®

Synthamax Air Filters **do not** require oil. Service air filter as needed by cleaning with common non-petroleum all-purpose household cleaner and water. Simple Green®, Formula 409® or equivalent works great. Apply cleaner to outside of air filter and allow to soak. Then flush filter clean from the inside out with a garden hose and repeat steps if necessary. Do not apply high pressure water or air to clean filter. Allow filter to air dry and reinstall.