

# DIRECTION 714

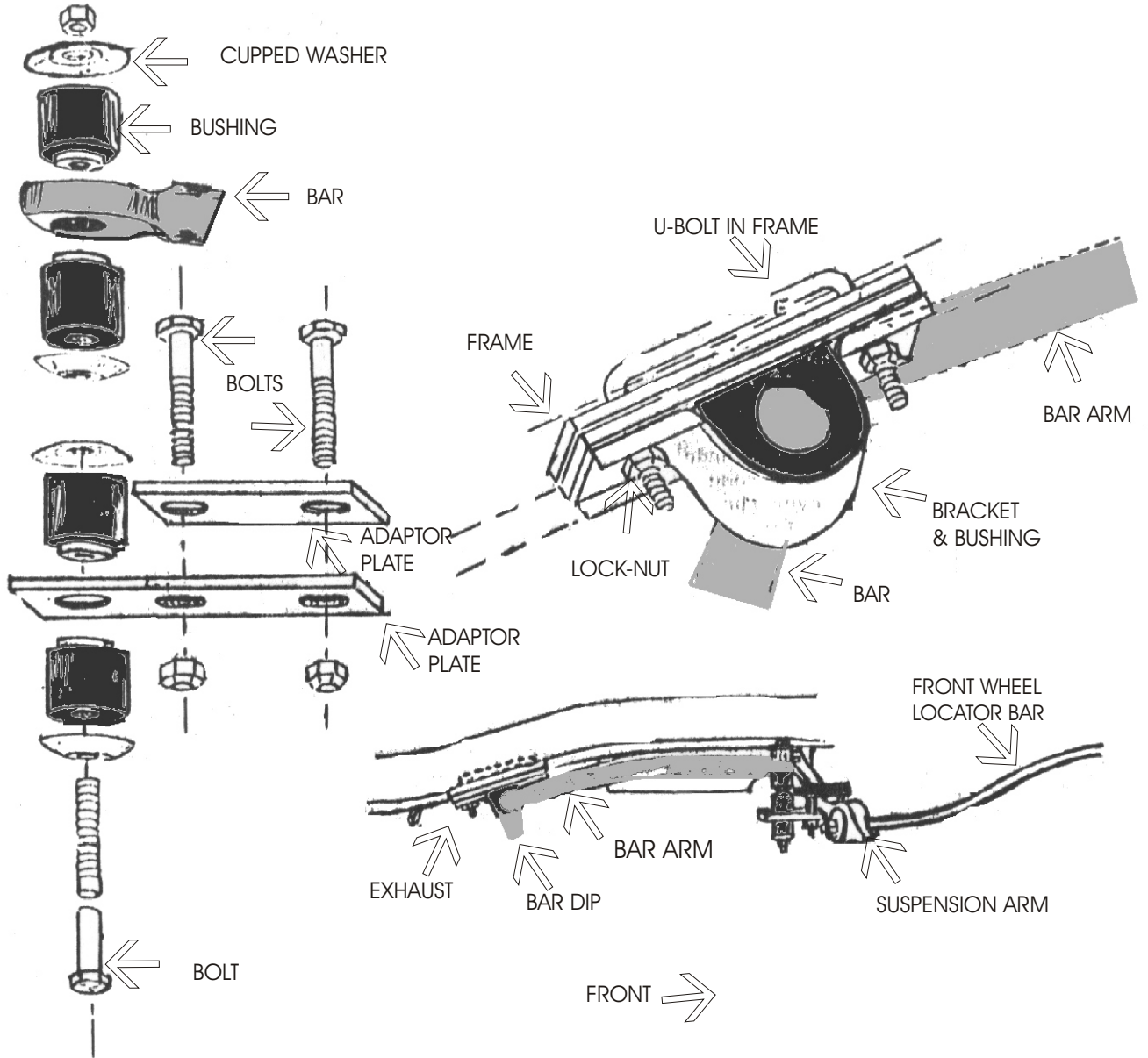

## U-BOLT DETAIL



**DIRECTIONS 714      FIAT BRAVA**

- STEP #1.**      Place suspension arm clamps on front suspension arms with the large hole to the rear. Loosely secure with bolts. Move clamp as far out as possible to where arm widens at the strut connection. Tighten lock nuts.
- STEP #2.**      Position bar under car so mid-section is to rear of the front wheels, and the arms come forward over the steering rods and the eyes center directly over the large hole in the adapter plates. Tie mid-section of bar up with string to facilitate work.
- STEP #3.**      Assemble end-links as detailed.
- STEP #4.**      Place the D-shaped rubber bushings on the bar near shoulders, flat side facing bottom. Raise bar midsection so bushings rest against frame, cover with frame bracket and mark through the holes. Drill frame bottom with a 3/8" drill bit.
- STEP #5.**      Secure frame bracket, spacer plates, bar and bushing to the frame bottom as detailed on reverse side. Be sure to keep a nut on the U-bolt all the time when inserting it into the frame so it cannot get lost within. Tighten lock nuts to 10ft/lbs.
- STEP #6.**      Check all fastenings for suitable tightness. Have someone bounce the front of the car so you can check clearance between the unit and other parts; steering rod, exhaust, etc. Throughout the suspension travel distance, and from steering lock to lock.
- STEP #7.**      Road test the vehicle to familiarize yourself to its new handling. As we cannot supervise your installation or driving, we cannot be responsible for more than the cost of the kit. Important note: as this unit does not replace the existing strut rod, it is not necessary to have the front end realigned; furthermore, this unit reduces the stress on the critical strut/suspension arm connection instead of increasing the stress at this point.

**HARDWARE**

2	RH 013 End-Links	2	RH 059 Clamps
2	RH 058 Clamps	4	RH 226 Bolts
8	RH 304 Lock-Nuts	2	RH 040 Brackets
2	RH 507 Bushings	2	RH 402 U-Bolts
4	RH 031 Plates	8	RH 104 Washers