

DIRECTION 315

BAR MOUNT DETAIL

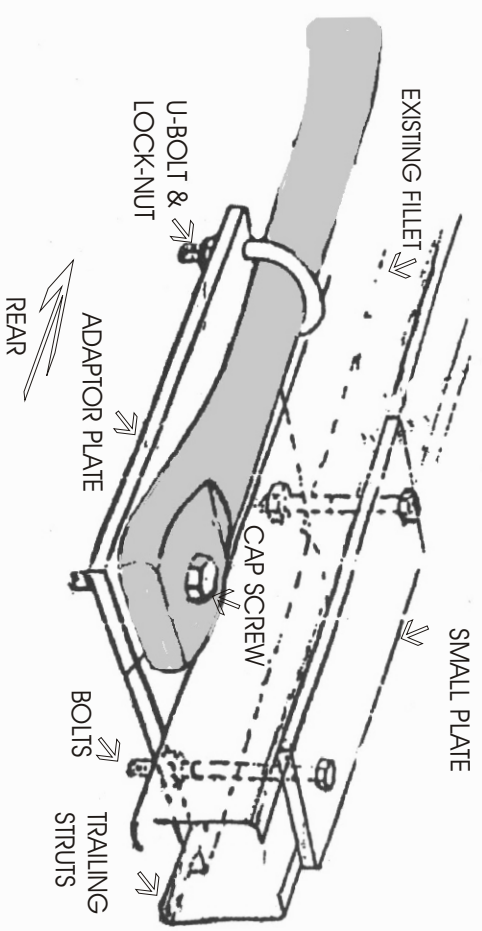

TOP MOUNT PLATE RT.

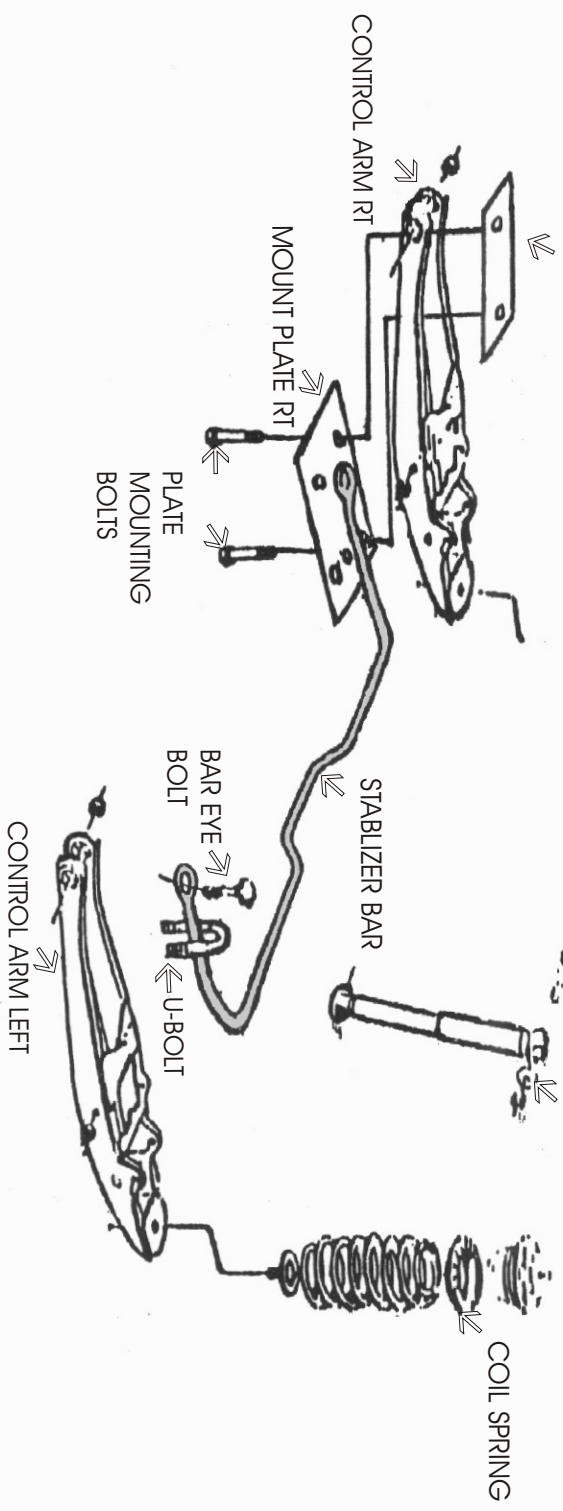

DIRECTIONS 315

- Step #1. Attach the sway bar to the re-enforcing plates using the short bolts and U-bolts. The U-bolts may need to be bent slightly to fit the plates. This should be checked first for ease of assembly.
- Step #2. With plates attached to the bar it should be held up under the car in position. As the trailing struts of the Volvo are on parallel axle, the bar may be installed where desired along the strut (it will make no difference to its performance). Consideration should be given to it being far enough to the rear to clear the tailpipe where it raises up to pass over the axle. The rear bolt should pass through the existing fillet for drilling.
- Step #4. Drill the fillet with a 3/8" bit. Place the smaller plate on top of the strut and bolt the two together with the rear bolt passing through the fillet.
- Step #5. Have someone bounce the rear of the car so you can check movement of all parts, to be sure that no part of the kit can contact exhaust, shock, differential, etc. If all is clear through out maximum travel of the suspension, tighten all nuts.
- Step #6. Road test the car and familiarize yourself with your car's new handling characteristic. As we cannot supervise your installation or your driving, we cannot be held responsible for more than the cost of the kit. NOTE: For best results this kit should be used in conjunction with our front kit.

HARDWARE:

2	RH 213 Bolts
2	RH 039 Plates
2	RH 601 Plates
4	RH 102 Washers
4	RH 205 Bolts
10	RH 304 Lock-Nuts
2	RH 400 U-Bolts