

Installation Instructions for 607235 Ford Coyote Power Steering Pumps For Vehicles without A/C

Installation Instructions:

1. Assemble Power Steering pump to plate with (2) 70mm long bolts, and (1) 20mm long bolt as pictured.



70mm Bolts



20mm Bolts

2. Remove serpentine belt from the crank and water pump pulley.

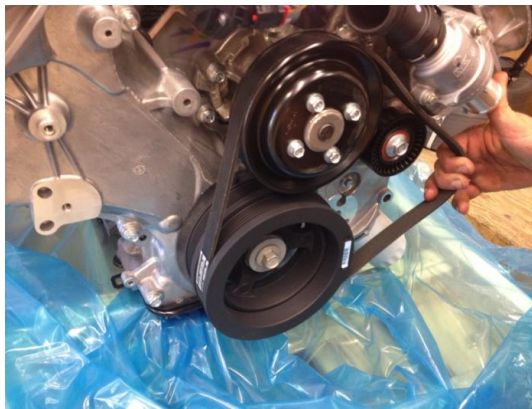

3. Drill out hole shown in picture with 7mm drill bit. Tap hole with 8mm-1.25 tap.

Note: Aluminator SC engines will have a step in place of flat surface for NA engine blocks.



4. Remove front cover bolt shown in picture.

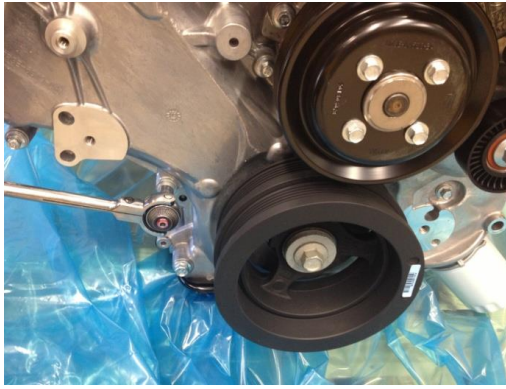

5. Place K060325 belt over crank pulley.

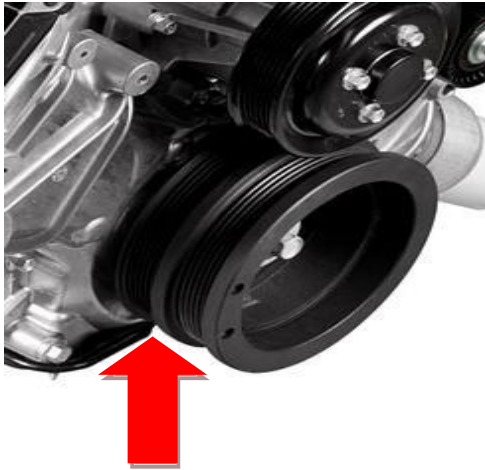

6. For Aluminator NA Engines, take the 44.25mm spacer and 70mm long bolt and place through top right hole in the pump mounting plate.

Note: For Aluminator SC Engines, use 66.5mm slotted spacer and 90mm long bolt.



7. Place belt on PS pump pulley and loosely install 70 or 90mm long bolt into the hole that was just tapped.



8. Install the 28mm spacer using 60mm long bolt into the top left hole of the pump plate, as shown in picture.



9. Install the 70mm spacer into the bottom of the pump plate using 120mm long bolt and into the front cover bolt hole that was removed earlier. Tighten all 3 bolts.

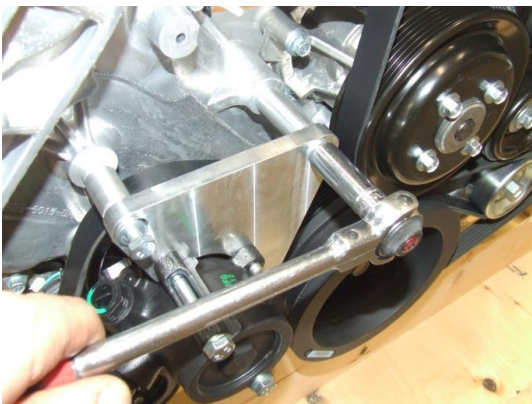

10. Completed installation.



ITEM	PART NUMBER	QTY.
1	Power Steering Pulley	1
2	Mounting plate	1
3	Power Steering Pump	1
4	28mm sleeve	1
5	44.25mm sleeve	1
6	70mm sleeve	1
7	M8 bolt 70mm long	3
8	M8 bolt 120mm long	1
9	M8 bolt 50mm long	1
10	M8 bolt 20mm long	1
11	8 mm washer	8

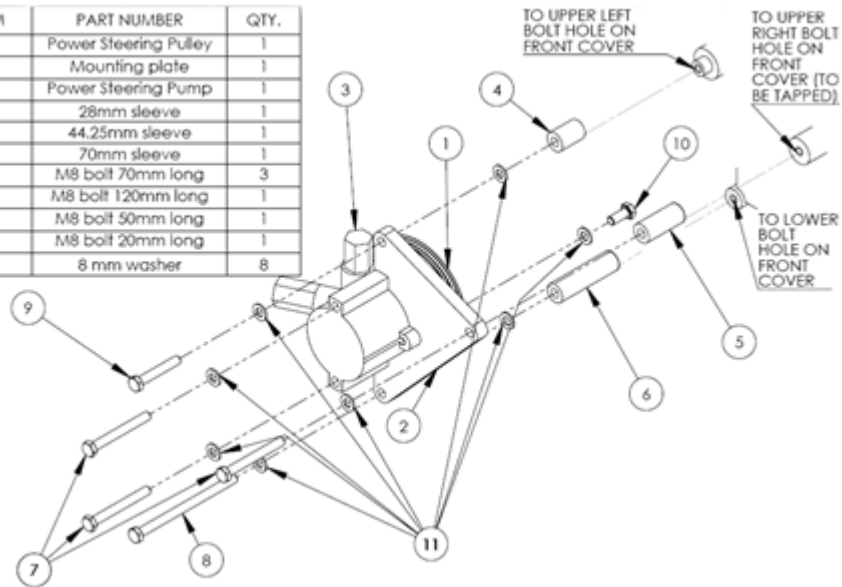

Packing List:

- (1) Machined aluminum mounting plate
- (1) PS pump assembly, with pulley and fitting attached
- (1) 28mm sleeve
- (1) 44.25mm sleeve (For Aluminator NA Engines)
- (1) 70mm sleeve
- (1) 66.5mm slotted sleeve (For Aluminator SC Engines)
- (2) 1.55mm spacer
- (1) 20mm bolt
- (1) 60mm bolt
- (3) 70mm bolts
- (1) 90mm bolts
- (1) 120mm bolt
- (6) 8mm washers
- (1) 7mm drill
- (1) 8mm x 1.25 tap
- (1) 5060325 serpentine belt