

Installation Instructions for 15070, 15071, 15075, 15076 Billet Adjustable Fuel Line

Available in: -06AN or -08AN for Holley and BG/Demon Carburetors.

BE CAREFUL – DO NOT OVERTIGHTEN THE THREADED FITTINGS!

WARNING!

Check for leaks before starting your vehicle. Take precautions when working with gasoline – It is a fire hazard and is potentially explosive.

Replacement Filter Element with O-Ring (JEG'S part #555-15045) Instructions:

1. Place the filter element down into the body of the billet fuel filter, making sure the filter seats flat.
2. Slide rubber o-ring into the o-ring groove.
3. Using assembly lube or equivalent product applied to the o-ring, screw the fuel filter together and snug tight with a -08AN wrench (JEG'S part #555-80552).

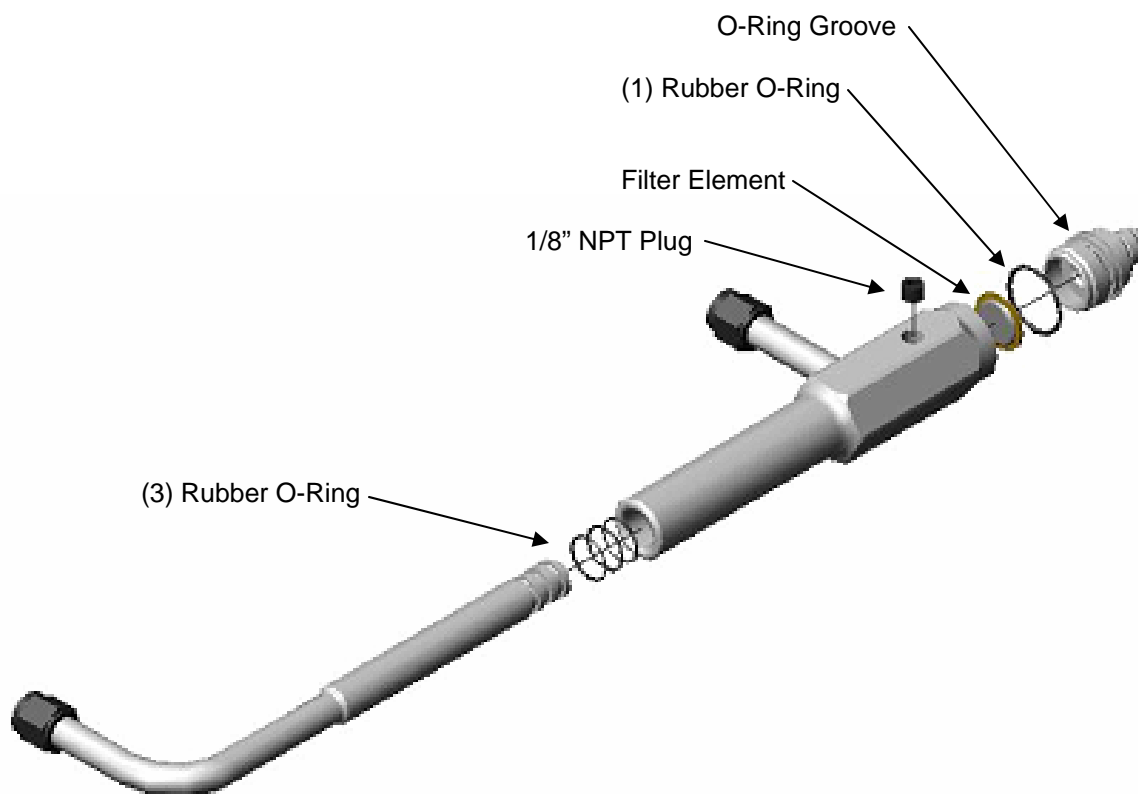

1-800-345-4545 jeps.com