

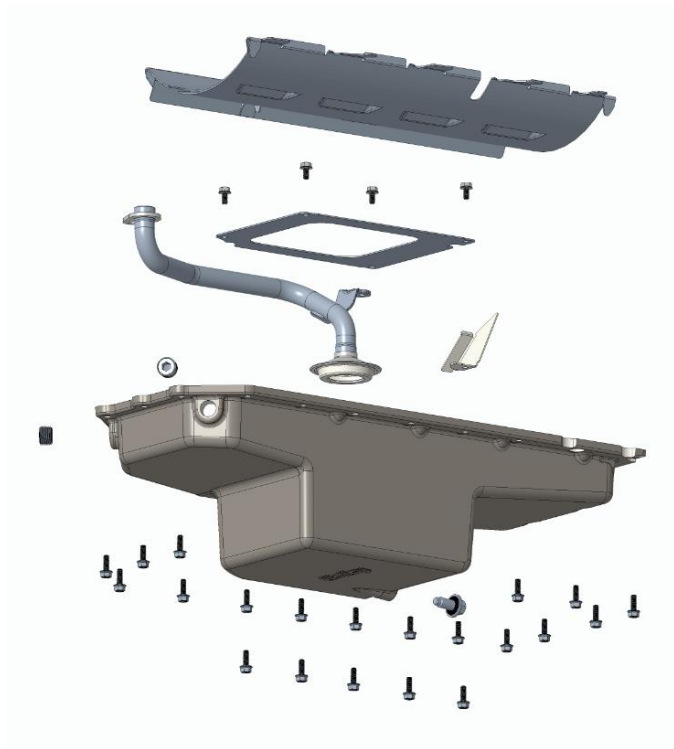

**HOLLEY® Gen. 3 Hemi,  
Cast Mid-Sump Oil Pan  
510-302-61**



**Parts Breakdown:**

- ❑ 1 – Cast Aluminum Oil Pan, W/O-rings installed
- ❑ 1 – Windage Tray (works with all strokes up to 4.060")
- ❑ 1 – Dipstick Deflector (use only with Chrysler original equipment dipsticks)
- ❑ 1 – Baffle
- ❑ 1 – Pickup Tube & Pickup Tube O-ring (VVT or NON-VVT model)
- ❑ 1 – M12 x 1.75 Drain Plug w/O-ring
- ❑ 4 – M6 x 1, 12mm Length Hex Flange Head Bolt (Baffle Bolts)
- ❑ 21 – M6 x 1, 20mm Length Hex Flange Bolt (Oil Pan to Engine Bolts)
- ❑ 1 – M8 x 1.25, 24mm length Socket Head Cap Screw, (Pickup Tube To Oil Pump)
- ❑ 2 – Plug, 1/2-14 NPT